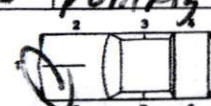
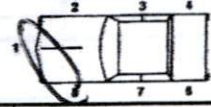
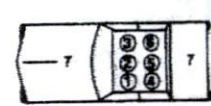
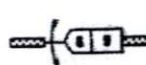

Local Traffic Crash Report

Local Report Number **2015-45000**

Report Taken <input type="checkbox"/> Headquarters <input type="checkbox"/> Substation		Total Number of Vehicles and Pedestrians Involved Pedestrians 2 Vehicles		Combined Vehicle and Property Loss (Account for the total of all vehicles and property damaged) <input checked="" type="checkbox"/> Over \$150 <input type="checkbox"/> Under \$150	
In County Of CLERMONT		• Within corporate limits of (if not, file with correct agency):		Date of Crash M 5 D 16 Y 15 Day SATURDAY Time 2307 <input checked="" type="radio"/> AM <input type="radio"/> PM	
Crash Occurred On PRIVATE ACCESS ROAD				Within The Intersection Of	
If Not In Intersection Miles 111 Feet W <input checked="" type="radio"/> S <input type="radio"/> E <input type="radio"/> N Of 1863 mailbox.		(List Nearest Intersecting Street, Milepost, House No.)			
A Unit No. 1 No. Of Occupants		Operating <input checked="" type="checkbox"/> Parked <input type="checkbox"/> Driverless <input type="checkbox"/> Non-Contact <input type="checkbox"/>		Insurance Co. Or Agent	
Driver - Pedestrian Name (Last, First, MI)			Address (No., Street, State, Zip Code)		
Phone No.		Birth Date M D Y	Age	Sex	State
Occupation		Drivers License No.	Occupation		
Owner (If Same As Driver, Write Same) MATTHEW LEAR 1863 LINDA FARMS LANE NEW RICHMOND OH 45157					
Veh. Year 2015 Make POLARIS Model PHOENIX 200 Color Blue White Style		State		License Plate No. NONE	Towing Service N/A
Veh/Ped Dir From To		Damage Severity <input type="checkbox"/> Non-Functional <input checked="" type="checkbox"/> Functional <input type="checkbox"/> Disabling		Damage Scale <input type="checkbox"/> None <input type="checkbox"/> Light <input checked="" type="checkbox"/> Moderate <input type="checkbox"/> Heavy	Vehicle Disposition <input checked="" type="checkbox"/> Driven Away <input type="checkbox"/> Remained At Scene <input type="checkbox"/> Towed
Circle Damage Areas 		9 Top 10 Undercar 11 Load 12 Trailer	Fire <input checked="" type="checkbox"/> No Fire <input type="checkbox"/> Fire Due To Crash <input type="checkbox"/> Other Fire		
B Unit No. 2 No. Of Occupants		Operating <input checked="" type="checkbox"/> Parked <input type="checkbox"/> Driverless <input type="checkbox"/> Non-Contact <input type="checkbox"/>		Insurance Co. Or Agent	
Driver - Pedestrian Name (Last, First, MI)			Address (No., Street, State, Zip Code)		
Phone No.		Birth Date M D Y	Age	Sex	State
Occupation		Drivers License No.	Occupation		
Owner (If Same As Driver, Write Same) MATTHEW LEAR 1863 LINDA FARMS LANE NEW RICHMOND OH 45157					
Veh. Year 2015 Make POLARIS Model PHOENIX 200 Color Blue White Style		State		License Plate No. NONE	Towing Service N/A
Veh/Ped Dir From To		Damage Severity <input checked="" type="checkbox"/> Non-Functional <input type="checkbox"/> Functional <input type="checkbox"/> Disabling		Damage Scale <input type="checkbox"/> None <input type="checkbox"/> Light <input checked="" type="checkbox"/> Moderate <input type="checkbox"/> Heavy	Vehicle Disposition <input type="checkbox"/> Driven Away <input checked="" type="checkbox"/> Remained At Scene <input type="checkbox"/> Towed
Circle Damage Areas 		9 Top 10 Undercar 11 Load 12 Trailer	Fire <input checked="" type="checkbox"/> No Fire <input type="checkbox"/> Fire Due To Crash <input type="checkbox"/> Other Fire		
C From Unit No.		Name (Last, First, MI)		Birth Date M D Y	Age
Address		Phone		Sex	Position A B C D E F
D From Unit No.		Name (Last, First, MI)		Birth Date M D Y	Age
Address		Phone		Sex	
E From Unit No.		Name (Last, First, MI)		Birth Date M D Y	Age
Address		Phone		Sex	
F From Unit No.		Name (Last, First, MI)		Birth Date M D Y	Age
Address		Phone		Sex	P-PEDESTRIAN
G From Unit No.		Name (Last, First, MI)		Birth Date M D Y	Age
Address		Phone		Sex	Restraints A2 B2 C D E F
H From Unit No.		Name (Last, First, MI)		Birth Date M D Y	Age
Address		Phone		Sex	Ejection A B C D E F
I From Unit No.		Name (Last, First, MI)		Birth Date M D Y	Age
Address		Phone		Sex	1 Not Ejected 2 Partial 3 Total 4 Trapped inside Vehicle
Date Report Filed M 5 D 16 Y 15		Desk Officer's Name & Badge # DEPUTY DOWERS #11008			

Driver - Pedestrian - Vehicle Section

Occupant Section

Local Report Number
2015-45000

Describe What Happened
 Refer To Units
 By Number

**PENDING INVESTIGATION - UNIT 1 WAS FACING FORWARD INSIDE THE
 QUARTER OF 1863 LAUREL FARMS LANE. THE ENGINE TO UNIT 1 WAS WARM.
 UNIT 2 WAS FACING THE WOODS LINE 111 FT. SOUTH EAST OF MAILBOX
 AT 1863 LAUREL FARMS LANE. THE ENGINE TO UNIT 2 WAS WARM.**

Weather Conditions 1 No Adverse Weather 2 Rain 3 Snow 4 Fog 5 High Wind 6 Other	Road Conditions 1 Dry 2 Wet 3 Snow 4 Ice 5 Dirt/Sand 6 Other	Light 1 Daylight 2 Dawn 3 Dusk 4 Dark No Lights 5 Dark Lighted 6 Other	Road Contour 1 Straight Level 2 Straight Grade 3 Curve Level 4 Curve Grade	Occurrences 1 On Roadway 2 Off Left Side 3 Off Right Side 4 On Opposing Lane of Divided Highway	Special Area 1 Road Construction/Maintenance Area 2 School Zone
First Harmful Event					
Two MV In Transport 1 Head On 2 Rear-End 3 Backing 4 Sideswipe Meeting 5 Sideswipe Passing 6 Angle					
One MV In Transport (Collision) 7 Parked 8 Pedestrian 9 Animal 10 Train 11 Pedal Cycle 12 Other Non-MV 13 Fixed Object 14 Other Object					
Non-Collision 15 Fall From or In MV 16 Overturning 17 Other Non-Collision					
Location 1 Intersection 2 Intersection-Related 3 Driveway Access 4 Railroad Crossing 5 Bridge-Passing Over 6 Bridge-Passing Under 7 Non-Intersection 8 Private Property					

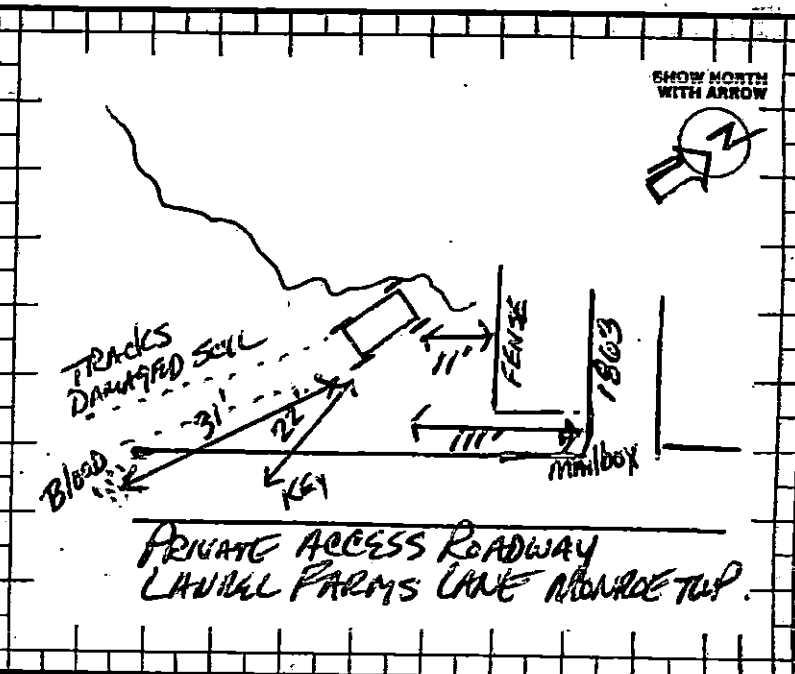

Type of Unit # <u>1</u> <u>12</u> <u>2</u> <u>12</u>	Pre-Crash Actions A B	Contributing Factor A B
Car 1 Sub Compact 2 Compact 3 Mid Size 4 Full Size	Driver Actions 1 Going Straight 2 Turning Right 3 Turning Left 4 Turning on Red Light 5 U Turn 6 Stopped To Turn 7 Stopped in Traffic 8 Parking/Unparking 9 Parked 10 Backing 11 Passing 12 Changing Lanes 13 Merging/Exiting Ramp 14 Out of Control 15 Swerving 16 Driverless Vehicle 17 Other Driver Action	Driver Error 1 None 2 Failure to Yield 3 Unsafe Speed 4 Following Too Closely or ACDA 5 Ran Red Light 6 Ran Stop or Yield Sign 7 Improper Turn 8 Improper Passing 9 Improper Lane Change 10 Improper Backing 11 Improper Start from Parked Position 12 Stopped or Parked Illegally 13 Left of Center 14 Failure to Control 15 Driver Inattention 16 Drove Off Road Reason Unknown 17 Other Driver Error
Bus 16 School Bus 17 Church 18 Public	Pedestrian Actions 18 Crossing in X-Walk 19 Crossing Other than X-Walk 20 Walking in Road (With Traffic) 21 Walking in Road (Against Traffic) 22 Playing in Road 23 Working on Road 24 Entering or Leaving Vehicle 25 Pushing/Working on Vehicle in Road 26 Other in Road 27 On Sidewalk or Shoulder	Non-Driver Factor 18 Vehicle Defects 19 Load Shifting, Falling, Spilling 20 Pavement Defect 21 Shoulder Defect 22 Debris on Road 23 Downed Traffic Sign/Device 24 Vision Obstruction 25 Animal Actions 26 Pedestrian Actions
Truck 5 Pickup 6 Panel/Van 7 Straight Truck 8 Straight Truck & Trailer 9 Truck Tractor 10 Tractor & Semi-Trailer 11 Tractor & Double Trailer	Traffic Control A B 1 No Controls 2 Stop Sign 3 Yield Sign 4 Traffic Signal 5 Traffic Flashers 6 School Zone 7 Railroad Crossbucks 8 Railroad Flashers 9 Railroad Gates 10 Construction Barricades 11 Police Officer 12 Pavement Markings 13 Other	Vehicle Defects Code if Contributing Factor is 18 Primary A B Secondary A B 1 Turn Signals 2 Head Lamps 3 Tail Lamps 4 Brakes 5 Steering 6 Tire Blowout 7 Worn or Slick Tires 8 Trailer Equipment Defective 9 Motor Trouble 10 Disabled from Prior Accident 11 Other Defects
Motorcycle 12 MC up to 350cc 13 MC up to 750cc 14 MC over 751cc 15 Motorized Bicycle	Fixed Object Struck A B 1 None 2 Utility Pole 3 Traffic Sign 4 Bridge/Culvert 5 Guard Rail 6 Fence 7 Tree 8 Scrubbery 9 Curb 10 Ditch 11 Embankment 12 Building 13 Mail Box 14 Construction Barricade 15 Fire Hydrant 16 Other Object	Truck Load A B 1 Empty 2 Perishable Goods 3 General Freight 4 Metal/Heavy Machinery 5 Hazardous Gas 6 Hazardous Liquid 7 Hazardous Solid 8 Radioactive Material
Speed Unit Estimated Legal	Truck Axles A B Tractor Trailer Rigs	
Motorcycle Helmet Use Unit Driver Pass	Pedestrian 14 No Controls 15 Crosswalk Lines 16 Walk/Don't Walk Device	
1 No Helmet 3 Full Facial Cover		
2 Full Coverage 4 Other Type Helmet		