

# Local Traffic Crash Report

Local Report Number 18-26846

Scene

Report Taken	<input type="checkbox"/> Headquarters <input type="checkbox"/> Substation	Total Number of Vehicles and Pedestrians Involved <u>2</u>	Combined Vehicle and Property Loss (Account for the total of all vehicles and property damaged) <input type="checkbox"/> Over \$150 <input type="checkbox"/> Under \$150
--------------	--	---	---

In County Of <u>Clermont</u>	• Within corporate limits of (if not, file with correct agency)	Date of Crash M <u>07</u> D <u>04</u> Y <u>18</u>	Day <u>WED</u>	Time <u>1311</u>	AM PM
---------------------------------	---	--	-------------------	---------------------	----------

Crash Occurred On Whispering Trees Drive Within The Intersection Of

If Not In Intersection (List Nearest Intersecting Street, Milepost, House No.)  
Miles \_\_\_\_\_ Feet \_\_\_\_\_ W \_\_\_\_\_ E \_\_\_\_\_ OF \_\_\_\_\_ 3340

Unit No. <u>A 01</u>	No. Of Occupants <u>01</u>	Operating <input type="checkbox"/> Parked <input type="checkbox"/> Driverless <input type="checkbox"/> Non-Contact <input type="checkbox"/>	Insurance Co. Or Agent <u>NATIONWIDE - 92342041186</u>
----------------------	----------------------------	---	---

Driver - Pedestrian Name (Last, First, MI) WEBB, TANNER Address (No., Street, State, Zip Code) 850 MAPLE CREEK RD. MOSLOW OHIO 45153

Phone No.	Birth Date M <u>11</u> D <u>02</u> Y <u>98</u>	Age <u>19</u>	Sex <u>M</u>	State <u>OH</u>	Drivers License No. <u>GH888756</u>	Occupation
-----------	---	------------------	-----------------	--------------------	--	------------

Owner (If Same As Driver, Write Same) SAME Address \_\_\_\_\_ Phone \_\_\_\_\_

Veh. Year <u>2015</u>	Make <u>FORD</u>	Model <u>FUSION</u>	Color <u>WHITE</u>	Style <u>4D</u>	State <u>OH</u>	License Plate No. <u>HJ54740</u>	Towing Service	Veh/Fed Dir From <u>E</u> To <u>N</u>
--------------------------	---------------------	------------------------	-----------------------	--------------------	--------------------	-------------------------------------	----------------	--

Circle Damage Areas	9 Top 10 Undercar 11 Load 12 Trailer	Damage Severity <input checked="" type="checkbox"/> Non-Functional <input type="checkbox"/> Functional <input type="checkbox"/> Disabling	Damage Scale <input type="checkbox"/> None <input type="checkbox"/> Light <input checked="" type="checkbox"/> Moderate <input type="checkbox"/> Heavy	Vehicle Disposition <input checked="" type="checkbox"/> Driven Away <input type="checkbox"/> Remained At Scene <input type="checkbox"/> Towed	Fire <input checked="" type="checkbox"/> No Fire <input type="checkbox"/> Fire Due To Crash <input type="checkbox"/> Other Fire
---------------------	---	--	---	--	--

Unit No. <u>B 02</u>	No. Of Occupants <u>01</u>	Operating <input type="checkbox"/> Parked <input type="checkbox"/> Driverless <input type="checkbox"/> Non-Contact <input type="checkbox"/>	Insurance Co. Or Agent <u>USAA</u>
----------------------	----------------------------	---	---------------------------------------

Driver - Pedestrian Name (Last, First, MI) CAUDILL, SHEBY Address (No., Street, State, Zip Code) 292 FAWRD MEADOW DR. BATAVIA OH. 45103

Phone No.	Birth Date M <u>12</u> D <u>28</u> Y <u>94</u>	Age <u>23</u>	Sex <u>F</u>	State <u>OH</u>	Drivers License No. <u>TX562571</u>	Occupation
-----------	---	------------------	-----------------	--------------------	--	------------

Owner (If Same As Driver, Write Same) BLALOCK, LORI Address 3380 WHISPERING TREES DR. AMELIA OH. 45102 Phone \_\_\_\_\_

Veh. Year <u>2012</u>	Make <u>CHEVY</u>	Model <u>EQUINOX</u>	Color <u>WHITE</u>	Style <u>SW</u>	State <u>OH</u>	License Plate No. <u>HKB6631</u>	Towing Service	Veh/Fed Dir From <u>S</u> To <u>N</u>
--------------------------	----------------------	-------------------------	-----------------------	--------------------	--------------------	-------------------------------------	----------------	--

Circle Damage Areas	9 Top 10 Undercar 11 Load 12 Trailer	Damage Severity <input type="checkbox"/> Non-Functional <input checked="" type="checkbox"/> Functional <input type="checkbox"/> Disabling	Damage Scale <input type="checkbox"/> None <input type="checkbox"/> Light <input checked="" type="checkbox"/> Moderate <input type="checkbox"/> Heavy	Vehicle Disposition <input checked="" type="checkbox"/> Driven Away <input type="checkbox"/> Remained At Scene <input type="checkbox"/> Towed	Fire <input checked="" type="checkbox"/> No Fire <input type="checkbox"/> Fire Due To Crash <input type="checkbox"/> Other Fire
---------------------	---	--	---	--	--

Driver - Pedestrian - Vehicle Section

Occupant Section

From Unit No.	Name (Last, First, MI)	Birth Date M D Y	Age	Sex	Position						
					A	B	C	D	E	F	
<u>C</u>											
<u>D</u>											
<u>E</u>											
<u>F</u>											
<u>G</u>											
<u>H</u>											
<u>I</u>											

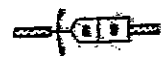
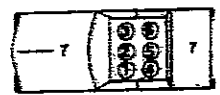

P-PEDESTRIAN

Restraints					
<u>10</u>	<u>8</u>				

- 1 Not Used
- 2 None Available
- 3 Lap Belt Used
- 4 Exp/Shoulder Belt Used
- 5 Shoulder Belt Used
- 6 Child Safety Seat
- 7 Air Bag Used
- 8 Use Not Reported

Date Report Filed M <u>07</u> D <u>04</u> Y <u>18</u>	Desk Officer's Name & Badge # <u>Dep. D. Scott</u>
--	---

Ejection					
<u>1</u>	<u>1</u>				

- 1 Not Ejected
- 2 Partial
- 3 Total
- 4 Trapped Inside Vehicle

Local Report Number  
18-26846

Describe What Happened  
Sector To Units  
By Number

THE OPERATOR OF UNIT #2 WAS NORTH ON WHISPERING TREES DRIVE  
APPROACHING 3340 WHISPERING TREES DRIVE. THE OPERATOR OF UNIT #1 WAS PARKED  
ON THE ROADWAY IN FRONT OF 3340 WHISPERING TREES DRIVE. UNIT #1 PULLED OUT  
FROM ITS PARKING SPOT INTO THE PATH OF UNIT #2, STRIKING THE RF OF UNIT #2  
RIGHT FRONT BUMPER, FENDER & DOOR DAMAGE TO UNIT #2, LF DAMAGE TO FENDER & BUMPER UNIT #1

<b>Weather Conditions</b>	1 1 No Adverse Weather 2 Rain 3 Snow	4 4 Fog 5 High Wind 6 Other
<b>Road Conditions</b>	1 1 Dry 2 Wet 3 Snow	4 4 Ice 5 Dirt/Sand 6 Other
<b>Light</b>	1 1 Daylight 2 Dawn 3 Dusk	4 4 Dark No Lights 5 Dark Lighted 6 Other
<b>Road Contour</b>	1 1 Straight Level 2 Straight Grade	3 3 Curve Level 4 Curve Grade
<b>Occurrence</b>	1 1 On Roadway 2 Off Left Side	3 3 Off Right Side 4 On Opposing Lane of Divided Highway
<b>Special Area</b>	1 1 Road Construction/Maintenance Area 2 School Zone	

<b>First Harmful Event</b> 6
<b>Two MV In Transport</b>
1 Head On 2 Rear-End 3 Backing 4 Sideswipe Meeting 5 Sideswipe Passing 6 Angle
<b>One MV In Transport (Collision)</b>
7 Parked 8 Pedestrian 9 Animal 10 Train 11 Pedal Cycle 12 Other Non-MV 13 Fixed Object 14 Other Object
<b>Non-Collision</b>
15 Fall From or in MV 16 Overturning 17 Other Non-Collision
<b>Location</b> 3
1 Intersection 2 Intersection-Related 3 Driveway Access 4 Railroad-Crossing 5 Bridge-Passing Over 6 Bridge-Passing Under 7 Non-Intersection 8 Private Property

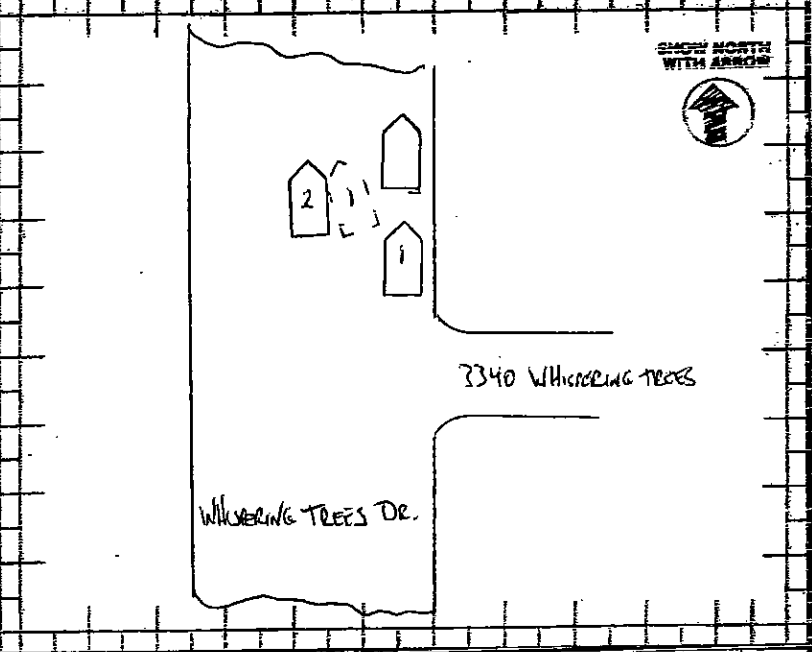

<b>Type of Unit</b>	# 1	A 4	# 2	B 4
<b>Car</b>	1 Sub Compact 2 Compact 3 Mid Size 4 Full Size			
<b>Truck</b>	5 Pickup 6 Panel/Van 7 Straight Truck 8 Straight Truck & Trailer 9 Truck Tractor 10 Tractor & Semi-Trailer 11 Tractor & Double Trailer			
<b>Motorcycle</b>	12 MC up to 350cc 13 MC up to 750cc 14 MC over 751cc 15 Motorized Bicycle			
<b>Bus</b>	16 School Bus 17 Church 18 Public			
<b>Emergency</b>	19 Police Vehicle 20 Fire Truck 21 Ambulance/Rescue			
<b>Other</b>	22 Taxi 23 Motor Home 24 Train 25 Farm Vehicle 26 Farm Equipment 27 Snowmobile 28 Construction Equip. 29 Animal W/Rider 30 Animal W/Buggy 31 Bicycle 32 All Others			
<b>Speed</b>	Unit	Estimated	Legal	
	A	5		
	B	15		
<b>Motorcycle Helmet Use</b>	Unit	Driver	Pass	
	A			
	B			
<b>1 No Helmet</b> <b>3 Full Facial Cover</b>	<b>2 Full Coverage</b> <b>4 Other Type Helmet</b>			

<b>Pre-Crash Actions</b>	A 8	B 1
<b>Driver Actions</b>		
1 Going Straight 2 Turning Right 3 Turning Left 4 Turning on Red Light 5 U Turn 6 Stopped To Turn 7 Stopped in Traffic 8 Parking/Unparking 9 Parked 10 Backing 11 Passing 12 Changing Lanes 13 Merging/Exiting Ramp 14 Out of Control 15 Swerving 16 Driverless Vehicle 17 Other Driver Action		
<b>Pedestrian Actions</b>		
18 Crossing in X-Walk 19 Crossing Other than X-Walk 20 Walking in Road (With Traffic) 21 Walking in Road (Against Traffic) 22 Playing in Road 23 Working on Road 24 Entering or Leaving Vehicle 25 Pushing/Working on Vehicle in Road 26 Other in Road 27 On Sidewalk or Shoulder		
<b>Traffic Control</b>	A 1	B 1
<b>Driver</b>		
1 No Controls 2 Stop Sign 3 Yield Sign 4 Traffic Signal 5 Traffic Flashers 6 School Zone 7 Railroad Crossbucks 8 Railroad Flashers 9 Railroad Gates 10 Construction Barricades 11 Police Officer 12 Pavement Markings 13 Other		
<b>Pedestrian</b>		
14 No Controls 15 Crosswalk Lines 16 Walk/Don't Walk Device		
<b>Fixed Object Struck</b>	A	B
1 None 2 Utility Pole 3 Traffic Sign 4 Bridge/Culvert 5 Guard Rail 6 Fence 7 Tree 8 Scrubbery 9 Curb 10 Ditch 11 Embankment 12 Building 13 Mail Box 14 Construction Barriage 15 Fire Hydrant 16 Other Object		

<b>Contributing Factor</b>	A 15	B 1
<b>Driver Error</b>		
1 None 2 Failure to Yield 3 Unsafe Speed 4 Following Too Closely or ACCDA 5 Ran Red Light 6 Ran Stop or Yield Sign 7 Improper Turn 8 Improper Passing 9 Improper Lane Change 10 Improper Backing 11 Improper Start from Parked Position 12 Stopped or Parked Illegally 13 Left of Center 14 Failure to Control 15 Driver Inattention 16 Drove Off Road Reason Unknown 17 Other Driver Error		
<b>Non-Driver Factor</b>		
18 Vehicle Defects 19 Load Shifting, Falling, Spilling 20 Pavement Defect 21 Shoulder Defect 22 Debris on Road 23 Downed Traffic Sign/Device 24 Vision Obstruction 25 Animal Actions 26 Pedestrian Actions		
<b>Vehicle Defects</b>		
Code # Contributing Factor is 18		
<b>Primary</b>	A	B
<b>Secondary</b>	A	B
<b>Truck Load</b>	A	B
1 Empty 2 Perishable Goods 3 General Freight 4 Metal-heavy Machinery 5 Hazardous Gas 6 Hazardous Liquid 7 Hazardous Solid 8 Radioactive Material		
<b>Truck Axles</b>	A	B
1 Turn Signals 2 Head Lamps 3 Tail Lamps 4 Brakes 5 Steering 6 Tire Blowout 7 Worn or Sick Tires 8 Trailer Equipment Defective 9 Motor Trouble 10 Disabled from Prior Accident 11 Other Defects		
<b>Tractor Trailer Rigs</b>		