

TRAFFIC CRASH REPORT

*DENOTES MANDATORY FIELD FOR SUPPLEMENT REPORT

LOCAL REPORT NUMBER*

000190011359

PHOTOS TAKEN
 SECONDARY CRASH
 OH-2
 OH-3
 OH-1P
 PRIVATE PROPERTY
 OTHER

LOCAL INFORMATION

REPORTING AGENCY NAME* **Clermont County SO.** NCIC* **1300**

HIT/SKIP
 1 - SOLVED
 2 - UNSOLVED
 NUMBER OF UNITS **02**
 UNIT IN ERROR
 98 - ANIMAL
 99 - UNKNOWN

COUNTY* **13** LOCALITY* **3** LOCATION: CITY, VILLAGE, TOWNSHIP* **Batavia**

CRASH DATE / TIME* **03262019 1026** CRASH SEVERITY **5**

ROUTE TYPE **SR** ROUTE NUMBER **125** PREFIX **4** LOCATION ROAD NAME **1212** ROAD TYPE

LATITUDE DECIMAL DEGREES **39.047232**

ROUTE TYPE ROUTE NUMBER PREFIX 1 - NORTH 2 - SOUTH 3 - EAST 4 - WEST REFERENCE ROAD NAME (ROAD, MILEPOST, HOUSE #) ROAD TYPE

LONGITUDE DECIMAL DEGREES **-84.245001**

REFERENCE POINT
 1 - INTERSECTION
 2 - MILE POST
 3 - HOUSE #
 DIRECTION FROM REFERENCE
 1 - NORTH
 2 - SOUTH
 3 - EAST
 4 - WEST
 ROUTE TYPE
 IR - INTERSTATE ROUTE(TP)
 US - FEDERAL US ROUTE
 SR - STATE ROUTE
 CR - NUMBERED COUNTY ROUTE
 TR - NUMBERED TOWNSHIP ROUTE
 ROAD TYPE
 AL - ALLEY
 AV - AVENUE
 BL - BOULEVARD
 CR - CIRCLE
 CT - COURT
 DR - DRIVE
 HE - HEIGHTS
 HW - HIGHWAY
 LA - LANE
 MP - MILEPOST
 OV - OVAL
 PK - PARKWAY
 PI - PIKE
 PL - PLACE
 RD - ROAD
 SQ - SQUARE
 ST - STREET
 TE - TERRACE
 TL - TRAIL
 WA - WAY

INTERSECTION RELATED
 WITHIN INTERSECTION OR ON APPROACH
 WITHIN INTERCHANGE AREA NUMBER OF APPROACHES
ROADWAY
 ROADWAY DIVIDED

LOCATION OF FIRST HARMFUL EVENT
 1 - ON ROADWAY
 2 - ON SHOULDER
 3 - IN MEDIAN
 4 - ON ROADSIDE
 5 - ON GORE
 6 - OUTSIDE TRAFFIC WAY
 7 - ON RAMP
 8 - OFF RAMP
 9 - CROSSOVER
 10 - DRIVEWAY/ALLEY ACCESS
 11 - RAILWAY GRADE CROSSING
 12 - SHARED USE PATHS OR TRAILS
 13 - BIKE LANE
 14 - TOLL BOOTH
 99 - OTHER / UNKNOWN

MANNER OF CRASH COLLISION/IMPACT
 1 - NOT COLLISION BETWEEN TWO MOTOR VEHICLES IN TRANSPORT
 2 - REAR-END
 3 - HEAD-ON
 4 - REAR-TO-REAR
 5 - BACKING
 6 - ANGLE
 7 - SIDESWIPE, SAME DIRECTION
 8 - SIDESWIPE, OPPOSITE DIRECTION
 9 - OTHER / UNKNOWN

DIRECTION OF TRAVEL
 1 - NORTH
 2 - SOUTH
 3 - EAST
 4 - WEST
 MEDIAN TYPE
 1 - DIVIDED FLUSH MEDIAN (<4 FEET)
 2 - DIVIDED FLUSH MEDIAN (≥4 FEET)
 3 - DIVIDED, DEPRESSED MEDIAN
 4 - DIVIDED, RAISED MEDIAN (ANY TYPE)
 9 - OTHER/UNKNOWN

WORK ZONE RELATED
 WORKERS PRESENT
 LAW ENFORCEMENT PRESENT
 ACTIVE SCHOOL ZONE

WORK ZONE TYPE
 1 - LANE CLOSURE
 2 - LANE SHIFT/CROSSOVER
 3 - WORK ON SHOULDER OR MEDIAN
 4 - INTERMITTENT OR MOVING WORK
 5 - OTHER

LOCATION OF CRASH IN WORK ZONE
 1 - BEFORE THE 1ST WORK ZONE WARNING SIGN
 2 - ADVANCE WARNING AREA
 3 - TRANSITION AREA
 4 - ACTIVITY AREA
 5 - TERMINATION AREA

CONTOUR
 1 - STRAIGHT LEVEL
 2 - STRAIGHT GRADE
 3 - CURVE LEVEL
 4 - CURVE GRADE
 9 - OTHER/UNKNOWN

CONDITIONS
 1 - DRY
 2 - WET
 3 - SNOW
 4 - ICE
 5 - SAND, MUD, DIRT, OIL, GRAVEL
 6 - WATER (STANDING, MOVING)
 7 - SLUSH
 9 - OTHER/UNKNOWN

SURFACE
 1 - CONCRETE
 2 - BLACKTOP, BITUMINOUS, ASPHALT
 3 - BRICK/BLOCK
 4 - SLAG, GRAVEL, STONE
 5 - DIRT
 9 - OTHER/UNKNOWN

LIGHT CONDITION
 1 - DAYLIGHT
 2 - DAWN/DUSK
 3 - DARK - LIGHTED ROADWAY
 4 - DARK - ROADWAY NOT LIGHTED
 5 - DARK - UNKNOWN ROADWAY LIGHTING
 9 - OTHER / UNKNOWN

WEATHER
 1 - CLEAR
 2 - CLOUDY
 3 - FOG, SMOG, SMOKE
 4 - RAIN
 5 - SLEET, HAIL
 6 - SNOW
 7 - SEVERE CROSSWINDS
 8 - BLOWING SAND, SOIL, DIRT, SNOW
 9 - FREEZING RAIN OR FREEZING DRIZZLE
 99 - OTHER / UNKNOWN

NARRATIVE
 ON THE DATE AND TIME LISTED BELOW, UNIT 1 WAS BACKING TRAVELING WEST TO EAST. UNIT 2 WAS TRAVELING NORTH TO SOUTH PROCEEDING TO PARK IN PARKING SPACE OF PARKING LOT, WHILE UNIT 1 WAS BACKING OUT OF PARKING SPACE, UNIT 2 WAS STRUCK ON THE PASSENGER SIDE OF THE VEHICLE.

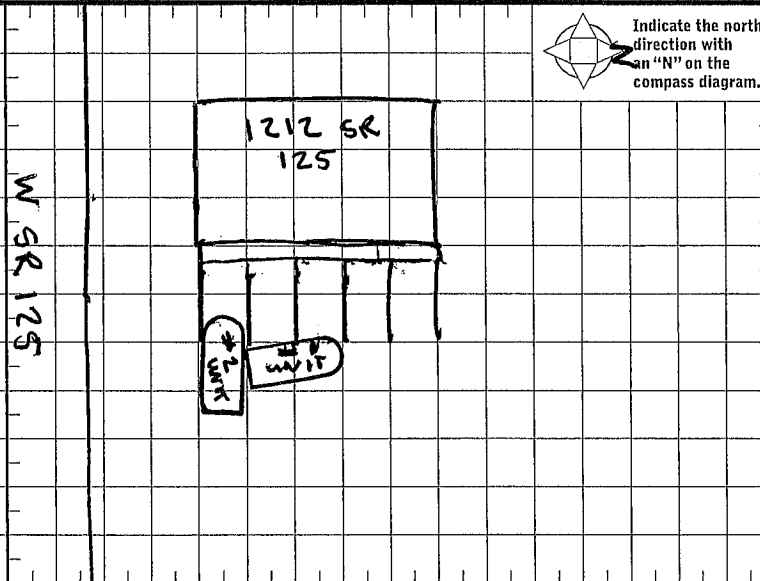

CRASH REPORTED DATE / TIME **03252019 2025** DISPATCH DATE / TIME **03252019 2027** ARRIVAL DATE / TIME **03252019 2028** SCENE CLEARED DATE / TIME **03252019 2057** REPORT TAKEN BY POLICE AGENCY MOTORIST

TOTAL TIME ROADWAY CLOSED OTHER INVESTIGATION TIME TOTAL MINUTES OFFICER'S NAME* **DEP. PHAM** CHECKED BY OFFICER'S NAME* OFFICER'S BADGE NUMBER* **12228** CHECKED BY OFFICER'S BADGE NUMBER* SUPPLEMENT (CORRECTION OR ADDITION TO AN EXISTING REPORT SENT TO OOPS)



MOTORIST / Non-MOTORIST

LOCAL REPORT NUMBER
000190011359

UNIT # 01	NAME: LAST, FIRST, MIDDLE HAHN, HAYLEY, R	DATE OF BIRTH 11182000	AGE 18	GENDER F
ADDRESS: STREET, CITY, STATE, ZIP 3525 SR 756, FELICITY, OH, 45120		CONTACT PHONE - INCLUDE AREA CODE		
INJURIES 5	INJURED TAKEN BY 1	EMS AGENCY (NAME)	INJURED TAKEN TO: MEDICAL FACILITY (NAME, CITY)	SAFETY EQUIPMENT USED 99
OL STATE OH	OPERATOR LICENSE NUMBER UU297171	OFFENSE CHARGED	LOCAL CODE	OFFENSE DESCRIPTION
OL CLASS D	ENDORSEMENT SELECT UP TO 2	RESTRICTION SELECT UP TO 3	DRIVER DISTRACTED BY 9	ALCOHOL / DRUG SUSPECTED <input type="checkbox"/> ALCOHOL <input type="checkbox"/> MARIJUANA <input type="checkbox"/> OTHER DRUG
CONDITION		ALCOHOL TEST STATUS TYPE VALUE		DRUG TEST(S) STATUS TYPE RESULT SELECT UP TO 4

UNIT # 02	NAME: LAST, FIRST, MIDDLE SMITH, MADISON, JADE	DATE OF BIRTH 02121999	AGE 20	GENDER F
ADDRESS: STREET, CITY, STATE, ZIP 2464 SR 222, NEW RICHMOND, OH, 45157		CONTACT PHONE - INCLUDE AREA CODE		
INJURIES 5	INJURED TAKEN BY 1	EMS AGENCY (NAME)	INJURED TAKEN TO: MEDICAL FACILITY (NAME, CITY)	SAFETY EQUIPMENT USED 99
OL STATE OH	OPERATOR LICENSE NUMBER VA489410	OFFENSE CHARGED	LOCAL CODE	OFFENSE DESCRIPTION
OL CLASS D	ENDORSEMENT SELECT UP TO 2	RESTRICTION SELECT UP TO 3	DRIVER DISTRACTED BY 9	ALCOHOL / DRUG SUSPECTED <input type="checkbox"/> ALCOHOL <input type="checkbox"/> MARIJUANA <input type="checkbox"/> OTHER DRUG
CONDITION		ALCOHOL TEST STATUS TYPE VALUE		DRUG TEST(S) STATUS TYPE RESULT SELECT UP TO 4

UNIT #	NAME: LAST, FIRST, MIDDLE	DATE OF BIRTH	AGE	GENDER
ADDRESS: STREET, CITY, STATE, ZIP		CONTACT PHONE - INCLUDE AREA CODE		
INJURIES	INJURED TAKEN BY	EMS AGENCY (NAME)	INJURED TAKEN TO: MEDICAL FACILITY (NAME, CITY)	SAFETY EQUIPMENT USED
OL STATE	OPERATOR LICENSE NUMBER	OFFENSE CHARGED	LOCAL CODE	OFFENSE DESCRIPTION
OL CLASS	ENDORSEMENT SELECT UP TO 2	RESTRICTION SELECT UP TO 3	DRIVER DISTRACTED BY	ALCOHOL / DRUG SUSPECTED <input type="checkbox"/> ALCOHOL <input type="checkbox"/> MARIJUANA <input type="checkbox"/> OTHER DRUG
CONDITION		ALCOHOL TEST STATUS TYPE VALUE		DRUG TEST(S) STATUS TYPE RESULT SELECT UP TO 4

INJURIES	SEATING POSITION	AIR BAG	OL CLASS	OL RESTRICTION(S)	DRIVER DISTRACTION	TEST STATUS
1 - FATAL	1 - FRONT - LEFT SIDE (MOTORCYCLE DRIVER)	1 - NOT DEPLOYED	1 - CLASS A	1 - ALCOHOL INTERLOCK DEVICE	1 - NOT DISTRACTED	1 - NONE GIVEN
2 - SUSPECTED SERIOUS INJURY	2 - FRONT - MIDDLE	2 - DEPLOYED FRONT	2 - CLASS B	2 - CDL INTRASTATE ONLY	2 - MANUALLY OPERATING AN ELECTRONIC COMMUNICATION DEVICE (TEXTING, TYPING, DIALING)	2 - TEST REFUSED
3 - SUSPECTED MINOR INJURY	3 - FRONT - RIGHT SIDE	3 - DEPLOYED SIDE	3 - CLASS C	3 - CORRECTIVE LENSES	3 - TALKING ON HANDS-FREE COMMUNICATION DEVICE	3 - TEST GIVEN, CONTAMINATED SAMPLE / UNUSABLE
4 - POSSIBLE INJURY	4 - SECOND - LEFT SIDE (MOTORCYCLE PASSENGER)	4 - DEPLOYED BOTH FRONT / SIDE	4 - REGULAR CLASS (OHIO = D)	4 - FARM WAIVER	4 - TALKING ON HAND-HELD COMMUNICATION DEVICE	4 - TEST GIVEN, RESULTS KNOWN
5 - NO APPARENT INJURY	5 - SECOND - MIDDLE	5 - NOT APPLICABLE	5 - M/C MOPED ONLY	5 - EXCEPT CLASS A BUS	5 - OTHER ACTIVITY WITH AN ELECTRONIC DEVICE	5 - TEST GIVEN, RESULTS UNKNOWN
INJURED TAKEN BY	6 - SECOND - RIGHT SIDE	9 - DEPLOYMENT UNKNOWN	6 - NO VALID OL	6 - EXCEPT CLASS A & CLASS B BUS	6 - PASSENGER	ALCOHOL TEST TYPE
1 - NOT TRANSPORTED / TREATED AT SCENE	7 - THIRD - LEFT SIDE (MOTORCYCLE SIDE CAR)	EJECTION	OL ENDORSEMENT	7 - EXCEPT TRACTOR-TRAILER	7 - OTHER DISTRACTION INSIDE THE VEHICLE	1 - NONE
2 - EMS	8 - THIRD - MIDDLE	1 - NOT EJECTED	H - HAZMAT	8 - INTERMEDIATE LICENSE RESTRICTIONS	8 - OTHER DISTRACTION OUTSIDE THE VEHICLE	2 - BLOOD
3 - POLICE	9 - THIRD - RIGHT SIDE	2 - PARTIALLY EJECTED	M - MOTORCYCLE	9 - LEARNER'S PERMIT RESTRICTIONS	9 - OTHER / UNKNOWN	3 - URINE
9 - OTHER / UNKNOWN	10 - SLEEPER SECTION OF TRUCK CAB	3 - TOTALLY EJECTED	P - PASSENGER	10 - LIMITED TO DAYLIGHT ONLY	CONDITION	4 - BREATH
SAFETY EQUIPMENT	11 - PASSENGER IN OTHER ENCLOSED CARGO AREA (NON-TRAILING UNIT, BUS, PICK-UP WITH CAP)	4 - NOT APPLICABLE	N - TANKER	11 - LIMITED TO EMPLOYMENT RESTRICTIONS	1 - APPARENTLY NORMAL	5 - OTHER
1 - NONE USED	12 - PASSENGER IN UNENCLOSED CARGO AREA	TRAPPED	Q - MOTOR SCOOTER	12 - LIMITED - OTHER	2 - PHYSICAL IMPAIRMENT	DRUG TEST TYPE
2 - SHOULDER BELT ONLY USED	13 - TRAILING UNIT	1 - NOT TRAPPED	R - THREE-WHEEL MOTORCYCLE	13 - MECHANICAL DEVICES (SPECIAL BRAKES, HAND CONTROLS, OR OTHER ADAPTIVE DEVICES)	3 - EMOTIONAL (E.G., DEPRESSED, ANGRY, DISTURBED)	1 - NONE
3 - LAP BELT ONLY USED	14 - RIDING ON VEHICLE EXTERIOR (NON-TRAILING UNIT)	2 - EXTRICATED BY MECHANICAL MEANS	S - SCHOOL BUS	14 - MILITARY VEHICLES ONLY	4 - ILLNESS	2 - BLOOD
4 - SHOULDER & LAP BELT USED	15 - NON-MOTORIST	3 - FREED BY NON-MECHANICAL MEANS	T - DOUBLE & TRIPLE TRAILERS	15 - MOTOR VEHICLES WITHOUT AIR BRAKES	5 - FELL ASLEEP, FAINTED, FATIGUED, ETC.	3 - URINE
5 - CHILD RESTRAINT SYSTEM - FORWARD FACING	99 - OTHER / UNKNOWN		X - TANKER / HAZMAT	16 - OUTSIDE MIRROR	6 - UNDER THE INFLUENCE OF MEDICATIONS / DRUGS / ALCOHOL	4 - OTHER
6 - CHILD RESTRAINT SYSTEM - REAR FACING				17 - PROSTHETIC AID	9 - OTHER / UNKNOWN	DRUG TEST RESULT(S)
7 - BOOSTER SEAT				18 - OTHER		1 - AMPHETAMINES
8 - HELMET USED						2 - BARBITURATES
9 - PROTECTIVE PADS USED (ELBOW, KNEES, ETC.)						3 - BENZODIAZEPINES
10 - REFLECTIVE CLOTHING						4 - CANNABINOIDS
11 - LIGHTING - PEDESTRIAN / BICYCLE ONLY						5 - COCAINE
99 - OTHER / UNKNOWN						6 - OPIATES / OPIOIDS
						7 - OTHER
						8 - NEGATIVE RESULTS

OWNER

UNIT # **01** OWNER NAME: LAST, FIRST, MIDDLE (SAME AS DRIVER) _____ OWNER PHONE: INCLUDE AREA CODE (SAME AS DRIVER) _____

OWNER ADDRESS: STREET, CITY, STATE, ZIP (SAME AS DRIVER) _____

COMMERCIAL CARRIER: NAME, ADDRESS, CITY, STATE, ZIP _____ COMMERCIAL CARRIER PHONE: INCLUDE AREA CODE _____

DAMAGE SCALE

DAMAGE SCALE

2 1 - NONE 3 - FUNCTIONAL DAMAGE
2 - MINOR DAMAGE 4 - DISABLING DAMAGE
9 - UNKNOWN

VEHICLE

LP STATE **OH** LICENSE PLATE # **HRK9330** VEHICLE IDENTIFICATION # **264W552M2X1599401** VEHICLE YEAR **1999** VEHICLE MAKE **BUICK**

INSURANCE VERIFIED INSURANCE COMPANY **PROGRESSIVE** INSURANCE POLICY # **928282878** COLOR **RED** VEHICLE MODEL **45**

COMMERCIAL GOVERNMENT IN EMERGENCY RESPONSE TYPE OF USE US DOT # TOWED BY: COMPANY NAME

INTERLOCK DEVICE EQUIPPED HIT/SKIP UNIT #OCCUPANTS **01** VEHICLE WEIGHT GVWR/GWR 1 - ≤10K LBS. 2 - 10,001 - 26K LBS. 3 - >26K LBS. HAZARDOUS MATERIAL MATERIAL RELEASED CLASS # PLACARD ID # PLACARD

DAMAGED AREA(S)
INDICATE ALL THAT APPLY

UNIT TYPE

1 - PASSENGER CAR 7 - MOTORCYCLE 2-WHEELED 12 - GOLF CART 18 - LIMO (LIVERY VEHICLE) 23 - PEDESTRIAN / SKATER
2 - PASSENGER VAN (MINIVAN) 8 - MOTORCYCLE 3-WHEELED 13 - SNOWMOBILE 19 - BUS (16+ PASSENGERS) 24 - WHEELCHAIR (ANY TYPE)
3 - SPORT UTILITY VEHICLE 9 - AUTOCYCLE 14 - SINGLE UNIT TRUCK 20 - OTHER VEHICLE 25 - OTHER NON-MOTORIST
4 - PICK UP 10 - MOPED OR MOTORIZED BICYCLE 21 - HEAVY EQUIPMENT 26 - BICYCLE
5 - CARGO VAN 11 - ALL TERRAIN VEHICLE (ATV / UTV) 15 - SEMI-TRACTOR 22 - ANIMAL WITH RIDER OR ANIMAL-DRAWN VEHICLE 27 - TRAIN
6 - VAN (9-15 SEATS) 17 - MOTORHOME 99 - UNKNOWN OR HIT/SKIP

OF TRAILING UNITS _____

WAS VEHICLE OPERATING IN AUTONOMOUS MODE WHEN CRASH OCCURRED? **2**

1 - YES 2 - NO 9 - OTHER / UNKNOWN

AUTONOMOUS MODE LEVEL

0 - NO AUTOMATION 1 - DRIVER ASSISTANCE 2 - PARTIAL AUTOMATION 3 - CONDITIONAL AUTOMATION 4 - HIGH AUTOMATION 5 - FULL AUTOMATION 9 - UNKNOWN

SPECIAL FUNCTION

1 - NONE 2 - TAXI 3 - ELECTRONIC RIDE SHARING 4 - SCHOOL TRANSPORT 5 - BUS - TRANSIT/COMMUTER 6 - BUS - CHARTER/TOUR 7 - BUS - INTERCITY 8 - BUS - SHUTTLE 9 - BUS - OTHER 10 - AMBULANCE 11 - FIRE 12 - MILITARY 13 - POLICE 14 - PUBLIC UTILITY 15 - CONSTRUCTION EQUIPMENT 16 - FARM 17 - MOWING 18 - SNOW REMOVAL 19 - TOWING 20 - SAFETY SERVICE PATROL 21 - MAIL CARRIER 99 - OTHER / UNKNOWN

CARGO BODY TYPE

1 - NO CARGO BODY TYPE / NOT APPLICABLE 2 - BUS 3 - VEHICLE TOWING ANOTHER MOTOR VEHICLE 4 - LOGGING 5 - INTERMODAL CONTAINER CHASSIS 6 - CARGO VAN/ENCLOSED BOX 7 - GRAIN/CHIPS/GRAVEL 8 - POLE 9 - CARGO TANK 10 - FLAT BED 11 - DUMP 12 - CONCRETE MIXER 13 - AUTO TRANSPORTER 14 - GARBAGE/REFUSE 99 - OTHER / UNKNOWN

- NO DAMAGE [0] - UNDERCARRIAGE [14]
 - TOP [13] - ALL AREAS [15]
 - UNIT NOT AT SCENE [16]

VEHICLE DEFECTS

1 - TURN SIGNALS 2 - HEAD LAMPS 3 - TAIL LAMPS 4 - BRAKES 5 - STEERING 6 - TIRE BLOWOUT 7 - WORN OR SLICK TIRES 8 - TRAILER EQUIPMENT DEFECTIVE 9 - MOTOR TROUBLE 10 - DISABLED FROM PRIOR ACCIDENT 99 - OTHER / UNKNOWN

NON-MOTORIST LOCATION AT IMPACT

1 - INTERSECTION - MARKED CROSSWALK 2 - INTERSECTION - UNMARKED CROSSWALK 3 - INTERSECTION - OTHER 4 - MIDDLEB - MARKED CROSSWALK 5 - TRAVEL LANE - OTHER LOCATION 6 - BICYCLE LANE 7 - SHOULDER / ROADSIDE 8 - SIDEWALK 9 - MEDIAN/CROSSING ISLAND 10 - DRIVEWAY ACCESS 11 - SHARED USE PATHS OR TRAILS 12 - FIRST RESPONDER AT INCIDENT SCENE 99 - OTHER / UNKNOWN

ACTION

1 - NON-CONTACT 2 - NON-COLLISION 3 - STRIKING 4 - STRUCK 5 - BOTH STRIKING & STRUCK 9 - OTHER / UNKNOWN 1 - STRAIGHT AHEAD 2 - BACKING 3 - CHANGING LANES 4 - OVERTAKING/PASSING 5 - MAKING RIGHT TURN 6 - MAKING LEFT TURN 7 - MAKING U-TURN 8 - ENTERING TRAFFIC LANE 9 - LEAVING TRAFFIC LANE 10 - PARKED 11 - SLOWING OR STOPPED IN TRAFFIC 12 - DRIVERLESS 13 - NEGOTIATING A CURVE 14 - ENTERING OR CROSSING SPECIFIED LOCATION 15 - WALKING, RUNNING, JOGGING, PLAYING 16 - WORKING 17 - PUSHING VEHICLE 18 - APPROACHING OR LEAVING VEHICLE 19 - STANDING 20 - OTHER NON-MOTORIST 21 - STANDING OUTSIDE DISABLED VEHICLE 99 - OTHER / UNKNOWN

INITIAL POINT OF CONTACT

0 - NO DAMAGE 1 - 12 - REFER TO UNIT DIAGRAM 13 - TOP 14 - UNDERCARRIAGE 15 - VEHICLE NOT AT SCENE 99 - UNKNOWN

CONTRIBUTING CIRCUMSTANCES

1 - NONE 2 - FAILURE TO YIELD 3 - RAN RED LIGHT 4 - RAN STOP SIGN 5 - UNSAFE SPEED 6 - IMPROPER TURN 7 - LEFT OF CENTER 8 - FOLLOWING TOO CLOSE / ACDA 9 - IMPROPER LANE CHANGE 10 - IMPROPER PASSING 11 - DROVE OFF ROAD 12 - IMPROPER BACKING 13 - IMPROPER START FROM A PARKED POSITION 14 - STOPPED OR PARKED ILLEGALLY 15 - SWERVING TO AVOID 16 - WRONG WAY 17 - VISION OBSTRUCTION 18 - OPERATING DEFECTIVE EQUIPMENT 19 - LOAD SHIFTING/FALLING/ SPILLING 20 - IMPROPER CROSSING 21 - LYING IN ROADWAY 22 - NOT DISCERNIBLE 23 - OPENING DOOR INTO ROADWAY 99 - OTHER IMPROPER ACTION

TRAFFIC

TRAFFICWAY FLOW

1 - ONE-WAY 2 - TWO-WAY

TRAFFIC CONTROL

1 - ROUNDABOUT 2 - SIGNAL 3 - FLASHER 4 - STOP SIGN 5 - YIELD SIGN 6 - NO CONTROL

OF THROUGH LANES ON ROAD _____ RAIL GRADE CROSSING

1 - NOT INVOLVED 2 - INVOLVED-ACTIVE CROSSING 3 - INVOLVED-PASSIVE CROSSING

SEQUENCE OF EVENTS

1 **20** 1 - OVERTURN/ROLLOVER 2 - FIRE/EXPLOSION 3 - IMMERSION 4 - JACKKNIFE 5 - CARGO / EQUIPMENT LOSS OR SHIFT 6 - EQUIPMENT FAILURE 7 - SEPARATION OF UNITS 8 - RAN OFF ROAD RIGHT 9 - RAN OFF ROAD LEFT 10 - CROSS MEDIAN 11 - CROSS CENTERLINE - OPPOSITE DIRECTION OF TRAVEL 12 - DOWNHILL RUNAWAY 13 - OTHER NON-COLLISION 14 - PEDESTRIAN 15 - PEDALCYCLE 16 - RAILWAY VEHICLE 17 - ANIMAL - FARM 18 - ANIMAL - DEER 19 - ANIMAL - OTHER 20 - MOTOR VEHICLE IN TRANSPORT 21 - PARKED MOTOR VEHICLE 22 - WORK ZONE MAINTENANCE EQUIPMENT 23 - STRUCK BY FALLING, SHIFTING CARGO OR ANYTHING SET IN MOTION BY A MOTOR VEHICLE 24 - OTHER MOVABLE OBJECT

UNIT / NON-MOTORIST DIRECTION

FROM **W** TO **3**

1 - NORTH 2 - SOUTH 3 - EAST 4 - WEST 5 - NORTHEAST 6 - NORTHWEST 7 - SOUTHEAST 8 - SOUTHWEST 9 - OTHER / UNKNOWN

COLLISION WITH FIXED OBJECT - STRUCK

25 - IMPACT ATTENUATOR / CRASH CUSHION 26 - BRIDGE OVERHEAD STRUCTURE 27 - BRIDGE PIER OR ABUTMENT 28 - BRIDGE PARAPET 29 - BRIDGE RAIL 30 - GUARDRAIL FACE 31 - GUARDRAIL END 32 - PORTABLE BARRIER 33 - MEDIAN CABLE BARRIER 34 - MEDIAN GUARDRAIL BARRIER 35 - MEDIAN CONCRETE BARRIER 36 - MEDIAN OTHER BARRIER 37 - TRAFFIC SIGN POST 38 - OVERHEAD SIGN POST 39 - LIGHT / LUMINARIES SUPPORT 40 - UTILITY POLE 41 - OTHER POST, POLE OR SUPPORT 42 - CULVERT 43 - CURB 44 - DITCH 45 - EMBANKMENT 46 - FENCE 47 - MAILBOX 48 - TREE 49 - FIRE HYDRANT 50 - WORK ZONE MAINTENANCE EQUIPMENT 51 - WALL 52 - BUILDING 53 - TUNNEL 54 - OTHER FIXED OBJECT 99 - OTHER / UNKNOWN

FIRST HARMFUL EVENT **20** MOST HARMFUL EVENT **20**

UNIT SPEED _____ POSTED SPEED _____

DETECTED SPEED

1 - STATED / ESTIMATED SPEED 2 - CALCULATED / EDR 3 - UNDETERMINED

UNIT # 02 OWNER NAME: LAST, FIRST, MIDDLE (SAME AS DRIVER) OWNER PHONE: INCLUDE AREA CODE (SAME AS DRIVER)

OWNER ADDRESS: STREET, CITY, STATE, ZIP (SAME AS DRIVER)

COMMERCIAL CARRIER: NAME, ADDRESS, CITY, STATE, ZIP COMMERCIAL CARRIER PHONE: INCLUDE AREA CODE

LP STATE A.K. LICENSE PLATE # 795XWZ VEHICLE IDENTIFICATION # 1HGFA16886L082918 VEHICLE YEAR 2006 VEHICLE MAKE HONDA

INSURANCE VERIFIED USAA INSURANCE POLICY # CIC043267341710 COLOR BLK VEHICLE MODEL CIVIC

TYPE OF USE: PASSENGER CAR, MOTORCYCLE 2-WHEELED, GOLF CART, LIMO (LIVERY VEHICLE), PEDESTRIAN / SKATER

US DOT # 1- <10K LBS., 2- 10,001 - 26K LBS., 3- >26K LBS.

HAZARDOUS MATERIAL: MATERIAL RELEASED, CLASS #, PLACARD ID #

VEHICLE WEIGHT GVWR/GCWR: 1- <10K LBS., 2- 10,001 - 26K LBS., 3- >26K LBS.

VEHICLE MAKE: HONDA, MODEL: CIVIC

VEHICLE TYPE: 01

SPECIAL FUNCTION: 01

CARGO BODY TYPE: 01

VEHICLE DEFECTS: 99

DAMAGE DAMAGE SCALE

2 1 - NONE 3 - FUNCTIONAL DAMAGE

2 - MINOR DAMAGE 4 - DISABLING DAMAGE

9 - UNKNOWN

DAMAGED AREA(S) INDICATE ALL THAT APPLY

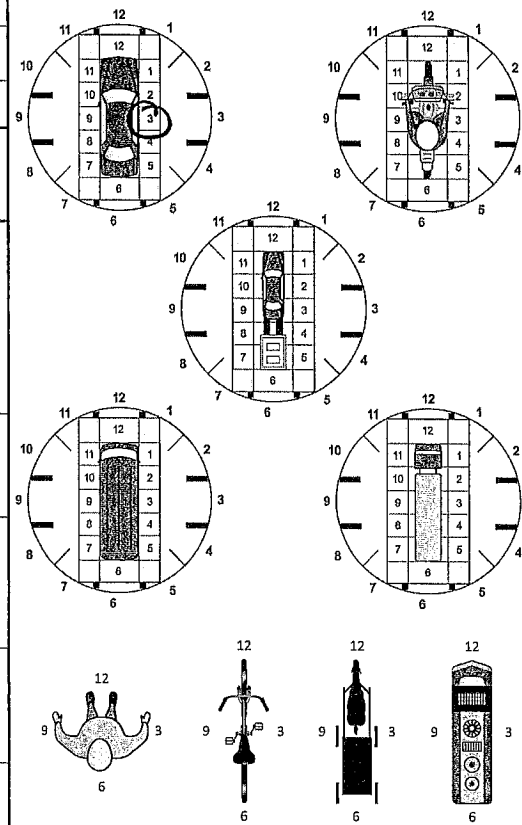

NO DAMAGE [0] UNDERCARRIAGE [14]

TOP [13] ALL AREAS [15]

UNIT NOT AT SCENE [16]

INITIAL POINT OF CONTACT

0 - NO DAMAGE 14 - UNDERCARRIAGE

01 1-12 - REFER TO UNIT DIAGRAM 15 - VEHICLE NOT AT SCENE

13 - TOP 99 - UNKNOWN

NON-MOTORIST LOCATION AT IMPACT: 1- INTERSECTION - MARKED CROSSWALK, 2- INTERSECTION - UNMARKED CROSSWALK, 3- INTERSECTION - OTHER, 4- MIDDLEBLOCK - MARKED CROSSWALK, 5- TRAVEL LANE - OTHER LOCATION, 6- BICYCLE LANE, 7- SHOULDER / ROADSIDE, 8- SIDEWALK, 9- MEDIUM CROSSING ISLAND, 10- DRIVEWAY ACCESS, 11- SHARED USE PATHS OR TRAILS, 12- FIRST RESPONDER AT INCIDENT SCENE, 99- OTHER / UNKNOWN

ACTION: 4

PRE-CRASH ACTIONS: 01

1- NON-CONTACT, 2- NON-COLLISION, 3- STRIKING, 4- STRUCK, 5- BOTH STRIKING & STRUCK, 9- OTHER / UNKNOWN

1- STRAIGHT AHEAD, 2- BACKING, 3- CHANGING LANES, 4- OVERTAKING/PASSING, 5- MAKING RIGHT TURN, 6- MAKING LEFT TURN

1- NONE, 2- FAILURE TO YIELD, 3- RAN RED LIGHT, 4- RAN STOP SIGN, 5- UNSAFE SPEED, 6- IMPROPER TURN

7- LEFT OF CENTER, 8- FOLLOWING TOO CLOSE / ACDA, 9- IMPROPER LANE CHANGE, 10- IMPROPER PASSING, 11- DROVE OFF ROAD, 12- IMPROPER BACKING

13- IMPROPER START FROM A PARKED POSITION, 14- STOPPED OR PARKED ILLEGALLY, 15- SWERVING TO AVOID, 16- WRONG WAY

17- VISION OBSTRUCTION, 18- OPERATING DEFECTIVE EQUIPMENT, 19- LOAD SHIFTING/FALLING/SPILLING, 20- IMPROPER CROSSING

21- LYING IN ROADWAY, 22- NOT DISCERNIBLE, 23- OPENING DOOR INTO ROADWAY, 99- OTHER IMPROPER ACTION

TRAFFIC TRAFFICWAY FLOW

1 - ONE-WAY 2 - TWO-WAY

TRAFFIC CONTROL: 1 - ROUNDABOUT, 2 - SIGNAL, 3 - FLASHER, 4 - STOP SIGN, 5 - YIELD SIGN, 6 - NO CONTROL

CONTRIBUTING CIRCUMSTANCES: 01

SEQUENCE OF EVENTS: 1, 2, 3

1- OVERTURN/ROLLOVER, 2- FIRE/EXPLOSION, 3- IMMERSION, 4- JACKKNIFE, 5- CARGO / EQUIPMENT LOSS OR SHIFT

6- EQUIPMENT FAILURE, 7- SEPARATION OF UNITS, 8- RAN OFF ROAD RIGHT, 9- RAN OFF ROAD LEFT, 10- CROSS MEDIAN

NON-COLLISION: 11- CROSS CENTERLINE - OPPOSITE DIRECTION OF TRAVEL, 12- DOWNHILL RUNAWAY, 13- OTHER NON-COLLISION, 14- PEDESTRIAN, 15- PEDALCYCLE

16- RAILWAY VEHICLE, 17- ANIMAL - FARM, 18- ANIMAL - DEER, 19- ANIMAL - OTHER, 20- MOTORVEHICLE IN TRANSPORT, 21- PARKED MOTOR VEHICLE

22- WORK ZONE MAINTENANCE EQUIPMENT, 23- STRUCK BY FALLING, SHIFTING CARGO OR ANYTHING SET IN MOTION BY A MOTOR VEHICLE, 24- OTHER MOVABLE OBJECT

OF THROUGH LANES ON ROAD

RAIL GRADE CROSSING: 1 - NOT INVOLVED, 2 - INVOLVED-ACTIVE CROSSING, 3 - INVOLVED-PASSIVE CROSSING

COLLISION WITH FIXED OBJECT - STRUCK

25- IMPACT ATTENUATOR / CRASH CUSHION, 26- BRIDGE OVERHEAD STRUCTURE, 27- BRIDGE PIER OR ABUTMENT, 28- BRIDGE PARAPET, 29- BRIDGE RAIL, 30- GUARDRAIL FACE

31- GUARDRAIL END, 32- PORTABLE BARRIER, 33- MEDIAN CABLE BARRIER, 34- MEDIAN GUARDRAIL BARRIER, 35- MEDIAN CONCRETE BARRIER, 36- MEDIAN OTHER BARRIER

37- TRAFFIC SIGN POST, 38- OVERHEAD SIGN POST, 39- LIGHT / LUMINARIES SUPPORT, 40- UTILITY POLE, 41- OTHER POST, POLE OR SUPPORT, 42- CULVERT

43- CURB, 44- DITCH, 45- EMBANKMENT, 46- FENCE, 47- MAILBOX, 48- TREE, 49- FIRE HYDRANT

50- WORK ZONE MAINTENANCE EQUIPMENT, 51- WALL, 52- BUILDING, 53- TUNNEL, 54- OTHER FIXED OBJECT, 99- OTHER / UNKNOWN

FIRST HARMFUL EVENT: 20 MOST HARMFUL EVENT: 20

UNIT / NON-MOTORIST DIRECTION

FROM 1 TO 2

1 - NORTH, 2 - SOUTH, 3 - EAST, 4 - WEST, 5 - NORTHEAST, 6 - NORTHWEST, 7 - SOUTHEAST, 8 - SOUTHWEST, 9 - OTHER / UNKNOWN

UNIT SPEED

POSTED SPEED

DETECTED SPEED: 1 - STATED / ESTIMATED SPEED, 2 - CALCULATED / EDR, 3 - UNDETERMINED

LOCAL REPORT NUMBER 000190011359	REPORTING AGENCY Clermont County S.O	DATE OF CRASH M 03 D 25 Y 2019
IN COUNTY OF Clermont	CRASH LOCATION 1212 W SR 125, Amelita, OH 45102	

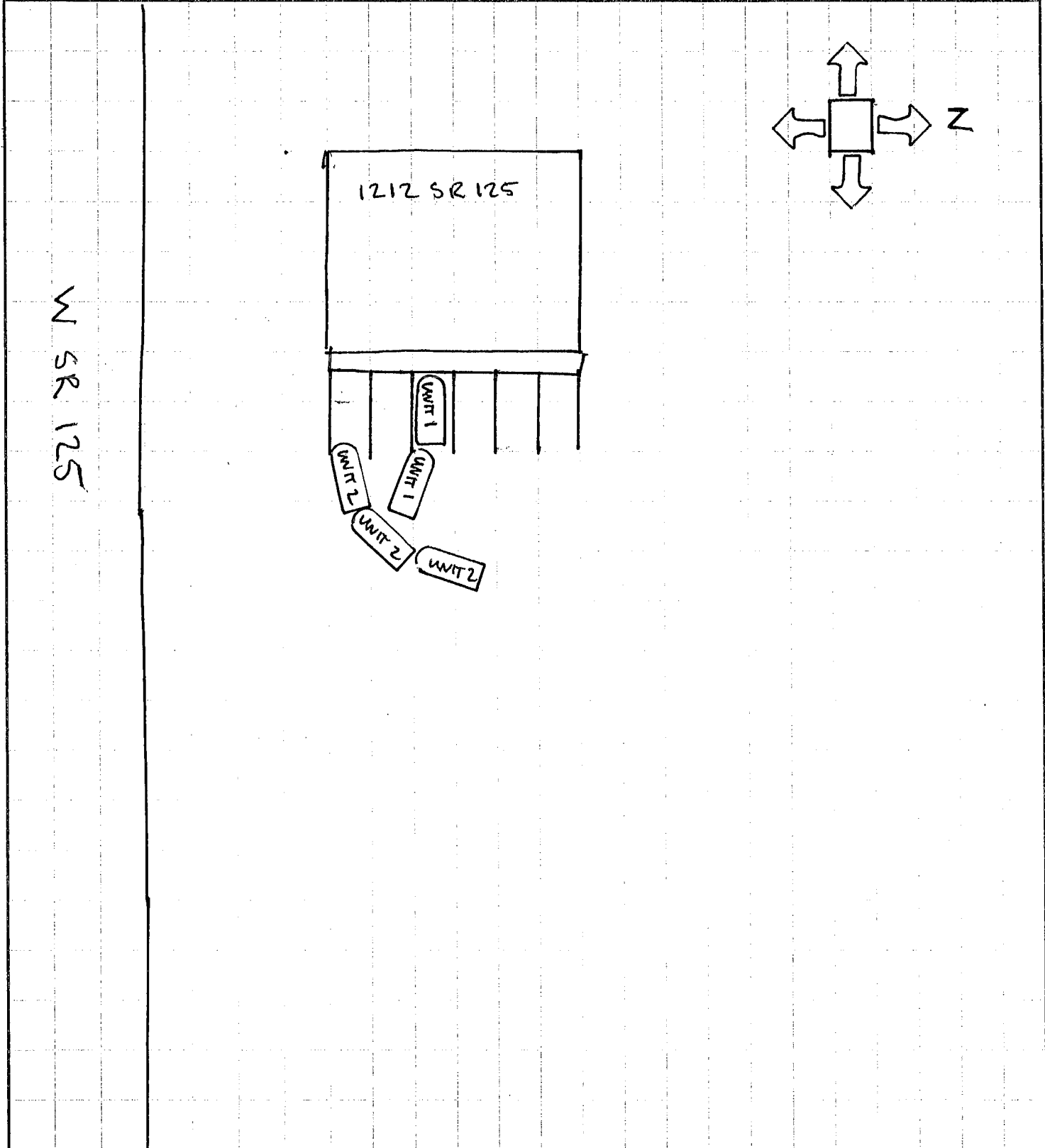

OFFICER'S SIGNATURE X <i>Det. Tran</i>	BADGE NUMBER # 12228
-------------------------------------------	-------------------------