

TRAFFIC CRASH REPORT

*DENOTES MANDATORY FIELD FOR SUPPLEMENT REPORT

LOCAL REPORT NUMBER *

00210003392

<input checked="" type="checkbox"/> PHOTOS TAKEN <input type="checkbox"/> SECONDARY CRASH <input checked="" type="checkbox"/> PRIVATE PROPERTY		<input type="checkbox"/> OH-2 <input type="checkbox"/> OH-1P <input type="checkbox"/> OTHER	LOCAL INFORMATION REPORTING AGENCY NAME * Clermont County Sheriff	NCIC * 01300	HIT/SKIP 1 - SOLVED 2 - UNSOLVED	NUMBER OF UNITS 2	UNIT IN ERROR 1 - FATAL 98 - ANIMAL 99 - UNKNOWN
COUNTY* 13	LOCALITY* 3 - TOWNSHIP	LOCATION: CITY, VILLAGE, TOWNSHIP* Batavia			CRASH DATE / TIME* 01/28/2021 05:00		CRASH SEVERITY 1 - FATAL 2 - SERIOUS INJURY SUSPECTED 3 - MINOR INJURY SUSPECTED 4 - INJURY POSSIBLE 5 - PROPERTY DAMAGE ONLY
ROUTE TYPE	ROUTE NUMBER	PREFIX 1 - NORTH 2 - SOUTH 3 - EAST 4 - WEST	LOCATION ROAD NAME LORI		ROAD TYPE LA	LATITUDE DECIMAL DEGREES 39.037869	
ROUTE TYPE	ROUTE NUMBER	PREFIX 1 - NORTH 2 - SOUTH 3 - EAST 4 - WEST	REFERENCE ROAD NAME (ROAD, MILEPOST, HOUSE #) 33		ROAD TYPE	LONGITUDE DECIMAL DEGREES -84.225197	

REFERENCE POINT 1 - INTERSECTION 2 - MILE POST 3 - HOUSE #	DIRECTION FROM REFERENCE 1 - NORTH 2 - SOUTH 3 - EAST 4 - WEST	ROUTE TYPE IR - INTERSTATE ROUTE (TP) US - FEDERAL US ROUTE SR - STATE ROUTE CR - NUMBERED COUNTY ROUTE TR - NUMBERED TOWNSHIP ROUTE	ROAD TYPE AL - ALLEY AV - AVENUE BL - BOULEVARD CR - CIRCLE CT - COURT DR - DRIVE HE - HEIGHTS HW - HIGHWAY LA - LANE MP - MILEPOST OV - OVAL PK - PARKWAY PI - PIKE PL - PLACE RD - ROAD SQ - SQUARE ST - STREET TE - TERRACE TL - TRAIL WA - WAY	INTERSECTION RELATED <input type="checkbox"/> WITHIN INTERSECTION OR ON APPROACH <input type="checkbox"/> WITHIN INTERCHANGE AREA
DISTANCE FROM REFERENCE		DISTANCE UNIT OF MEASURE 1 - MILES 2 - FEET 3 - YARDS		ROADWAY <input type="checkbox"/> ROADWAY DIVIDED

LOCATION OF FIRST HARMFUL EVENT 1 - ON ROADWAY 2 - ON SHOULDER 3 - IN MEDIAN 4 - ON ROADSIDE 5 - ON GORE 6 - OUTSIDE TRAFFIC WAY 7 - ON RAMP 8 - OFF RAMP	MANNER OF CRASH COLLISION/IMPACT 1 - NOT COLLISION BETWEEN TWO MOTOR VEHICLES IN TRANSPORT 2 - REAR-END 3 - HEAD-ON 4 - REAR-TO-REAR 5 - BACKING 6 - ANGLE 7 - SIDESWIPE, SAME DIRECTION 8 - SIDESWIPE, OPPOSITE DIRECTION 9 - OTHER / UNKNOWN	DIRECTION OF TRAVEL 1 - NORTH 2 - SOUTH 3 - EAST 4 - WEST	MEDIAN TYPE 1 - DIVIDED FLUSH MEDIAN (<4 FEET) 2 - DIVIDED FLUSH MEDIAN (≥4 FEET) 3 - DIVIDED, DEPRESSED MEDIAN 4 - DIVIDED, RAISED MEDIAN (ANY TYPE) 9 - OTHER / UNKNOWN
---	---	---	--

<input type="checkbox"/> WORK ZONE RELATED <input type="checkbox"/> WORKERS PRESENT <input type="checkbox"/> LAW ENFORCEMENT PRESENT <input type="checkbox"/> ACTIVE SCHOOL ZONE	WORK ZONE TYPE 1 - LANE CLOSURE 2 - LANE SHIFT/ CROSSOVER 3 - WORK ON SHOULDER OR MEDIAN 4 - INTERMITTENT OR MOVING WORK 5 - OTHER	LOCATION OF CRASH IN WORK ZONE 1 - BEFORE THE 1ST WORK ZONE WARNING SIGN 2 - ADVANCE WARNING AREA 3 - TRANSITION AREA 4 - ACTIVITY AREA 5 - TERMINATION AREA	CONTOUR 1 - STRAIGHT LEVEL 2 - STRAIGHT GRADE 3 - CURVE LEVEL 4 - CURVE GRADE 9 - OTHER /UNKNOWN	CONDITIONS 1 - DRY 2 - WET 3 - SNOW 4 - ICE 5 - SAND, MUD, DIRT, OIL, GRAVEL 6 - WATER (STANDING, MOVING) 7 - SLUSH 9 - OTHER / UNKNOWN	SURFACE 1 - CONCRETE 2 - BLACKTOP, BITUMINOUS, ASPHALT 3 - BRICK/BLOCK 4 - SLAG, GRAVEL, STONE 5 - DIRT 9 - OTHER / UNKNOWN
---	---	---	---	---	---

LIGHT CONDITION 1 - DAYLIGHT 2 - DAWN/DUSK 3 - DARK - LIGHTED ROADWAY 4 - DARK - ROADWAY NOT LIGHTED 5 - DARK - UNKNOWN ROADWAY LIGHTING 9 - OTHER / UNKNOWN	WEATHER 1 - CLEAR 2 - CLOUDY 3 - FOG, SMOG, SMOKE 4 - RAIN 5 - SLEET, HAIL 6 - SNOW 7 - SEVERE CROSSWINDS 8 - BLOWING SAND, SOIL, DIRT, SNOW 9 - FREEZING RAIN OR FREEZING DRIZZLE 99 - OTHER / UNKNOWN
--	---

NARRATIVE
 ON THE ABOVE DATE AND TIME, MR. ADAM STRUNK REPORTED THAT HIS VEHICLE WAS HIT OVER NIGHT IN THE PARKING LOT OF HIS APARTMENT COMPLEX. MR. STRUNK ADVISED THAT HE LAST SEEN HIS VEHICLE ON JANUARY 28, 2021 AT 0500 AND WHEN HE WALKED OUTSIDE ON HIS BALCONY AT 1315 HE NOTICED THAT HIS VEHICLE WAS MOVED SIDWAYS.

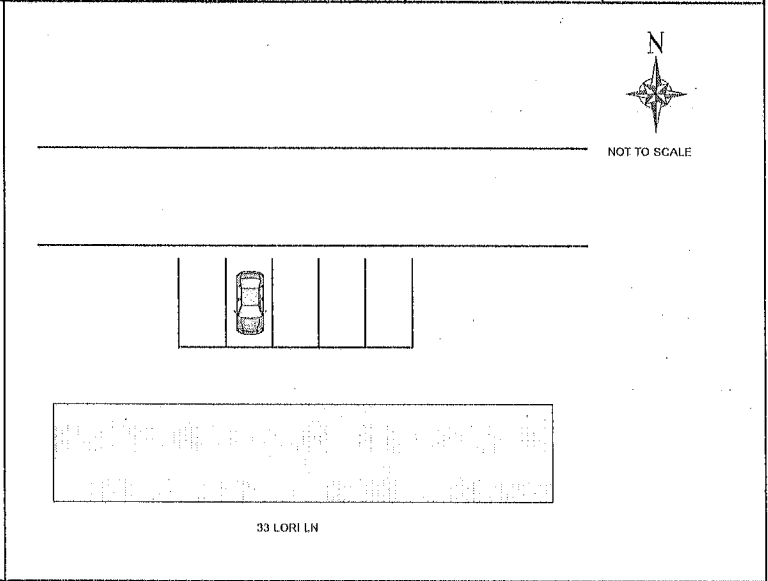

CRASH REPORTED DATE / TIME 01/28/2021 13:41	DISPATCH DATE / TIME 01/28/2021 14:29	ARRIVAL DATE / TIME 01/28/2021 14:36	SCENE CLEARED DATE / TIME 01/28/2021 14:54	REPORT TAKEN BY <input checked="" type="checkbox"/> POLICE AGENCY <input type="checkbox"/> MOTORIST
TOTAL TIME ROADWAY CLOSED	OTHER INVESTIGATION TIME	TOTAL MINUTES 25	OFFICER'S NAME* Kuhn, Jillian	CHECKED BY OFFICER'S NAME* Rudd, Jeffrey
			OFFICER'S BADGE NUMBER* R4064	CHECKED BY OFFICER'S BADGE NUMBER* R3052
<input checked="" type="checkbox"/> SUPPLEMENT (CORRECTION OR ADDITION TO AN EXISTING REPORT SENT TO ODPS)				

OWNER

UNIT # 1 OWNER NAME: LAST, FIRST, MIDDLE (SAME AS DRIVER)
 UNKNOWN, UNKNOWN
 OWNER ADDRESS: STREET, CITY, STATE, ZIP (SAME AS DRIVER)
 UNKNOWN, OH
 COMMERCIAL CARRIER: NAME, ADDRESS, CITY, STATE, ZIP
 COMMERCIAL CARRIER PHONE: INCLUDE AREA CODE

VEHICLE

LP STATE _____ LICENSE PLATE # _____ VEHICLE IDENTIFICATION # _____ VEHICLE YEAR _____ VEHICLE MAKE _____

INSURANCE VERIFIED INSURANCE COMPANY _____ INSURANCE POLICY # _____ COLOR _____ VEHICLE MODEL _____

COMMERCIAL GOVERNMENT IN EMERGENCY RESPONSE
 TYPE OF USE US DOT # TOWED BY: COMPANY NAME

INTERLOCK DEVICE EQUIPPED HIT/SKIP UNIT # OCCUPANTS _____
 VEHICLE WEIGHT GVWR/GCWR HAZARDOUS MATERIAL CLASS # PLACARD ID #

1 - ≤ 10K LBS.
 2 - 10,001 - 26K LBS.
 3 - > 26K LBS.

UNIT TYPE

1 - PASSENGER CAR	6 - VAN (9-15 SEATS)	12 - GOLF CART	18 - LIMO (LIVERY VEHICLE)	23 - PEDESTRIAN/SKATER
2 - PASSENGER VAN (MINIVAN)	7 - MOTORCYCLE 2-WHEELED	13 - SNOWMOBILE	19 - BUS (16+ PASSENGERS)	24 - WHEELCHAIR (ANY TYPE)
3 - SPORT UTILITY VEHICLE	8 - MOTORCYCLE 3-WHEELED	14 - SINGLE UNIT TRUCK	20 - OTHER VEHICLE	25 - OTHER NON-MOTORIST
4 - PICK UP	9 - AUTOCYCLE	15 - SEMI-TRACTOR	21 - HEAVY EQUIPMENT	26 - BICYCLE
5 - CARGO VAN	10 - MOPED OR MOTORIZED BICYCLE	16 - FARM EQUIPMENT	22 - ANIMAL WITH RIDER OR ANIMAL-DRAWN VEHICLE	27 - TRAIN
	11 - ALL TERRAIN VEHICLE (ATV/UTV)	17 - MOTORHOME	99 - UNKNOWN OR HIT/SKIP	

OF TRAILING UNITS _____

WAS VEHICLE OPERATING IN AUTONOMOUS MODE WHEN CRASH OCCURRED?

2 1 - YES 2 - NO 9 - OTHER / UNKNOWN AUTONOMOUS MODE LEVEL

0 0 - NO AUTOMATION 3 - CONDITIONAL AUTOMATION 9 - UNKNOWN
 1 - DRIVER ASSISTANCE 4 - HIGH AUTOMATION 5 - FULL AUTOMATION

SPECIAL FUNCTION

1 - NONE	6 - BUS - CHARTER/TOUR	11 - FIRE	16 - FARM	21 - MAIL CARRIER
2 - TAXI	7 - BUS - INTERCITY	12 - MILITARY	17 - MOWING	99 - OTHER / UNKNOWN
3 - ELECTRONIC RIDE SHARING	8 - BUS - SHUTTLE	13 - POLICE	18 - SNOW REMOVAL	
4 - SCHOOL TRANSPORT	9 - BUS - OTHER	14 - PUBLIC UTILITY	19 - TOWING	
5 - BUS - TRANSIT/COMMUTER	10 - AMBULANCE	15 - CONSTRUCTION EQUIP.	20 - SAFETY SERVICE PATROL	

CARGO BODY TYPE

1 - NO CARGO BODY TYPE / NOT APPLICABLE	4 - LOGGING	7 - GRAIN/CHIPS/GRAVEL	11 - DUMP	99 - OTHER / UNKNOWN
2 - BUS	5 - INTERMODAL CONTAINER CHASSIS	8 - POLE	12 - CONCRETE MIXER	
3 - VEHICLE TOWING ANOTHER MOTOR VEHICLE	6 - CARGOVAN / ENCLOSED BOX	9 - CARGO TANK	13 - AUTO TRANSPORTER	
		10 - FLAT BED	14 - GARBAGE/REFUSE	

VEHICLE DEFECTS

<u>99</u> 1 - TURN SIGNALS	4 - BRAKES	7 - WORN OR SLICK TIRES	9 - MOTOR TROUBLE	99 - OTHER / UNKNOWN
2 - HEAD LAMPS	5 - STEERING	8 - TRAILER EQUIPMENT DEFECTIVE	10 - DISABLED FROM PRIOR ACCIDENT	
3 - TAIL LAMPS	6 - TIRE BLOWOUT			

NON-MOTORIST LOCATION AT IMPACT

1 - INTERSECTION - MARKED CROSSWALK	4 - MIDBLOCK - MARKED CROSSWALK	7 - SHOULDER/ROADSIDE	10 - DRIVEWAY ACCESS	99 - OTHER / UNKNOWN
2 - INTERSECTION - UNMARKED CROSSWALK	5 - TRAVEL LANE - OTHER LOCATION	8 - SIDEWALK	11 - SHARED USE PATHS OR TRAILS	
3 - INTERSECTION - OTHER	6 - BICYCLE LANE	9 - MEDIUM/CROSSING ISLAND	12 - FIRST RESPONDER AT INCIDENT SCENE	

ACTION

<u>3</u> 1 - NON-CONTACT	<u>1</u> 1 - STRAIGHT AHEAD	9 - LEAVING TRAFFIC LANE	15 - WALKING, RUNNING, JOGGING, PLAYING	21 - STANDING OUTSIDE DISABLED VEHICLE
2 - NON-COLLISION	2 - BACKING	10 - PARKED	16 - WORKING	99 - OTHER / UNKNOWN
3 - STRIKING	3 - CHANGING LANES	11 - STOPPED OR STOPPED IN TRAFFIC	17 - PUSHING VEHICLE	
4 - STRUCK	4 - OVERTAKING/PASSING	12 - DRIVERLESS	18 - APPROACHING OR LEAVING VEHICLE	
5 - BOTH STRIKING & STRUCK	5 - MAKING RIGHT TURN	13 - NEGOTIATING A CURVE	19 - STANDING	
9 - OTHER / UNKNOWN	6 - MAKING LEFT TURN	14 - ENTERING OR CROSSING SPECIFIED LOCATION	20 - OTHER NON-MOTORIST	
	7 - MAKING U-TURN			
	8 - ENTERING TRAFFIC LANE			

CONTRIBUTING CIRCUMSTANCES

<u>99</u> 1 - NONE	8 - FOLLOWING TOO CLOSE /ACDA	13 - IMPROPER START FROM A PARKED POSITION	18 - OPERATING DEFECTIVE EQUIPMENT	23 - OPENING DOOR INTO ROADWAY
2 - FAILURE TO YIELD	9 - IMPROPER LANE CHANGE	14 - STOPPED OR PARKED ILLEGALLY	19 - LOAD SHIFTING /FALLING/SPILLING	99 - OTHER IMPROPER ACTION
3 - RAN RED LIGHT	10 - IMPROPER PASSING	15 - SWERVING TO AVOID	20 - IMPROPER CROSSING	
4 - RAN STOP SIGN	11 - DROVE OFF ROAD	16 - WRONG WAY	21 - LYING IN ROADWAY	
5 - UNSAFE SPEED	12 - IMPROPER BACKING	17 - VISION OBSTRUCTION	22 - NOT DISCERNIBLE	
6 - IMPROPER TURN				
7 - LEFT OF CENTER				

SEQUENCE OF EVENTS

<u>1</u> <u>21</u> 1 - OVERTURN/ROLLOVER	7 - SEPARATION OF UNITS	EVENTS	19 - ANIMAL - OTHER	23 - STRUCK BY FALLING, SHIFTING CARGO OR ANYTHING SET IN MOTION BY A MOTOR VEHICLE
2 - FIRE/EXPLOSION	8 - RAN OFF ROAD RIGHT	12 - DOWNHILL RUNAWAY	20 - MOTOR VEHICLE IN TRANSPORT	24 - OTHER MOVABLE OBJECT
3 - IMMERSION	9 - RAN OFF ROAD LEFT	13 - OTHER NON-COLLISION	21 - PARKED MOTOR VEHICLE	
4 - JACKKNIFE	10 - CROSS MEDIAN	14 - PEDESTRIAN	22 - WORK ZONE MAINTENANCE EQUIPMENT	
5 - CARGO / EQUIPMENT LOSS OR SHIFT	11 - CROSS CENTERLINE - OPPOSITE DIRECTION OF TRAVEL	15 - PEDALCYCLE		
6 - EQUIPMENT FAILURE		16 - RAILWAY VEHICLE		
		17 - ANIMAL - FARM		
		18 - ANIMAL - DEER		

COLLISION WITH FIXED OBJECT - STRUCK

<u>1</u> 25 - IMPACT ATTENUATOR / CRASH CUSHION	31 - GUARDRAIL END	38 - OVERHEAD SIGN POST	45 - EMBANKMENT	52 - BUILDING
26 - BRIDGE OVERHEAD STRUCTURE	32 - PORTABLE BARRIER	39 - LIGHT / LUMINARIES SUPPORT	46 - FENCE	53 - TUNNEL
27 - BRIDGE PIER OR ABUTMENT	33 - MEDIAN CABLE BARRIER	40 - UTILITY POLE	47 - MAILBOX	54 - OTHER FIXED OBJECT
28 - BRIDGE PARAPET	34 - MEDIAN GUARDRAIL BARRIER	41 - OTHER POST, POLE OR SUPPORT	48 - TREE	99 - OTHER / UNKNOWN
29 - BRIDGE RAIL	35 - MEDIAN CONCRETE BARRIER	42 - CULVERT	49 - FIRE HYDRANT	
30 - GUARDRAIL FACE	36 - MEDIAN OTHER BARRIER	43 - CURB	50 - WORK ZONE MAINTENANCE EQUIPMENT	
	37 - TRAFFIC SIGN POST	44 - DITCH	51 - WALL	

FIRST HARMFUL EVENT 1 MOST HARMFUL EVENT 1

DAMAGE

DAMAGE SCALE

1 - NONE 3 - FUNCTIONAL DAMAGE
 2 - MINOR DAMAGE 4 - DISABLING DAMAGE
 9 - UNKNOWN

DAMAGED AREA(S)
 INDICATE ALL THAT APPLY.

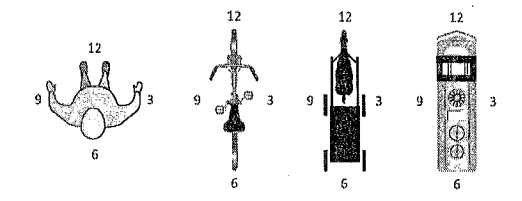
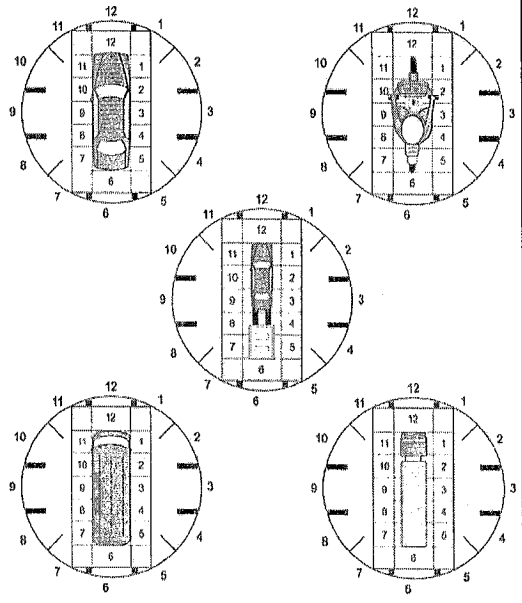

NO DAMAGE [0] UNDERCARRIAGE [14]
 TOP [13] ALL AREAS [15]
 UNIT NOT AT SCENE [16]

INITIAL POINT OF CONTACT

12 0 - NO DAMAGE 14 - UNDERCARRIAGE
 1-12 - REFER TO UNIT DIAGRAM 15 - VEHICLE NOT AT SCENE
 99 - UNKNOWN
 13 - TOP

TRAFFIC

TRAFFICWAY FLOW

<u>2</u> 1 - ONE-WAY	TRAFFIC CONTROL
2 - TWO-WAY	1 - ROUNDABOUT 4 - STOP SIGN
	2 - SIGNAL 5 - YIELD SIGN
	3 - FLASHER 6 - NO CONTROL

OF THROUGH LANES ON ROAD 2

RAIL GRADE CROSSING

<u>1</u> 1 - NOT INVOLVED
2 - INVOLVED-ACTIVE CROSSING
3 - INVOLVED-PASSIVE CROSSING

UNIT / NON-MOTORIST DIRECTION

FROM <u>4</u> TO <u>3</u>	1 - NORTH 5 - NORTHEAST
	2 - SOUTH 6 - NORTHWEST
	3 - EAST 7 - SOUTHEAST
	4 - WEST 8 - SOUTHWEST
	9 - OTHER / UNKNOWN

UNIT SPEED _____ DETECTED SPEED _____

POSTED SPEED _____

1 - STATED / ESTIMATED SPEED
 2 - CALCULATED / EDR
 3 - UNDETERMINED

OWNER

UNIT # 2 OWNER NAME: LAST, FIRST, MIDDLE (SAME AS DRIVER)
2 STRUNK, BETHANY, J

OWNER ADDRESS: STREET, CITY, STATE, ZIP (SAME AS DRIVER)
2395 SR 222, NEW RICHMOND, OH, 45157

COMMERCIAL CARRIER: NAME, ADDRESS, CITY, STATE, ZIP _____
 COMMERCIAL CARRIER PHONE: INCLUDE AREA CODE _____

DAMAGE

DAMAGE SCALE

1 - NONE
2 2 - MINOR DAMAGE
 3 - FUNCTIONAL DAMAGE
 4 - DISABLING DAMAGE
 9 - UNKNOWN

VEHICLE

LP STATE OH LICENSE PLATE # HIN2316 VEHICLE IDENTIFICATION # 3LNHL2GC8BR772315 VEHICLE YEAR 2011 VEHICLE MAKE LINCOLN

INSURANCE VERIFIED INSURANCE COMPANY ALLSTATE INSURANCE POLICY # 992789965 COLOR WHI VEHICLE MODEL MKZ

COMMERCIAL GOVERNMENT IN EMERGENCY RESPONSE TYPE OF USE US DOT # TOWED BY: COMPANY NAME

INTERLOCK DEVICE EQUIPPED HIT/SKIP UNIT # OCCUPANTS VEHICLE WEIGHT GVWR/GCWR HAZARDOUS MATERIAL CLASS # PLACARD ID #

1 - ≤ 10K LBS.
 2 - 10.001 - 26K LBS.
 3 - > 26K LBS.

DAMAGED AREA(S)

INDICATE ALL THAT APPLY

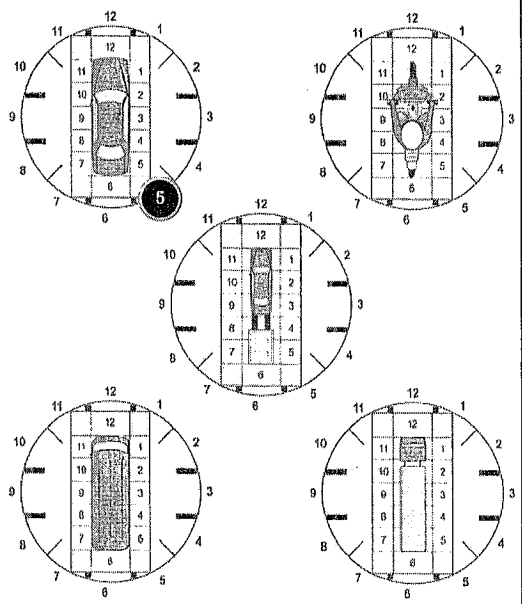

UNIT TYPE

1 - PASSENGER CAR
 2 - PASSENGER VAN (MINIVAN)
 3 - SPORT UTILITY VEHICLE
 4 - PICK UP
 5 - CARGO VAN
 6 - VAN (9-15 SEATS)
 7 - MOTORCYCLE 2-WHEELED
 8 - MOTORCYCLE 3-WHEELED
 9 - AUTOCYCLE
 10 - MOPED OR MOTORIZED BICYCLE
 11 - ALL TERRAIN VEHICLE (ATV/UTV)
 12 - GOLF CART
 13 - SNOWMOBILE
 14 - SINGLE UNIT TRUCK
 15 - SEMI-TRACTOR
 16 - FARM EQUIPMENT
 17 - MOTORHOME
 18 - LIMO (LIVERY VEHICLE)
 19 - BUS (16+ PASSENGERS)
 20 - OTHER VEHICLE
 21 - HEAVY EQUIPMENT
 22 - ANIMAL WITH RIDER OR ANIMAL-DRAWN VEHICLE
 23 - PEDESTRIAN/SKATER
 24 - WHEELCHAIR (ANY TYPE)
 25 - OTHER NON-MOTORIST
 26 - BICYCLE
 27 - TRAIN
 99 - UNKNOWN OR HIT/SKIP

of TRAILING UNITS _____

WAS VEHICLE OPERATING IN AUTONOMOUS MODE WHEN CRASH OCCURRED?

2 1 - YES 2 - NO 9 - OTHER / UNKNOWN AUTONOMOUS MODE LEVEL

0 - NO AUTOMATION 1 - DRIVER ASSISTANCE 2 - PARTIAL AUTOMATION 3 - CONDITIONAL AUTOMATION 4 - HIGH AUTOMATION 5 - FULL AUTOMATION 9 - UNKNOWN

SPECIAL FUNCTION

1 - NONE
 2 - TAXI
 3 - ELECTRONIC RIDE SHARING
 4 - SCHOOL TRANSPORT
 5 - BUS - TRANSIT/COMMUTER
 6 - BUS - CHARTER/TOUR
 7 - BUS - INTERCITY
 8 - BUS - SHUTTLE
 9 - BUS - OTHER
 10 - AMBULANCE
 11 - FIRE
 12 - MILITARY
 13 - POLICE
 14 - PUBLIC UTILITY
 15 - CONSTRUCTION EQUIP.
 16 - FARM
 17 - MOWING
 18 - SNOW REMOVAL
 19 - TOWING
 20 - SAFETY SERVICE PATROL
 21 - MAIL CARRIER
 99 - OTHER / UNKNOWN

CARGO BODY TYPE

1 - NO CARGO BODY TYPE / NOT APPLICABLE
 2 - BUS
 3 - VEHICLE TOWING ANOTHER MOTOR VEHICLE
 4 - LOGGING
 5 - INTERMODAL CONTAINER CHASSIS
 6 - CARGOVAN / ENCLOSED BOX
 7 - GRAIN/CHIPS/GRAVEL
 8 - POLE
 9 - CARGO TANK
 10 - FLAT BED
 11 - DUMP
 12 - CONCRETE MIXER
 13 - AUTO TRANSPORTER
 14 - GARBAGE/REFUSE
 99 - OTHER / UNKNOWN

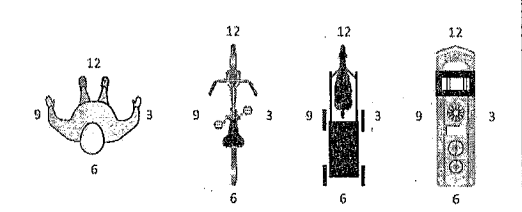

VEHICLE DEFECTS

1 - TURN SIGNALS
 2 - HEAD LAMPS
 3 - TAIL LAMPS
 4 - BRAKES
 5 - STEERING
 6 - TIRE BLOWOUT
 7 - WORN OR SLICK TIRES
 8 - TRAILER EQUIPMENT DEFECTIVE
 9 - MOTOR TROUBLE
 10 - DISABLED FROM PRIOR ACCIDENT
 99 - OTHER / UNKNOWN

NO DAMAGE [0] UNDERCARRIAGE [14]

TOP [13] ALL AREAS [15]

UNIT NOT AT SCENE [16]

NON-MOTORIST LOCATION AT IMPACT

1 - INTERSECTION - MARKED CROSSWALK
 2 - INTERSECTION - UNMARKED CROSSWALK
 3 - INTERSECTION - OTHER
 4 - MIDBLOCK - MARKED CROSSWALK
 5 - INTERSECTION - OTHER LOCATION
 6 - BICYCLE LANE
 7 - SHOULDER/ROADSIDE
 8 - SIDEWALK
 9 - MEDIAN/CROSSING ISLAND
 10 - DRIVEWAY ACCESS
 11 - SHARED USE PATHS OR TRAILS
 12 - FIRST RESPONDER AT INCIDENT SCENE
 99 - OTHER / UNKNOWN

ACTION

1 - NON-COLLISION
 2 - NON-COLLISION
 3 - STRIKING
 4 - STRUCK
 5 - BOTH STRIKING & STRUCK
 9 - OTHER / UNKNOWN
 10 - PRE-CRASH ACTIONS

1 - STRAIGHT AHEAD
 2 - BACKING
 3 - CHANGING LANES
 4 - OVERTAKING/PASSING
 5 - MAKING RIGHT TURN
 6 - MAKING LEFT TURN
 7 - MAKING U-TURN
 8 - ENTERING TRAFFIC LANE
 9 - LEAVING TRAFFIC LANE
 10 - PARKED
 11 - SLOWING OR STOPPED IN TRAFFIC
 12 - DRIVERLESS
 13 - NEGOTIATING A CURVE
 14 - ENTERING OR CROSSING SPECIFIED LOCATION
 15 - WALKING, RUNNING, JOGGING, PLAYING
 16 - WORKING
 17 - PUSHING VEHICLE
 18 - APPROACHING OR LEAVING VEHICLE
 19 - STANDING
 20 - OTHER NON-MOTORIST
 21 - STANDING OUTSIDE DISABLED VEHICLE
 99 - OTHER / UNKNOWN

INITIAL POINT OF CONTACT

0 - NO DAMAGE
5 1-12 - REFER TO UNIT DIAGRAM
 13 - TOP
 14 - UNDERCARRIAGE
 15 - VEHICLE NOT AT SCENE
 99 - UNKNOWN

CONTRIBUTING CIRCUMSTANCES

1 - NONE
 2 - FAILURE TO YIELD
 3 - RAN RED LIGHT
 4 - RAN STOP SIGN
 5 - UNSAFE SPEED
 6 - IMPROPER TURN
 7 - LEFT OF CENTER
 8 - FOLLOWING TOO CLOSE /ACDA
 9 - IMPROPER LANE CHANGE
 10 - IMPROPER PASSING
 11 - DROVE OFF ROAD
 12 - IMPROPER BACKING
 13 - IMPROPER START FROM A PARKED POSITION
 14 - STOPPED OR PARKED ILLEGALLY
 15 - SWERVING TO AVOID
 16 - WRONG WAY
 17 - VISION OBSTRUCTION
 18 - OPERATING DEFECTIVE EQUIPMENT
 19 - LOAD SHIFTING /FALLING/SPILLING
 20 - IMPROPER CROSSING
 21 - LYING IN ROADWAY
 22 - NOT DISCERNIBLE
 23 - OPENING DOOR INTO ROADWAY
 99 - OTHER IMPROPER ACTION

TRAFFIC

TRAFFICWAY FLOW

1 - ONE-WAY
2 2 - TWO-WAY

TRAFFIC CONTROL

1 - ROUNDABOUT
 2 - SIGNAL
 3 - FLASHER
 4 - STOP SIGN
 5 - YIELD SIGN
 6 - NO CONTROL

SEQUENCE OF EVENTS

1 20 1 - OVERTURN/ROLLOVER
 2 - FIRE/EXPLOSION
 3 - IMMERSION
 4 - JACKKNIFE
 5 - CARGO / EQUIPMENT LOSS OR SHIFT
 6 - EQUIPMENT FAILURE

7 - SEPARATION OF UNITS
 8 - RAN OFF ROAD RIGHT
 9 - RAN OFF ROAD LEFT
 10 - CROSS MEDIAN
 11 - CROSS CENTERLINE - OPPOSITE DIRECTION OF TRAVEL

12 - DOWNHILL RUNAWAY
 13 - OTHER NON-COLLISION
 14 - PEDESTRIAN
 15 - PEDALCYCLE
 16 - RAILWAY VEHICLE
 17 - ANIMAL - FARM
 18 - ANIMAL - DEER

19 - ANIMAL - OTHER
 20 - MOTOR VEHICLE IN TRANSPORT
 21 - PARKED MOTOR VEHICLE
 22 - WORK ZONE MAINTENANCE EQUIPMENT
 23 - STRUCK BY FALLING, SHIFTING CARGO OR ANYTHING SET IN MOTION BY A MOTOR VEHICLE
 24 - OTHER MOVABLE OBJECT

OF THROUGH LANES ON ROAD

2

RAIL GRADE CROSSING

1 - NOT INVOLVED
1 2 - INVOLVED-ACTIVE CROSSING
 3 - INVOLVED-PASSIVE CROSSING

EVENTS

COLLISION WITH FIXED OBJECT - STRUCK

25 - IMPACT ATTENUATOR / CRASH CUSHION
 26 - BRIDGE OVERHEAD STRUCTURE
 27 - BRIDGE PIER OR ABUTMENT
 28 - BRIDGE PARAPET
 29 - BRIDGE RAIL
 30 - GUARDRAIL FACE
 31 - GUARDRAIL END
 32 - PORTABLE BARRIER
 33 - MEDIAN CABLE BARRIER
 34 - MEDIAN GUARDRAIL BARRIER
 35 - MEDIAN CONCRETE BARRIER
 36 - MEDIAN OTHER BARRIER
 37 - TRAFFIC SIGN POST
 38 - OVERHEAD SIGN POST
 39 - LIGHT / LUMINARIES SUPPORT
 40 - UTILITY POLE
 41 - OTHER POST, POLE OR SUPPORT
 42 - CULVERT
 43 - CURB
 44 - DITCH
 45 - EMBANKMENT
 46 - FENCE
 47 - MAILBOX
 48 - TREE
 49 - FIRE HYDRANT
 50 - WORK ZONE MAINTENANCE EQUIPMENT
 51 - WALL
 52 - BUILDING
 53 - TUNNEL
 54 - OTHER FIXED OBJECT
 99 - OTHER / UNKNOWN

FIRST HARMFUL EVENT 1 MOST HARMFUL EVENT 1

UNIT / NON-MOTORIST DIRECTION

1 - NORTH
 2 - SOUTH
 3 - EAST
 4 - WEST
 5 - NORTHEAST
 6 - NORTHWEST
 7 - SOUTHEAST
 8 - SOUTHWEST
 9 - OTHER / UNKNOWN

UNIT SPEED

DETECTED SPEED

1 - STATED / ESTIMATED SPEED
 2 - CALCULATED / EDR
 3 - UNDETERMINED



MOTORIST / Non-MOTORIST

LOCAL REPORT NUMBER

00210003392

UNIT # 1	NAME: LAST, FIRST, MIDDLE UNKNOWN, UNKNOWN		DATE OF BIRTH		AGE	GENDER U			
ADDRESS: STREET, CITY, STATE, ZIP UNKNOWN, OH					CONTACT PHONE - INCLUDE AREA CODE				
INJURIES 5	INJURED TAKEN BY 1	EMS AGENCY (NAME)	INJURED TAKEN TO: MEDICAL FACILITY (NAME, CITY)	SAFETY EQUIPMENT USED 99	<input type="checkbox"/> DOT-COMPLIANT <input checked="" type="checkbox"/> MC HELMET	SEATING POSITION 1	AIR BAG USAGE 9	EJECTION 1	TRAPPED 1
OL STATE	OPERATOR LICENSE NUMBER		OFFENSE CHARGED	LOCAL CODE <input type="checkbox"/>	OFFENSE DESCRIPTION		CITATION NUMBER		
OL CLASS	ENDORSEMENT	RESTRICTION SELECT UP TO 3	DRIVER DISTRACTED BY	ALCOHOL / DRUG SUSPECTED <input type="checkbox"/> ALCOHOL <input type="checkbox"/> MARIJUANA <input type="checkbox"/> OTHER DRUG	CONDITION 9	ALCOHOL TEST STATUS TYPE VALUE		DRUG TEST(S) STATUS TYPE RESULTS SELECT UP TO 4	

UNIT #	NAME: LAST, FIRST, MIDDLE		DATE OF BIRTH		AGE	GENDER			
ADDRESS: STREET, CITY, STATE, ZIP					CONTACT PHONE - INCLUDE AREA CODE				
INJURIES	INJURED TAKEN BY	EMS AGENCY (NAME)	INJURED TAKEN TO: MEDICAL FACILITY (NAME, CITY)	SAFETY EQUIPMENT USED	<input type="checkbox"/> DOT-COMPLIANT <input checked="" type="checkbox"/> MC HELMET	SEATING POSITION	AIR BAG USAGE	EJECTION	TRAPPED
OL STATE	OPERATOR LICENSE NUMBER		OFFENSE CHARGED	LOCAL CODE <input type="checkbox"/>	OFFENSE DESCRIPTION		CITATION NUMBER		
OL CLASS	ENDORSEMENT	RESTRICTION SELECT UP TO 3	DRIVER DISTRACTED BY	ALCOHOL / DRUG SUSPECTED <input type="checkbox"/> ALCOHOL <input type="checkbox"/> MARIJUANA <input type="checkbox"/> OTHER DRUG	CONDITION	ALCOHOL TEST STATUS TYPE VALUE		DRUG TEST(S) STATUS TYPE RESULTS SELECT UP TO 4	

UNIT #	NAME: LAST, FIRST, MIDDLE		DATE OF BIRTH		AGE	GENDER			
ADDRESS: STREET, CITY, STATE, ZIP					CONTACT PHONE - INCLUDE AREA CODE				
INJURIES	INJURED TAKEN BY	EMS AGENCY (NAME)	INJURED TAKEN TO: MEDICAL FACILITY (NAME, CITY)	SAFETY EQUIPMENT USED	<input type="checkbox"/> DOT-COMPLIANT <input checked="" type="checkbox"/> MC HELMET	SEATING POSITION	AIR BAG USAGE	EJECTION	TRAPPED
OL STATE	OPERATOR LICENSE NUMBER		OFFENSE CHARGED	LOCAL CODE <input type="checkbox"/>	OFFENSE DESCRIPTION		CITATION NUMBER		
OL CLASS	ENDORSEMENT	RESTRICTION SELECT UP TO 3	DRIVER DISTRACTED BY	ALCOHOL / DRUG SUSPECTED <input type="checkbox"/> ALCOHOL <input type="checkbox"/> MARIJUANA <input type="checkbox"/> OTHER DRUG	CONDITION	ALCOHOL TEST STATUS TYPE VALUE		DRUG TEST(S) STATUS TYPE RESULTS SELECT UP TO 4	

INJURIES	SEATING POSITION	AIR BAG	OL CLASS	OL RESTRICTION(S)	DRIVER DISTRACTION	TEST STATUS
1 - FATAL 2 - SUSPECTED SERIOUS INJURY 3 - SUSPECTED MINOR INJURY 4 - POSSIBLE INJURY 5 - NO APPARENT INJURY	1 - FRONT - LEFT SIDE (MOTORCYCLE DRIVER) 2 - FRONT - MIDDLE 3 - FRONT - RIGHT SIDE 4 - SECOND - LEFT SIDE (MOTORCYCLE PASSENGER) 5 - SECOND - MIDDLE 6 - SECOND - RIGHT SIDE 7 - THIRD - LEFT SIDE (MOTORCYCLE SIDE CAR) 8 - THIRD - MIDDLE 9 - THIRD - RIGHT SIDE 10 - SLEEPER SECTION OF TRUCK CAB 11 - PASSENGER IN OTHER ENCLOSED CARGO AREA (NON-TRAILING UNIT, BUS, PICK-UP WITH CAP) 12 - PASSENGER IN UNENCLOSED CARGO AREA 13 - TRAILING UNIT 14 - RIDING ON VEHICLE EXTERIOR (NON-TRAILING UNIT) 15 - NON-MOTORIST 99 - OTHER / UNKNOWN	1 - NOT DEPLOYED 2 - DEPLOYED FRONT 3 - DEPLOYED SIDE 4 - DEPLOYED BOTH FRONT/SIDE 5 - NOT APPLICABLE 9 - DEPLOYMENT UNKNOWN	1 - CLASS A 2 - CLASS B 3 - CLASS C 4 - REGULAR CLASS (OHIO = D) 5 - M/C MOPED ONLY 6 - NO VALID OL	1 - ALCOHOL INTERLOCK DEVICE 2 - CDL INTRASTATE ONLY 3 - CORRECTIVE LENSES 4 - FARM WAIVER 5 - EXCEPT CLASS A BUS & CLASS B BUS 6 - EXCEPT CLASS A 7 - EXCEPT TRACTOR-TRAILER 8 - INTERMEDIATE LICENSE RESTRICTIONS 9 - LEARNER'S PERMIT RESTRICTIONS 10 - LIMITED TO DAYLIGHT ONLY 11 - LIMITED TO EMPLOYMENT 12 - LIMITED - OTHER 13 - MECHANICAL DEVICES (SPECIAL BRAKES, HAND CONTROLS, OR OTHER ADAPTIVE DEVICES) 14 - MILITARY VEHICLES ONLY 15 - MOTOR VEHICLES WITHOUT AIR BRAKES 16 - OUTSIDE MIRROR 17 - PROSTHETIC AID 18 - OTHER	1 - NOT DISTRACTED 2 - MANUALLY OPERATING AN ELECTRONIC COMMUNICATION DEVICE (TEXTING, TYPING, DIALING) 3 - TALKING ON HANDS-FREE COMMUNICATION DEVICE 4 - TALKING ON HAND-HELD COMMUNICATION DEVICE 5 - OTHER ACTIVITY WITH AN ELECTRONIC DEVICE 6 - PASSENGER 7 - OTHER DISTRACTION INSIDE THE VEHICLE 8 - OTHER DISTRACTION OUTSIDE THE VEHICLE 9 - OTHER / UNKNOWN	1 - NONE GIVEN 2 - TEST REFUSED 3 - TEST GIVEN, CONTAMINATED SAMPLE / UNUSABLE 4 - TEST GIVEN, RESULTS KNOWN 5 - TEST GIVEN, RESULTS UNKNOWN
INJURIES TAKEN BY 1 - NOT TRANSPORTED /TREATED AT SCENE 2 - EMS 3 - POLICE 9 - OTHER / UNKNOWN	TRAPPED 1 - NOT TRAPPED 2 - EXTRICATED BY MECHANICAL MEANS 3 - FREED BY NON-MECHANICAL MEANS	EJECTION 1 - NOT EJECTED 2 - PARTIALLY EJECTED 3 - TOTALLY EJECTED 4 - NOT APPLICABLE	OL ENDORSEMENT H - HAZMAT M - MOTORCYCLE P - PASSENGER N - TANKER Q - MOTOR SCOOTER R - THREE-WHEEL MOTORCYCLE S - SCHOOL BUS T - DOUBLE & TRIPLE TRAILERS X - TANKER / HAZMAT	CONDITION 1 - APPARENTLY NORMAL 2 - PHYSICAL IMPAIRMENT 3 - EMOTIONAL (E.G., DEPRESSED, ANGRY, DISTURBED) 4 - ILLNESS 5 - FELL ASLEEP, FAINTED, FATIGUED, ETC. 6 - UNDER THE INFLUENCE OF MEDICATIONS / DRUGS / ALCOHOL 9 - OTHER / UNKNOWN	ALCOHOL TEST TYPE 1 - NONE 2 - BLOOD 3 - URINE 4 - BREATH 5 - OTHER	DRUG TEST TYPE 1 - NONE 2 - BLOOD 3 - URINE 4 - OTHER
SAFETY EQUIPMENT 1 - NONE USED 2 - SHOULDER BELT ONLY USED 3 - LAP BELT ONLY USED 4 - SHOULDER & LAP BELT USED 5 - CHILD RESTRAINT SYSTEM - FORWARD FACING 6 - CHILD RESTRAINT SYSTEM - REAR FACING 7 - BOOSTER SEAT 8 - HELMET USED 9 - PROTECTIVE PADS USED (ELBOWS, KNEES, ETC) 10 - REFLECTIVE CLOTHING 11 - LIGHTING - PEDESTRIAN / BICYCLE ONLY 99 - OTHER / UNKNOWN			GENDER F - FEMALE M - MALE U - OTHER / UNKNOWN			DRUG TEST RESULT(S) 1 - AMPHETAMINES 2 - BARBITURATES 3 - BENZODIAZEPINES 4 - CANNABINOIDS 5 - COCAINE 6 - OPIATES / OPIOIDS 7 - OTHER 8 - NEGATIVE RESULTS



OCCUPANT / WITNESS ADDENDUM

LOCAL REPORT NUMBER

00210003392

OCCUPANT	UNIT #	NAME: LAST, FIRST, MIDDLE			DATE OF BIRTH	AGE	GENDER			
	ADDRESS: STREET, CITY, STATE, ZIP				CONTACT PHONE - INCLUDE AREA CODE					
	INJURIES	INJURED TAKEN BY	EMS AGENCY (NAME)	INJURED TAKEN TO: MEDICAL FACILITY (NAME, CITY)	SAFETY EQUIPMENT	<input type="checkbox"/> DOT-COMPLIANT MC HELMET	SEATING POSITION	AIR BAG USAGE	EJECTION	TRAPPED
OCCUPANT	UNIT #	NAME: LAST, FIRST, MIDDLE			DATE OF BIRTH	AGE	GENDER			
	ADDRESS: STREET, CITY, STATE, ZIP				CONTACT PHONE - INCLUDE AREA CODE					
	INJURIES	INJURED TAKEN BY	EMS AGENCY (NAME)	INJURED TAKEN TO: MEDICAL FACILITY (NAME, CITY)	SAFETY EQUIPMENT	<input type="checkbox"/> DOT-COMPLIANT MC HELMET	SEATING POSITION	AIR BAG USAGE	EJECTION	TRAPPED
OCCUPANT	UNIT #	NAME: LAST, FIRST, MIDDLE			DATE OF BIRTH	AGE	GENDER			
	ADDRESS: STREET, CITY, STATE, ZIP				CONTACT PHONE - INCLUDE AREA CODE					
	INJURIES	INJURED TAKEN BY	EMS AGENCY (NAME)	INJURED TAKEN TO: MEDICAL FACILITY (NAME, CITY)	SAFETY EQUIPMENT	<input type="checkbox"/> DOT-COMPLIANT MC HELMET	SEATING POSITION	AIR BAG USAGE	EJECTION	TRAPPED
OCCUPANT	UNIT #	NAME: LAST, FIRST, MIDDLE			DATE OF BIRTH	AGE	GENDER			
	ADDRESS: STREET, CITY, STATE, ZIP				CONTACT PHONE - INCLUDE AREA CODE					
	INJURIES	INJURED TAKEN BY	EMS AGENCY (NAME)	INJURED TAKEN TO: MEDICAL FACILITY (NAME, CITY)	SAFETY EQUIPMENT	<input type="checkbox"/> DOT-COMPLIANT MC HELMET	SEATING POSITION	AIR BAG USAGE	EJECTION	TRAPPED

INJURIES	SAFETY EQUIPMENT USED	SEATING POSITION	AIR BAG USAGE
1 - FATAL	1 - NONE USED - VEHICLE OCCUPANT	1 - FRONT - LEFT SIDE (MOTORCYCLE DRIVER)	1 - NOT DEPLOYED
2 - SUSPECTED SERIOUS INJURY	2 - SHOULDER BELT ONLY USED	2 - FRONT - MIDDLE	2 - DEPLOYED FRONT
3 - SUSPECTED MINOR INJURY	3 - LAP BELT ONLY USED	3 - FRONT - RIGHT SIDE	3 - DEPLOYED SIDE
4 - POSSIBLE INJURY	4 - SHOULDER & LAP BELT USED	4 - SECOND - LEFT SIDE (MOTORCYCLE PASSENGER)	4 - DEPLOYED BOTH FRONT/SIDE
5 - NO APPARENT INJURY	5 - CHILD RESTRAINT SYSTEM - FORWARD FACING	5 - SECOND - MIDDLE	5 - NOT APPLICABLE
INJURED TAKEN BY	6 - CHILD RESTRAINT SYSTEM - REAR FACING	6 - SECOND - RIGHT SIDE	9 - DEPLOYMENT UNKNOWN
1 - NOT TRANSPORTED / TREATED AT SCENE	7 - BOOSTER SEAT	7 - THIRD - LEFT SIDE (MOTORCYCLE SIDE CAR)	EJECTION
2 - EMS	8 - HELMET USED	8 - THIRD - MIDDLE	1 - NOT EJECTED
3 - POLICE	9 - PROTECTIVE PADS USED (ELBOWS, KNEES, ETC)	9 - THIRD - RIGHT SIDE	2 - PARTIALLY EJECTED
9 - OTHER / UNKNOWN	10 - REFLECTIVE CLOTHING	10 - SLEEPER SECTION OF TRUCK CAB	3 - TOTALLY EJECTED
GENDER	11 - LIGHTING - PEDESTRIAN / BICYCLE ONLY	11 - PASSENGER IN OTHER ENCLOSED CARGO AREA (NON-TRAILING UNIT SUCH AS A BUS, PICK-UP WITH CAP)	4 - NOT APPLICABLE
F - FEMALE	99 - OTHER / UNKNOWN	12 - PASSENGER IN UNENCLOSED CARGO AREA	TRAPPED
M - MALE		13 - TRAILING UNIT	1 - NOT TRAPPED
U - OTHER / UNKNOWN		14 - RIDING ON VEHICLE EXTERIOR (NON-TRAILING UNIT)	2 - EXTRICATED BY MECHANICAL MEANS
		15 - NON-MOTORIST	3 - FREED BY NON-MECHANICAL MEANS
		99 - OTHER / UNKNOWN	

WITNESS	NAME: LAST, FIRST, MIDDLE	DATE OF BIRTH	AGE	GENDER
	ADDRESS: STREET, CITY, STATE, ZIP	CONTACT PHONE - INCLUDE AREA CODE		
WITNESS	NAME: LAST, FIRST, MIDDLE	DATE OF BIRTH	AGE	GENDER
	ADDRESS: STREET, CITY, STATE, ZIP	CONTACT PHONE - INCLUDE AREA CODE		
WITNESS	NAME: LAST, FIRST, MIDDLE	DATE OF BIRTH	AGE	GENDER
	ADDRESS: STREET, CITY, STATE, ZIP	CONTACT PHONE - INCLUDE AREA CODE		