

# TRAFFIC CRASH REPORT

\*DENOTES MANDATORY FIELD FOR SUPPLEMENT REPORT

LOCAL REPORT NUMBER \*

002100024394

<input type="checkbox"/> PHOTOS TAKEN <input type="checkbox"/> SECONDARY CRASH <input checked="" type="checkbox"/> PRIVATE PROPERTY	<input type="checkbox"/> OH-2 <input type="checkbox"/> OH-1P <input type="checkbox"/> OTHER	LOCAL INFORMATION REPORTING AGENCY NAME * Clermont County Sheriff	NCIC * 01300	HIT/SKIP 1 - SOLVED 2 - UNSOLVED	NUMBER OF UNITS 2	UNIT IN ERROR 1 - FATAL 98 - ANIMAL 99 - UNKNOWN
---	---	---	-----------------	--	----------------------	---

COUNTY* 13	LOCALITY* 3 - TOWNSHIP	LOCATION: CITY, VILLAGE, TOWNSHIP* Batavia	CRASH DATE / TIME* 07/14/2021 16:40	CRASH SEVERITY 5 - SERIOUS INJURY SUSPECTED
---------------	---------------------------	---	--	--

ROUTE TYPE SR	ROUTE NUMBER 125	PREFIX 1 - NORTH 2 - SOUTH 3 - EAST 4 - WEST	LOCATION ROAD NAME Access	ROAD TYPE RD	LATITUDE DECIMAL DEGREES 39.046247	LONGITUDE DECIMAL DEGREES -84.243699
------------------	---------------------	--	------------------------------	-----------------	---------------------------------------	---

ROUTE TYPE SR	ROUTE NUMBER 125	PREFIX 1 - NORTH 2 - SOUTH 3 - EAST 4 - WEST	REFERENCE ROAD NAME (ROAD, MILEPOST, HOUSE #)	ROAD TYPE	LONGITUDE DECIMAL DEGREES -84.243699	CRASH SEVERITY 5 - PROPERTY DAMAGE ONLY
------------------	---------------------	--	---	-----------	---	--

REFERENCE POINT 1 - INTERSECTION 2 - MILE POST 3 - HOUSE #	DIRECTION FROM REFERENCE 1 - NORTH 2 - SOUTH 3 - EAST 4 - WEST	ROUTE TYPE IR - INTERSTATE ROUTE (TP) US - FEDERAL US ROUTE SR - STATE ROUTE CR - NUMBERED COUNTY ROUTE TR - NUMBERED TOWNSHIP ROUTE	ROAD TYPE AL - ALLEY AV - AVENUE BL - BOULEVARD CR - CIRCLE CT - COURT DR - DRIVE HE - HEIGHTS	ROAD TYPE HW - HIGHWAY LA - LANE MP - MILEPOST OV - OVAL PK - PARKWAY PI - PIKE PL - PLACE	ROAD TYPE RD - ROAD SQ - SQUARE ST - STREET TE - TERRACE TL - TRAIL WA - WAY	INTERSECTION RELATED <input type="checkbox"/> WITHIN INTERSECTION OR ON APPROACH <input type="checkbox"/> WITHIN INTERCHANGE AREA NUMBER OF APPROACHES
---	--	---	---	---	--	---

DISTANCE FROM REFERENCE 1 - MILES 2 - FEET 3 - YARDS	DIRECTION UNIT OF MEASURE 1 - MILES 2 - FEET 3 - YARDS	ROADWAY <input type="checkbox"/> ROADWAY DIVIDED
---	---	---

LOCATION OF FIRST HARMFUL EVENT 1 - ON ROADWAY 2 - ON SHOULDER 3 - IN MEDIAN 4 - ON ROADSIDE 5 - ON GORE 6 - OUTSIDE TRAFFIC WAY 7 - ON RAMP 8 - OFF RAMP	MANNER OF CRASH COLLISION/IMPACT 1 - NOT COLLISION BETWEEN TWO MOTOR VEHICLES IN TRANSPORT 2 - REAR-END 3 - HEAD-ON 4 - REAR-TO-REAR 5 - BACKING 6 - ANGLE 7 - SIDESWIPE, SAME DIRECTION 8 - SIDESWIPE, OPPOSITE DIRECTION 9 - OTHER / UNKNOWN	DIRECTION OF TRAVEL 1 - NORTH 2 - SOUTH 3 - EAST 4 - WEST	MEDIAN TYPE 1 - DIVIDED FLUSH MEDIAN (<4 FEET) 2 - DIVIDED FLUSH MEDIAN (≥4 FEET) 3 - DIVIDED, DEPRESSED MEDIAN 4 - DIVIDED, RAISED MEDIAN (ANY TYPE) 9 - OTHER / UNKNOWN
---	---	---	--

<input type="checkbox"/> WORK ZONE RELATED <input type="checkbox"/> WORKERS PRESENT <input type="checkbox"/> LAW ENFORCEMENT PRESENT <input type="checkbox"/> ACTIVE SCHOOL ZONE	WORK ZONE TYPE 1 - LANE CLOSURE 2 - LANE SHIFT/ CROSSOVER 3 - WORK ON SHOULDER OR MEDIAN 4 - INTERMITTENT OR MOVING WORK 5 - OTHER	LOCATION OF CRASH IN WORK ZONE 1 - BEFORE THE 1ST WORK ZONE WARNING SIGN 2 - ADVANCE WARNING AREA 3 - TRANSITION AREA 4 - ACTIVITY AREA 5 - TERMINATION AREA	CONTOUR 1 - STRAIGHT LEVEL 2 - STRAIGHT GRADE 3 - CURVE LEVEL 4 - CURVE GRADE 9 - OTHER / UNKNOWN	CONDITIONS 1 - DRY 2 - WET 3 - SNOW 4 - ICE 5 - SAND, MUD, DIRT, OIL, GRAVEL 6 - WATER (STANDING, MOVING) 7 - SLUSH 9 - OTHER / UNKNOWN	SURFACE 1 - CONCRETE 2 - BLACKTOP, BITUMINOUS, ASPHALT 3 - BRICK/BLOCK 4 - SLAG, GRAVEL, STONE 5 - DIRT 9 - OTHER / UNKNOWN
---	---	---	--	---	---

LIGHT CONDITION 1 - DAYLIGHT 2 - DAWN/DUSK 3 - DARK - LIGHTED ROADWAY 4 - DARK - ROADWAY NOT LIGHTED 5 - DARK - UNKNOWN ROADWAY LIGHTING 9 - OTHER / UNKNOWN	WEATHER 1 - CLEAR 2 - CLOUDY 3 - FOG, SMOG, SMOKE 4 - RAIN 5 - SLEET, HAIL 6 - SNOW 7 - SEVERE CROSSWINDS 8 - BLOWING SAND, SOIL, DIRT, SNOW 9 - FREEZING RAIN OR FREEZING DRIZZLE 99 - OTHER / UNKNOWN
--	---

NARRATIVE  
 Unit #2 was sitting at the light waiting to turn when unit #1 struck the rear of unit #2 causing minor damage.

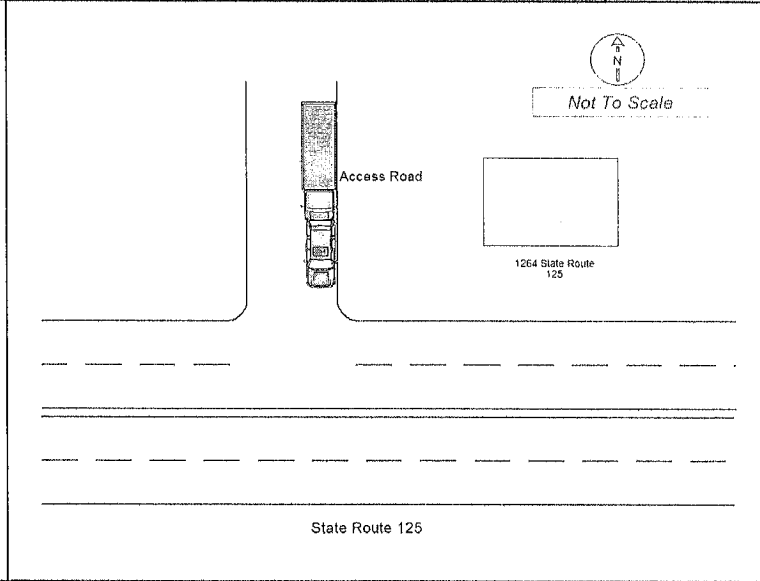

CRASH REPORTED DATE / TIME 07/14/2021 16:40	DISPATCH DATE / TIME 07/14/2021 16:47	ARRIVAL DATE / TIME 07/14/2021 16:58	SCENE CLEARED DATE / TIME 07/14/2021 17:31	REPORT TAKEN BY <input checked="" type="checkbox"/> POLICE AGENCY <input type="checkbox"/> MOTORIST
TOTAL TIME ROADWAY CLOSED	OTHER INVESTIGATION TIME	TOTAL MINUTES 44	OFFICER'S NAME* Rudd, Jeffrey	CHECKED BY OFFICER'S NAME* Scott, D
			OFFICER'S BADGE NUMBER* R3052	CHECKED BY OFFICER'S BADGE NUMBER* R2367

SUPPLEMENT  
 (CORRECTION OR ADDITION TO AN EXISTING REPORT SENT TO ODPS)

**UNIT #** 1 **OWNER NAME:** LAST, FIRST, MIDDLE (☐ SAME AS DRIVER) U-HAUL U-HAUL  
**OWNER ADDRESS:** STREET, CITY, STATE, ZIP (☐ SAME AS DRIVER) 2727 N. CENTRAL AVE., PHOENIX, AZ, 85001  
**COMMERCIAL CARRIER:** NAME, ADDRESS, CITY, STATE, ZIP **OWNER PHONE:** INCLUDE AREA CODE (☐ SAME AS DRIVER)

**LP STATE** AZ **LICENSE PLATE #** AJ39579 **VEHICLE IDENTIFICATION #** 1FDNF6C42KDB91274 **VEHICLE YEAR** 2019 **VEHICLE MAKE** FORD  
 **INSURANCE VERIFIED** **INSURANCE COMPANY** CANADA NON RESIDENT **INSURANCE POLICY #** CA13 **COLOR** WHI **VEHICLE MODEL** F-650  
**TYPE OF USE**  COMMERCIAL  GOVERNMENT  IN EMERGENCY RESPONSE **US DOT #** **TOWED BY:** COMPANY NAME  
 **INTERLOCK DEVICE EQUIPPED**  **HIT/SKIP UNIT** **# OCCUPANTS** 1 **VEHICLE WEIGHT GVWR/GCWR** 1 - ≤ 10K LBS. 2 - 10,001 - 26K LBS. 3 - > 26K LBS. **HAZARDOUS MATERIAL**  MATERIAL  RELEASED  PLACARD **CLASS #** **PLACARD ID #**

**UNIT TYPE** 14  
 1 - PASSENGER CAR 6 - VAN (9-15 SEATS) 12 - GOLF CART 18 - LIMO (LIVERY VEHICLE) 23 - PEDESTRIAN/SKATER  
 2 - PASSENGER VAN (MINIVAN) 7 - MOTORCYCLE 2-WHEELED 13 - SNOWMOBILE 19 - BUS (16+ PASSENGERS) 24 - WHEELCHAIR (ANY TYPE)  
 3 - SPORT UTILITY VEHICLE 8 - MOTORCYCLE 3-WHEELED 14 - SINGLE UNIT TRUCK 20 - OTHER VEHICLE 25 - OTHER NON-MOTORIST  
 4 - PICK UP 9 - AUTOCYCLE 15 - SEMI-TRACTOR 21 - HEAVY EQUIPMENT 26 - BICYCLE  
 5 - CARGO VAN 10 - MOPED OR MOTORIZED BICYCLE 16 - FARM EQUIPMENT 22 - ANIMAL WITH RIDER OR ANIMAL-DRAWN VEHICLE 27 - TRAIN  
 11 - ALL TERRAIN VEHICLE (ATV/UTV) 17 - MOTORHOME 99 - UNKNOWN OR HIT/SKIP  
**# OF TRAILING UNITS**

**WAS VEHICLE OPERATING IN AUTONOMOUS MODE WHEN CRASH OCCURRED?** 2  
 0 - NO AUTOMATION 3 - CONDITIONAL AUTOMATION 9 - UNKNOWN  
 1 - DRIVER ASSISTANCE 4 - HIGH AUTOMATION  
 1 - YES 2 - NO 9 - OTHER / UNKNOWN **AUTONOMOUS MODE LEVEL** 2 - PARTIAL AUTOMATION 5 - FULL AUTOMATION

**SPECIAL FUNCTION** 1  
 1 - NONE 6 - BUS - CHARTER/TOUR 11 - FIRE 16 - FARM 21 - MAIL CARRIER  
 2 - TAXI 7 - BUS - INTERCITY 12 - MILITARY 17 - MOWING 99 - OTHER / UNKNOWN  
 3 - ELECTRONIC RIDE SHARING 8 - BUS - SHUTTLE 13 - POLICE 18 - SNOW REMOVAL  
 4 - SCHOOL TRANSPORT 9 - BUS - OTHER 14 - PUBLIC UTILITY 19 - TOWING  
 5 - BUS - TRANSIT/COMMUTER 10 - AMBULANCE 15 - CONSTRUCTION EQUIP. 20 - SAFETY SERVICE PATROL

**CARGO BODY TYPE** 5  
 1 - NO CARGO BODY TYPE / NOT APPLICABLE 4 - LOGGING 7 - GRAIN/CHIPS/GRAVEL 11 - DUMP 99 - OTHER / UNKNOWN  
 2 - BUS 5 - INTERMODAL CONTAINER CHASSIS 8 - POLE 12 - CONCRETE MIXER  
 3 - VEHICLE TOWING ANOTHER MOTOR VEHICLE 6 - CARGOVAN /ENCLOSED BOX 9 - CARGO TANK 13 - AUTO TRANSPORTER  
 10 - FLAT BED 14 - GARBAGE/REFUSE

**VEHICLE DEFECTS**  
 1 - TURN SIGNALS 4 - BRAKES 7 - WORN OR SLICK TIRES 9 - MOTOR TROUBLE 99 - OTHER / UNKNOWN  
 2 - HEAD LAMPS 5 - STEERING 8 - TRAILER EQUIPMENT DEFECTIVE 10 - DISABLED FROM PRIOR ACCIDENT  
 3 - TAIL LAMPS 6 - TIRE BLOWOUT

**NON-MOTORIST LOCATION AT IMPACT**  
 1 - INTERSECTION - MARKED CROSSWALK 4 - MIDBLOCK - MARKED CROSSWALK 7 - SHOULDER/ROADSIDE 10 - DRIVEWAY ACCESS 99 - OTHER / UNKNOWN  
 2 - INTERSECTION - UNMARKED CROSSWALK 5 - TRAVEL LANE - OTHER LOCATION 8 - SIDEWALK 11 - SHARED USE PATHS OR TRAILS  
 3 - INTERSECTION - OTHER 6 - BICYCLE LANE 9 - MEDIAN/CROSSING ISLAND 12 - FIRST RESPONDER AT INCIDENT SCENE

**ACTION** 3 **PRE-CRASH ACTIONS** 1  
 1 - NON-CONTACT 2 - NON-COLLISION 3 - CHANGING LANES 4 - OVERTAKING/PASSING 5 - MAKING RIGHT TURN 6 - MAKING LEFT TURN 7 - MAKING U-TURN 8 - ENTERING TRAFFIC LANE 9 - OTHER / UNKNOWN  
 10 - PARKED 11 - STOPPED OR STOPPED IN TRAFFIC 12 - DRIVERLESS 13 - NEGOTIATING A CURVE 14 - ENTERING OR CROSSING SPECIFIED LOCATION  
 15 - WALKING, RUNNING, JOGGING, PLAYING 16 - WORKING 17 - PUSHING VEHICLE 18 - APPROACHING OR LEAVING VEHICLE 19 - STANDING 20 - OTHER NON-MOTORIST  
 21 - STANDING OUTSIDE DISABLED VEHICLE 99 - OTHER / UNKNOWN

**CONTRIBUTING CIRCUMSTANCES** 8  
 1 - NONE 8 - FOLLOWING TOO CLOSE /ACDA 13 - IMPROPER START FROM A PARKED POSITION 18 - OPERATING DEFECTIVE EQUIPMENT 23 - OPENING DOOR INTO ROADWAY  
 2 - FAILURE TO YIELD 9 - IMPROPER LANE CHANGE 14 - STOPPED OR PARKED ILLEGALLY 19 - LOAD SHIFTING /FALLING/SPILLING 99 - OTHER IMPROPER ACTION  
 3 - RAN RED LIGHT 10 - IMPROPER PASSING 15 - SWERVING TO AVOID 20 - IMPROPER CROSSING 21 - LYING IN ROADWAY  
 4 - RAN STOP SIGN 11 - DROVE OFF ROAD 16 - WRONG WAY 22 - NOT DISCERNIBLE  
 5 - UNSAFE SPEED 12 - IMPROPER BACKING 17 - VISION OBSTRUCTION  
 6 - IMPROPER TURN 7 - LEFT OF CENTER

**SEQUENCE OF EVENTS**  
 1 **EVENTS** 20  
 1 - OVERTURN/ROLLOVER 7 - SEPARATION OF UNITS 12 - DOWNHILL RUNAWAY 19 - ANIMAL - OTHER 23 - STRUCK BY FALLING, SHIFTING CARGO OR ANYTHING SET IN MOTION BY A MOTOR VEHICLE  
 2 - FIRE/EXPLOSION 8 - RAN OFF ROAD RIGHT 13 - OTHER NON-COLLISION 20 - MOTOR VEHICLE IN TRANSPORT 24 - OTHER MOVABLE OBJECT  
 3 - IMMERSION 9 - RAN OFF ROAD LEFT 14 - PEDESTRIAN 21 - PARKED MOTOR VEHICLE  
 4 - JACKKNIFE 10 - CROSS MEDIAN 15 - PEDALCYCLE 16 - RAILWAY VEHICLE  
 5 - CARGO / EQUIPMENT LOSS OR SHIFT 11 - CROSS CENTERLINE - OPPOSITE DIRECTION OF TRAVEL 17 - ANIMAL - FARM 18 - ANIMAL - DEER  
 6 - EQUIPMENT FAILURE

**COLLISION WITH FIXED OBJECT - STRUCK**  
 25 - IMPACT ATTENUATOR / CRASH CUSHION 31 - GUARDRAIL END 38 - OVER-HEAD SIGN POST 45 - EMBANKMENT 52 - BUILDING  
 26 - BRIDGE OVERHEAD STRUCTURE 32 - PORTABLE BARRIER 39 - LIGHT / LUMINARIES SUPPORT 46 - FENCE 53 - TUNNEL  
 27 - BRIDGE PIER OR ABUTMENT 33 - MEDIAN CABLE BARRIER 40 - UTILITY POLE 47 - MAILBOX 54 - OTHER FIXED OBJECT  
 28 - BRIDGE PARAPET 34 - MEDIAN GUARDRAIL BARRIER 41 - OTHER POST, POLE OR SUPPORT 48 - TREE 99 - OTHER / UNKNOWN  
 29 - BRIDGE RAIL 35 - MEDIAN CONCRETE BARRIER 42 - CULVERT 49 - FIRE HYDRANT 50 - WORK ZONE MAINTENANCE EQUIPMENT  
 30 - GUARDRAIL FACE 36 - MEDIAN OTHER BARRIER 43 - CURB 51 - WALL  
 37 - TRAFFIC SIGN POST 44 - DITCH

**FIRST HARMFUL EVENT** 1 **MOST HARMFUL EVENT** 1

**LOCAL REPORT NUMBER**  
002100024394

**DAMAGE**  
**DAMAGE SCALE**  
 1 - NONE 3 - FUNCTIONAL DAMAGE  
 2 - MINOR DAMAGE 4 - DISABLING DAMAGE  
 9 - UNKNOWN

**DAMAGED AREA(S)**  
INDICATE ALL THAT APPLY

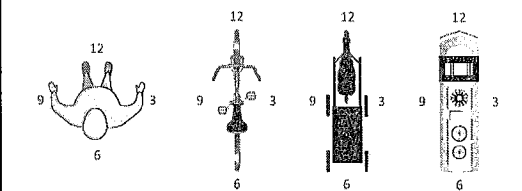
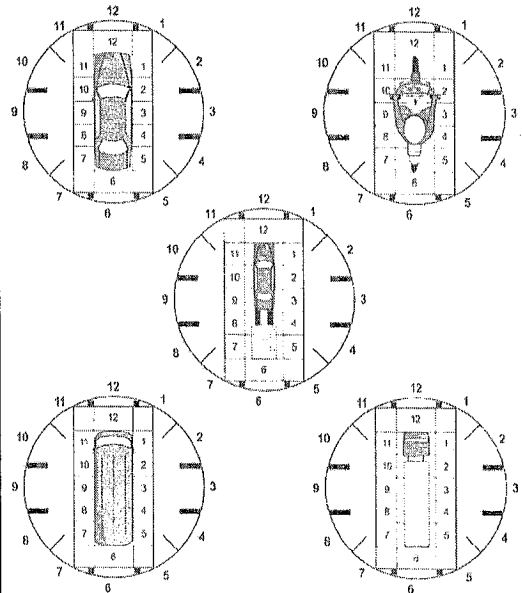

**NO DAMAGE [0]**  **UNDERCARRIAGE [14]**  
 **TOP [13]**  **ALL AREAS [15]**  
 **UNIT NOT AT SCENE [16]**

**INITIAL POINT OF CONTACT**  
 0 - NO DAMAGE 14 - UNDERCARRIAGE  
 12 1-12 - REFER TO UNIT DIAGRAM 15 - VEHICLE NOT AT SCENE  
 13 - TOP 99 - UNKNOWN

**TRAFFIC**  
**TRAFFICWAY FLOW** 2  
 1 - ONE-WAY  
 2 - TWO-WAY  
**TRAFFIC CONTROL** 2  
 1 - ROUNDABOUT 4 - STOP SIGN  
 2 - SIGNAL 5 - YIELD SIGN  
 3 - FLASHER 6 - NO CONTROL

**# OF THROUGH LANES ON ROAD** 2 **RAIL GRADE CROSSING** 1  
 1 - NOT INVOLVED  
 2 - INVOLVED-ACTIVE CROSSING  
 3 - INVOLVED-PASSIVE CROSSING

**UNIT / NON-MOTORIST DIRECTION**  
 FROM 1 TO 2  
 1 - NORTH 5 - NORTHEAST  
 2 - SOUTH 6 - NORTHWEST  
 3 - EAST 7 - SOUTHEAST  
 4 - WEST 8 - SOUTHWEST  
 9 - OTHER / UNKNOWN

**UNIT SPEED** 5 **DETECTED SPEED**  
 1 - STATED / ESTIMATED SPEED

**POSTED SPEED** 25 **DETECTED SPEED** 1  
 2 - CALCULATED / EDR  
 3 - UNDETERMINED

OWNER

VEHICLE

EVENTS

<b>UNIT #</b> 2	<b>OWNER NAME:</b> LAST, FIRST, MIDDLE ( <input type="checkbox"/> SAME AS DRIVER ) FRANKENHOFF, KIMBERLY	<b>OWNER PHONE:</b> INCLUDE AREA CODE ( <input type="checkbox"/> SAME AS DRIVER ) [REDACTED]
<b>OWNER ADDRESS:</b> STREET, CITY, STATE, ZIP ( <input type="checkbox"/> SAME AS DRIVER ) 15 WOODED RIDGE ROAD, AMELIA, OH, 45102		
<b>COMMERCIAL CARRIER:</b> NAME, ADDRESS, CITY, STATE, ZIP		<b>COMMERCIAL CARRIER PHONE:</b> INCLUDE AREA CODE

<b>LP STATE</b> OH	<b>LICENSE PLATE #</b> EYT8019	<b>VEHICLE IDENTIFICATION #</b> 5N1AT2MV9GC853482	<b>VEHICLE YEAR</b> 2016	<b>VEHICLE MAKE</b> NISSAN
<input checked="" type="checkbox"/> <b>INSURANCE VERIFIED</b>	<b>INSURANCE COMPANY</b> ALLSTATE	<b>INSURANCE POLICY #</b> 826338926	<b>COLOR</b> BLU	<b>VEHICLE MODEL</b> ROGUE
<input type="checkbox"/> <b>COMMERCIAL</b> <input type="checkbox"/> <b>GOVERNMENT</b> <input type="checkbox"/> <b>IN EMERGENCY RESPONSE</b>		<b>US DOT #</b>	<b>TOWED BY:</b> COMPANY NAME	
<input type="checkbox"/> <b>INTERLOCK DEVICE EQUIPPED</b> <input type="checkbox"/> <b>HIT/SKIP UNIT</b>		<b>VEHICLE WEIGHT GVWR/GCWR</b> 1 - ≤10K LBS. 2 - 10.001 - 26K LBS. 3 - > 26K LBS.	<b>HAZARDOUS MATERIAL CLASS #</b> <b>PLACARD ID #</b>	

<b>UNIT TYPE</b> 3	1 - PASSENGER CAR (MINIVAN) 2 - PASSENGER VAN (MINIVAN) 3 - SPORT UTILITY VEHICLE 4 - PICK UP 5 - CARGO VAN	6 - VAN (9-15 SEATS) 7 - MOTORCYCLE 2-WHEELED 8 - MOTORCYCLE 3-WHEELED 9 - AUTOCYCLE 10 - MOPED OR MOTORIZED BICYCLE 11 - ALL TERRAIN VEHICLE (ATV/UTV)	12 - GOLF CART 13 - SNOWMOBILE 14 - SINGLE UNIT TRUCK 15 - SEMI-TRACTOR 16 - FARM EQUIPMENT 17 - MOTORHOME	18 - LIMO (LIVERY VEHICLE) 19 - BUS (16+ PASSENGERS) 20 - OTHER VEHICLE 21 - HEAVY EQUIPMENT 22 - ANIMAL WITH RIDER OR ANIMAL-DRAWN VEHICLE	23 - PEDESTRIAN/SKATER 24 - WHEELCHAIR (ANY TYPE) 25 - OTHER NON-MOTORIST 26 - BICYCLE 27 - TRAIN 99 - UNKNOWN OR HIT/SKIP
<b># of TRAILING UNITS</b>					

<b>WAS VEHICLE OPERATING IN AUTONOMOUS MODE WHEN CRASH OCCURRED?</b> 2	1 - YES    2 - NO    9 - OTHER / UNKNOWN	<b>AUTONOMOUS MODE LEVEL</b> 0	0 - NO AUTOMATION 1 - DRIVER ASSISTANCE 2 - PARTIAL AUTOMATION 3 - CONDITIONAL AUTOMATION 4 - HIGH AUTOMATION 5 - FULL AUTOMATION 9 - UNKNOWN
---	--	-----------------------------------	---

<b>SPECIAL FUNCTION</b> 1	1 - NONE 2 - TAXI 3 - ELECTRONIC RIDE SHARING 4 - SCHOOL TRANSPORT 5 - BUS - TRANSIT/COMMUTER	6 - BUS - CHARTER/TOUR 7 - BUS - INTERCITY 8 - BUS - SHUTTLE 9 - BUS - OTHER 10 - AMBULANCE	11 - FIRE 12 - MILITARY 13 - POLICE 14 - PUBLIC UTILITY 15 - CONSTRUCTION EQUIP.	16 - FARM 17 - MOWING 18 - SNOW REMOVAL 19 - TOWING 20 - SAFETY SERVICE PATROL	21 - MAIL CARRIER 99 - OTHER / UNKNOWN
------------------------------	---	---	--	--	---

<b>CARGO BODY TYPE</b> 1	1 - NO CARGO BODY TYPE / NOT APPLICABLE 2 - BUS 3 - VEHICLE TOWING ANOTHER MOTOR VEHICLE	4 - LOGGING 5 - INTERMODAL CONTAINER CHASSIS 6 - CARGOVAN /ENCLOSED BOX	7 - GRAIN/CHIPS/GRAVEL 8 - POLE 9 - CARGO TANK 10 - FLAT BED	11 - DUMP 12 - CONCRETE MIXER 13 - AUTO TRANSPORTER 14 - GARBAGE/REFUSE	99 - OTHER / UNKNOWN
-----------------------------	--	---	---	--	----------------------

<b>VEHICLE DEFECTS</b>	1 - TURN SIGNALS 2 - HEAD LAMPS 3 - TAIL LAMPS	4 - BRAKES 5 - STEERING 6 - TIRE BLOWOUT	7 - WORN OR SLICK TIRES 8 - TRAILER EQUIPMENT DEFECTIVE	9 - MOTOR TROUBLE 10 - DISABLED FROM PRIOR ACCIDENT	99 - OTHER / UNKNOWN
------------------------	--	--	--	--	----------------------

<b>NON-MOTORIST LOCATION AT IMPACT</b>	1 - INTERSECTION - MARKED CROSSWALK 2 - INTERSECTION - UNMARKED CROSSWALK 3 - INTERSECTION - OTHER	4 - MIDBLOCK - MARKED CROSSWALK 5 - INTERSECTION - OTHER LOCATION 6 - BICYCLE LANE	7 - SHOULDER/ROADSIDE 8 - SIDEWALK 9 - MEDIAN/CROSSING ISLAND 10 - DRIVEWAY ACCESS 11 - SHARED USE PATHS OR TRAILS 12 - FIRST RESPONDER AT INCIDENT SCENE	99 - OTHER / UNKNOWN
--	--	--	--	----------------------

<b>ACTION</b> 4	1 - NON-CONTACT 2 - NON-COLLISION 3 - STRIKING 4 - STRUCK 5 - BOTH STRIKING & STRUCK 9 - OTHER / UNKNOWN	<b>PRE-CRASH ACTIONS</b> 11	1 - STRAIGHT AHEAD 2 - BACKING 3 - CHANGING LANES 4 - OVERTAKING/PASSING 5 - MAKING RIGHT TURN 6 - MAKING LEFT TURN 7 - MAKING U-TURN 8 - ENTERING TRAFFIC LANE	9 - LEAVING TRAFFIC LANE 10 - PARKED 11 - SLOWING OR STOPPED IN TRAFFIC 12 - DRIVERLESS 13 - NEGOTIATING A CURVE 14 - ENTERING OR CROSSING SPECIFIED LOCATION	15 - WALKING, RUNNING, JOGGING, PLAYING 16 - WORKING 17 - PUSHING VEHICLE 18 - APPROACHING OR LEAVING VEHICLE 19 - STANDING 20 - OTHER NON-MOTORIST	21 - STANDING OUTSIDE DISABLED VEHICLE 99 - OTHER / UNKNOWN
--------------------	---	--------------------------------	--	--	--	--

<b>CONTRIBUTING CIRCUMSTANCES</b> 1	1 - NONE 2 - FAILURE TO YIELD 3 - RAN RED LIGHT 4 - RAN STOP SIGN 5 - UNSAFE SPEED 6 - IMPROPER TURN 7 - LEFT OF CENTER	8 - FOLLOWING TOO CLOSE /ACDA 9 - IMPROPER LANE CHANGE 10 - IMPROPER PASSING 11 - DROVE OFF ROAD 12 - IMPROPER BACKING	13 - IMPROPER START FROM A PARKED POSITION 14 - STOPPED OR PARKED ILLEGALLY 15 - SWERVING TO AVOID 16 - WRONG WAY 17 - VISION OBSTRUCTION	18 - OPERATING DEFECTIVE EQUIPMENT 19 - LOAD SHIFTING /FALLING/SPILLING 20 - IMPROPER CROSSING 21 - LYING IN ROADWAY 22 - NOT DISCERNIBLE	23 - OPENING DOOR INTO ROADWAY 99 - OTHER IMPROPER ACTION
--	---	--	---	---	--

<b>SEQUENCE OF EVENTS</b>	1 [20] 2 3	1 - OVERTURN/ROLLOVER 2 - FIRE/EXPLOSION 3 - IMMERSION 4 - JACKKNIFE 5 - CARGO / EQUIPMENT LOSS OR SHIFT 6 - EQUIPMENT FAILURE	7 - SEPARATION OF UNITS 8 - RAN OFF ROAD RIGHT 9 - RAN OFF ROAD LEFT 10 - CROSS MEDIAN 11 - CROSS CENTERLINE - OPPOSITE DIRECTION OF TRAVEL	<b>EVENTS</b> 12 - DOWNHILL RUNAWAY 13 - OTHER NON-COLLISION 14 - PEDESTRIAN 15 - PEDALCYCLE 16 - RAILWAY VEHICLE 17 - ANIMAL - FARM 18 - ANIMAL - DEER	19 - ANIMAL - OTHER 20 - MOTOR VEHICLE IN TRANSPORT 21 - PARKED MOTOR VEHICLE 22 - WORK ZONE MAINTENANCE EQUIPMENT	23 - STRUCK BY FALLING, SHIFTING CARGO OR ANYTHING SET IN MOTION BY A MOTOR VEHICLE 24 - OTHER MOVABLE OBJECT
---------------------------	------------------	---	---	--	---	--

<b>COLLISION WITH FIXED OBJECT - STRUCK</b>					
4	25 - IMPACT ATTENUATOR / CRASH CUSHION 26 - BRIDGE OVERHEAD STRUCTURE 27 - BRIDGE PIER OR ABUTMENT 28 - BRIDGE PARAPET 29 - BRIDGE RAIL 30 - GUARDRAIL FACE	31 - GUARDRAIL END 32 - PORTABLE BARRIER 33 - MEDIAN CABLE BARRIER 34 - MEDIAN GUARDRAIL BARRIER 35 - MEDIAN CONCRETE BARRIER 36 - MEDIAN OTHER BARRIER 37 - TRAFFIC SIGN POST	38 - OVERHEAD SIGN POST 39 - LIGHT / LUMINARIES SUPPORT 40 - UTILITY POLE 41 - OTHER POST, POLE OR SUPPORT 42 - CULVERT 43 - CURB 44 - DITCH	45 - EMBANKMENT 46 - FENCE 47 - MAILBOX 48 - TREE 49 - FIRE HYDRANT 50 - WORK ZONE MAINTENANCE EQUIPMENT 51 - WALL	52 - BUILDING 53 - TUNNEL 54 - OTHER FIXED OBJECT 99 - OTHER / UNKNOWN
<b>FIRST HARMFUL EVENT</b> 1 <b>MOST HARMFUL EVENT</b> 1					

<b>DAMAGE</b>	
<b>DAMAGE SCALE</b>	
1 - NONE	3 - FUNCTIONAL DAMAGE
2 - MINOR DAMAGE	4 - DISABLING DAMAGE
9 - UNKNOWN	

**DAMAGED AREA(S)**  
INDICATE ALL THAT APPLY

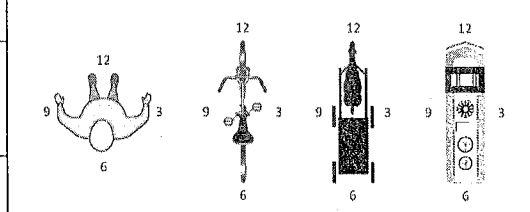
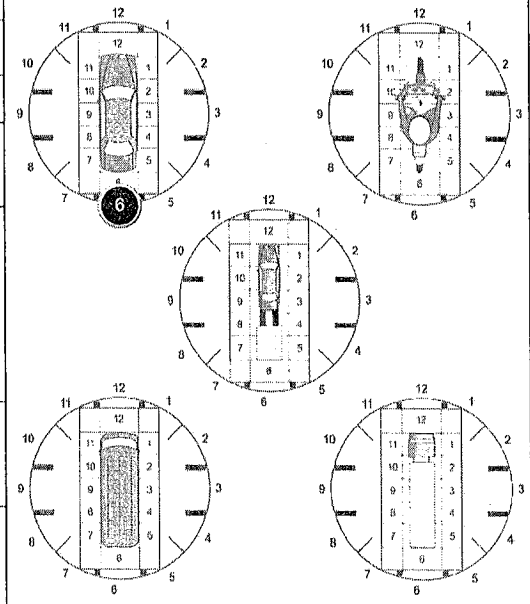

**NO DAMAGE [ 0 ]**     **UNDERCARRIAGE [ 14 ]**  
 **TOP [ 13 ]**     **ALL AREAS [ 15 ]**  
 **UNIT NOT AT SCENE [ 16 ]**

<b>INITIAL POINT OF CONTACT</b>	
0 - NO DAMAGE	14 - UNDERCARRIAGE
1-12 - REFER TO UNIT DIAGRAM	15 - VEHICLE NOT AT SCENE
99 - UNKNOWN	

<b>TRAFFIC</b>	
<b>TRAFFICWAY FLOW</b>	<b>TRAFFIC CONTROL</b>
1 - ONE-WAY 2 - TWO-WAY	1 - ROUNDABOUT    4 - STOP SIGN 2 - SIGNAL    5 - YIELD SIGN 3 - FLASHER    6 - NO CONTROL

<b># of THROUGH LANES ON ROAD</b> 2	<b>RAIL GRADE CROSSING</b> 1 - NOT INVOLVED 2 - INVOLVED-ACTIVE CROSSING 3 - INVOLVED-PASSIVE CROSSING
--	---

<b>UNIT / NON-MOTORIST DIRECTION</b>	
FROM 1 TO 2	1 - NORTH    5 - NORTHEAST 2 - SOUTH    6 - NORTHWEST 3 - EAST    7 - SOUTHEAST 4 - WEST    8 - SOUTHWEST 9 - OTHER / UNKNOWN

<b>UNIT SPEED</b> 0	<b>DETECTED SPEED</b> 1 - STATED / ESTIMATED SPEED
<b>POSTED SPEED</b> 25	2 - CALCULATED / EDR 3 - UNDETERMINED



# MOTORIST / Non-MOTORIST

LOCAL REPORT NUMBER

002100024394

UNIT # 1	NAME: LAST, FIRST, MIDDLE HENSON, JOE, M				DATE OF BIRTH 07/23/1964		AGE 56	GENDER M				
ADDRESS: STREET, CITY, STATE, ZIP 912 E. CHESTNUT ST. APT. A, LANCASTER, OH, 43130					CONTACT PHONE - INCLUDE AREA CODE [REDACTED]							
INJURIES 5	INJURED TAKEN BY 1	EMS AGENCY (NAME)		INJURED TAKEN TO: MEDICAL FACILITY (NAME, CITY)		SAFETY EQUIPMENT USED 4		<input type="checkbox"/> DOT-COMPLIANT <input type="checkbox"/> MC HELMET	SEATING POSITION 1	AIR BAG USAGE 1	EJECTION 1	TRAPPED 1
OL STATE OH	OPERATOR LICENSE NUMBER			OFFENSE CHARGED		LOCAL CODE <input type="checkbox"/>	OFFENSE DESCRIPTION			CITATION NUMBER		
OL CLASS 4	ENDORSEMENT	RESTRICTION SELECT UP TO 3		DRIVER DISTRACTED BY 1	ALCOHOL / DRUG SUSPECTED <input type="checkbox"/> ALCOHOL <input type="checkbox"/> MARIJUANA <input type="checkbox"/> OTHER DRUG		CONDITION 1		ALCOHOL TEST STATUS: 1, TYPE: 1, VALUE:		DRUG TEST(S) STATUS: 1, TYPE: 1, RESULTS SELECT UP TO 4	

UNIT # 2	NAME: LAST, FIRST, MIDDLE FRANKENHOFF, KIMBERLY				DATE OF BIRTH 08/20/1976		AGE 44	GENDER F				
ADDRESS: STREET, CITY, STATE, ZIP 15 WOODED RIDGE ROAD, AMELIA, OH, 45102					CONTACT PHONE - INCLUDE AREA CODE [REDACTED]							
INJURIES 5	INJURED TAKEN BY 1	EMS AGENCY (NAME)		INJURED TAKEN TO: MEDICAL FACILITY (NAME, CITY)		SAFETY EQUIPMENT USED 4		<input type="checkbox"/> DOT-COMPLIANT <input type="checkbox"/> MC HELMET	SEATING POSITION 1	AIR BAG USAGE 1	EJECTION 1	TRAPPED 1
OL STATE OH	OPERATOR LICENSE NUMBER			OFFENSE CHARGED		LOCAL CODE <input type="checkbox"/>	OFFENSE DESCRIPTION			CITATION NUMBER		
OL CLASS 4	ENDORSEMENT	RESTRICTION SELECT UP TO 3		DRIVER DISTRACTED BY 1	ALCOHOL / DRUG SUSPECTED <input type="checkbox"/> ALCOHOL <input type="checkbox"/> MARIJUANA <input type="checkbox"/> OTHER DRUG		CONDITION 1		ALCOHOL TEST STATUS: 1, TYPE: 1, VALUE:		DRUG TEST(S) STATUS: 1, TYPE: 1, RESULTS SELECT UP TO 4	

UNIT #	NAME: LAST, FIRST, MIDDLE				DATE OF BIRTH		AGE	GENDER				
ADDRESS: STREET, CITY, STATE, ZIP					CONTACT PHONE - INCLUDE AREA CODE							
INJURIES	INJURED TAKEN BY	EMS AGENCY (NAME)		INJURED TAKEN TO: MEDICAL FACILITY (NAME, CITY)		SAFETY EQUIPMENT USED		<input type="checkbox"/> DOT-COMPLIANT <input type="checkbox"/> MC HELMET	SEATING POSITION	AIR BAG USAGE	EJECTION	TRAPPED
OL STATE	OPERATOR LICENSE NUMBER			OFFENSE CHARGED		LOCAL CODE <input type="checkbox"/>	OFFENSE DESCRIPTION			CITATION NUMBER		
OL CLASS	ENDORSEMENT	RESTRICTION SELECT UP TO 3		DRIVER DISTRACTED BY	ALCOHOL / DRUG SUSPECTED <input type="checkbox"/> ALCOHOL <input type="checkbox"/> MARIJUANA <input type="checkbox"/> OTHER DRUG		CONDITION		ALCOHOL TEST STATUS: 1, TYPE: 1, VALUE:		DRUG TEST(S) STATUS: 1, TYPE: 1, RESULTS SELECT UP TO 4	

INJURIES	SEATING POSITION	AIR BAG	OL CLASS	OL RESTRICTION(S)	DRIVER DISTRACTION	TEST STATUS
1 - FATAL	1 - FRONT - LEFT SIDE (MOTORCYCLE DRIVER)	1 - NOT DEPLOYED	1 - CLASS A	1 - ALCOHOL INTERLOCK DEVICE	1 - NOT DISTRACTED	1 - NONE GIVEN
2 - SUSPECTED SERIOUS INJURY	2 - FRONT - MIDDLE	2 - DEPLOYED FRONT	2 - CLASS B	2 - CDL INTRASTATE ONLY	2 - MANUALLY OPERATING AN ELECTRONIC COMMUNICATION DEVICE (TEXTING, TYPING, DJAI ING)	2 - TEST REFUSED
3 - SUSPECTED MINOR INJURY	3 - FRONT - RIGHT SIDE	3 - DEPLOYED SIDE	3 - CLASS C	3 - CORRECTIVE LENSES	3 - TALKING ON HANDS-FREE COMMUNICATION DEVICE	3 - TEST GIVEN, CONTAMINATED SAMPLE / UNUSABLE
4 - POSSIBLE INJURY	4 - SECOND - LEFT SIDE (MOTORCYCLE PASSENGER)	4 - DEPLOYED BOTH FRONT/SIDE	4 - REGULAR CLASS (OHIO = D)	4 - FARM WAIVER	4 - TALKING ON HAND-HELD COMMUNICATION DEVICE	4 - TEST GIVEN, RESULTS KNOWN
5 - NO APPARENT INJURY	5 - SECOND - MIDDLE	5 - NOT APPLICABLE	5 - M/C MOPED ONLY	5 - EXCEPT CLASS A & CLASS B BUS	5 - OTHER ACTIVITY WITH AN ELECTRONIC DEVICE	5 - TEST GIVEN, RESULTS UNKNOWN
	6 - SECOND - RIGHT SIDE	9 - DEPLOYMENT UNKNOWN	6 - NO VALID OL	6 - EXCEPT CLASS A & CLASS B BUS	6 - PASSENGER	<b>ALCOHOL TEST TYPE</b>
	7 - THIRD - LEFT SIDE (MOTORCYCLE SIDE CAR)	<b>EJECTION</b>		7 - EXCEPT TRACTOR-TRAILER	7 - OTHER DISTRACTION INSIDE THE VEHICLE	1 - NONE
	8 - THIRD - MIDDLE	1 - NOT EJECTED	<b>OL ENDORSEMENT</b>	8 - INTERMEDIATE LICENSE RESTRICTIONS	8 - OTHER DISTRACTION OUTSIDE THE VEHICLE	2 - BLOOD
	9 - THIRD - RIGHT SIDE	2 - PARTIALLY EJECTED	H - HAZMAT	9 - LEARNER'S PERMIT RESTRICTIONS	9 - OTHER / UNKNOWN	3 - URINE
	10 - SLEEPER SECTION OF TRUCK CAB	3 - TOTALLY EJECTED	M - MOTORCYCLE	10 - LIMITED TO DAYLIGHT ONLY	<b>CONDITION</b>	4 - BREATH
	11 - PASSENGER IN OTHER ENCLOSED CARGO AREA (NON-TRAILING UNIT, BUS, PICK-UP WITH CAP)	4 - NOT APPLICABLE	P - PASSENGER	11 - LIMITED TO EMPLOYMENT	1 - APPARENTLY NORMAL	5 - OTHER
	12 - PASSENGER IN UNENCLOSED CARGO AREA	<b>TRAPPED</b>	N - TANKER	12 - LIMITED - OTHER	2 - PHYSICAL IMPAIRMENT	<b>DRUG TEST TYPE</b>
	13 - TRAILING UNIT	1 - NOT TRAPPED	Q - MOTOR SCOOTER	13 - MECHANICAL DEVICES (SPECIAL BRAKES, HAND CONTROLS, OR OTHER ADAPTIVE DEVICES)	3 - EMOTIONAL (E.G., DEPRESSED, ANGRY, DISTURBED)	1 - NONE
	14 - RIDING ON VEHICLE EXTERIOR (NON-TRAILING UNIT)	2 - EXTRICATED BY MECHANICAL MEANS	R - THREE-WHEEL MOTORCYCLE	14 - MILITARY VEHICLES ONLY	4 - ILLNESS	2 - BLOOD
	15 - NON-MOTORIST	3 - FREED BY NON-MECHANICAL MEANS	S - SCHOOL BUS	15 - MOTOR VEHICLES WITHOUT AIR BRAKES	5 - FELL ASLEEP, FAINTED, FATIGUED, ETC.	3 - URINE
	99 - OTHER / UNKNOWN		T - DOUBLE & TRIPLE TRAILERS	16 - OUTSIDE MIRROR	6 - UNDER THE INFLUENCE OF MEDICATIONS / DRUGS / ALCOHOL	4 - OTHER
			X - TANKER / HAZMAT	17 - PROSTHETIC AID	9 - OTHER / UNKNOWN	<b>DRUG TEST RESULT(S)</b>
			<b>GENDER</b>	18 - OTHER		1 - AMPHETAMINES
			F - FEMALE			2 - BARBITURATES
			M - MALE			3 - BENZODIAZEPINES
			U - OTHER / UNKNOWN			4 - CANNABINOIDS
						5 - COCAINE
						6 - OPIATES / OPIOIDS
						7 - OTHER
						8 - NEGATIVE RESULTS



# OCCUPANT / WITNESS ADDENDUM

LOCAL REPORT NUMBER  
002100024394

<b>OCCUPANT</b>	UNIT #	NAME: LAST, FIRST, MIDDLE				DATE OF BIRTH		AGE	GENDER	
	1	GORDON, BRADLEY, M				01/25/1984		37	M	
	ADDRESS: STREET, CITY, STATE, ZIP					CONTACT PHONE - INCLUDE AREA CODE				
1921 10TH AVE., HUNTINGTON, WV, 25701					[REDACTED]					
INJURIES	INJURED TAKEN BY	EMS AGENCY (NAME)	INJURED TAKEN TO: MEDICAL FACILITY (NAME, CITY)	SAFETY EQUIPMENT		SEATING POSITION	AIR BAG USAGE	EJECTION	TRAPPED	
5	1			4		3	1	1	1	
					<input type="checkbox"/> DOT-COMPLIANT MC HELMET					

<b>OCCUPANT</b>	UNIT #	NAME: LAST, FIRST, MIDDLE				DATE OF BIRTH		AGE	GENDER	
	2	PHILHOWER, BROOKLYN				07/03/2014		7	F	
	ADDRESS: STREET, CITY, STATE, ZIP					CONTACT PHONE - INCLUDE AREA CODE				
15 WOODED RIDGE ROAD, AMELIA, OH, 45102					[REDACTED]					
INJURIES	INJURED TAKEN BY	EMS AGENCY (NAME)	INJURED TAKEN TO: MEDICAL FACILITY (NAME, CITY)	SAFETY EQUIPMENT		SEATING POSITION	AIR BAG USAGE	EJECTION	TRAPPED	
5	1			7		4	1	1	1	
					<input type="checkbox"/> DOT-COMPLIANT MC HELMET					

<b>OCCUPANT</b>	UNIT #	NAME: LAST, FIRST, MIDDLE				DATE OF BIRTH		AGE	GENDER	
	ADDRESS: STREET, CITY, STATE, ZIP					CONTACT PHONE - INCLUDE AREA CODE				
INJURIES	INJURED TAKEN BY	EMS AGENCY (NAME)	INJURED TAKEN TO: MEDICAL FACILITY (NAME, CITY)	SAFETY EQUIPMENT		SEATING POSITION	AIR BAG USAGE	EJECTION	TRAPPED	
					<input type="checkbox"/> DOT-COMPLIANT MC HELMET					

<b>OCCUPANT</b>	UNIT #	NAME: LAST, FIRST, MIDDLE				DATE OF BIRTH		AGE	GENDER	
	ADDRESS: STREET, CITY, STATE, ZIP					CONTACT PHONE - INCLUDE AREA CODE				
INJURIES	INJURED TAKEN BY	EMS AGENCY (NAME)	INJURED TAKEN TO: MEDICAL FACILITY (NAME, CITY)	SAFETY EQUIPMENT		SEATING POSITION	AIR BAG USAGE	EJECTION	TRAPPED	
					<input type="checkbox"/> DOT-COMPLIANT MC HELMET					

INJURIES	SAFETY EQUIPMENT USED	SEATING POSITION	AIR BAG USAGE
1 - FATAL	1 - NONE USED - VEHICLE OCCUPANT	1 - FRONT - LEFT SIDE (MOTORCYCLE DRIVER)	1 - NOT DEPLOYED
2 - SUSPECTED SERIOUS INJURY	2 - SHOULDER BELT ONLY USED	2 - FRONT - MIDDLE	2 - DEPLOYED FRONT
3 - SUSPECTED MINOR INJURY	3 - LAP BELT ONLY USED	3 - FRONT - RIGHT SIDE	3 - DEPLOYED SIDE
4 - POSSIBLE INJURY	4 - SHOULDER & LAP BELT USED	4 - SECOND - LEFT SIDE (MOTORCYCLE PASSENGER)	4 - DEPLOYED BOTH FRONT/SIDE
5 - NO APPARENT INJURY	5 - CHILD RESTRAINT SYSTEM - FORWARD FACING	5 - SECOND - MIDDLE	5 - NOT APPLICABLE
	6 - CHILD RESTRAINT SYSTEM - REAR FACING	6 - SECOND - RIGHT SIDE	9 - DEPLOYMENT UNKNOWN
	7 - BOOSTER SEAT	7 - THIRD - LEFT SIDE (MOTORCYCLE SIDE CAR)	
	8 - HELMET USED	8 - THIRD - MIDDLE	
	9 - PROTECTIVE PADS USED (ELBOWS, KNEES, ETC)	9 - THIRD - RIGHT SIDE	
	10 - REFLECTIVE CLOTHING	10 - SLEEPER SECTION OF TRUCK CAB	
	11 - LIGHTING - PEDESTRIAN / BICYCLE ONLY	11 - PASSENGER IN OTHER ENCLOSED CARGO AREA (NON-TRAILING UNIT SUCH AS A BUS, PICK-UP WITH CAP)	
	99 - OTHER / UNKNOWN	12 - PASSENGER IN UNENCLOSED CARGO AREA	
		13 - TRAILING UNIT	
		14 - RIDING ON VEHICLE EXTERIOR (NON-TRAILING UNIT)	
		15 - NON-MOTORIST	
		99 - OTHER / UNKNOWN	

<b>WITNESS</b>	NAME: LAST, FIRST, MIDDLE	DATE OF BIRTH		AGE	GENDER
	ADDRESS: STREET, CITY, STATE, ZIP	CONTACT PHONE - INCLUDE AREA CODE			
<b>WITNESS</b>	NAME: LAST, FIRST, MIDDLE	DATE OF BIRTH		AGE	GENDER
	ADDRESS: STREET, CITY, STATE, ZIP	CONTACT PHONE - INCLUDE AREA CODE			
<b>WITNESS</b>	NAME: LAST, FIRST, MIDDLE	DATE OF BIRTH		AGE	GENDER
	ADDRESS: STREET, CITY, STATE, ZIP	CONTACT PHONE - INCLUDE AREA CODE			

OHIO TRAFFIC ACCIDENT - OH2 DIAGRAM

LOCAL REPORT NUMBER <b>002100024394</b>	REPORTING AGENCY <b>Clermont County Sheriff</b>	Date Of Crash <b>07/14/2021</b>
IN COUNTY OF <b>Clermont County</b>	ACCIDENT LOCATION <b>Access</b>	

