

# TRAFFIC CRASH REPORT

\*DENOTES MANDATORY FIELD FOR SUPPLEMENT REPORT

LOCAL REPORT NUMBER \*

000230005843

<input checked="" type="checkbox"/> PHOTOS TAKEN <input type="checkbox"/> SECONDARY CRASH <input checked="" type="checkbox"/> PRIVATE PROPERTY		LOCAL INFORMATION REPORTING AGENCY NAME * Clermont County Sheriff		NCIC * 01300		HIT/SKIP 1 - SOLVED 2 - UNSOLVED	NUMBER OF UNITS 2	UNIT IN ERROR 98 - ANIMAL 99 - UNKNOWN
COUNTY* 13	LOCALITY* 1 - CITY 2 - VILLAGE 3 - TOWNSHIP 3	LOCATION: CITY, VILLAGE, TOWNSHIP* Batavia		CRASH DATE / TIME* 02/22/2023 17:35		CRASH SEVERITY 1 - FATAL 2 - SERIOUS INJURY SUSPECTED 3 - MINOR INJURY SUSPECTED 4 - INJURY POSSIBLE 5 - PROPERTY DAMAGE ONLY 5		
ROUTE TYPE LOCATION	ROUTE NUMBER	PREFIX 1 - NORTH 2 - SOUTH 3 - EAST 4 - WEST 2	LOCATION ROAD NAME Winemiller		ROAD TYPE LA	LATITUDE DECIMAL DEGREES 39.083377		LONGITUDE DECIMAL DEGREES -84.153801
ROUTE TYPE REFERENCE	ROUTE NUMBER	PREFIX 1 - NORTH 2 - SOUTH 3 - EAST 4 - WEST 1	REFERENCE ROAD NAME (ROAD, MILEPOST, HOUSE #) 2192		ROAD TYPE	LONGITUDE DECIMAL DEGREES		
REFERENCE POINT 1 - INTERSECTION 2 - MILE POST 3 - HOUSE # 3	DIRECTION FROM REFERENCE 1 - NORTH 2 - SOUTH 3 - EAST 4 - WEST 4	ROUTE TYPE IR - INTERSTATE ROUTE (TP) US - FEDERAL US ROUTE SR - STATE ROUTE CR - NUMBERED COUNTY ROUTE TR - NUMBERED TOWNSHIP ROUTE	ROAD TYPE AL - ALLEY AV - AVENUE BL - BOULEVARD CR - CIRCLE CT - COURT DR - DRIVE HE - HEIGHTS	ROAD TYPE HW - HIGHWAY LA - LANE MP - MILEPOST OV - OVAL PK - PARKWAY PI - PIKE PL - PLACE	RD - ROAD SQ - SQUARE ST - STREET TE - TERRACE TL - TRAIL WA - WAY	INTERSECTION RELATED <input type="checkbox"/> WITHIN INTERSECTION OR ON APPROACH <input type="checkbox"/> WITHIN INTERCHANGE AREA NUMBER OF APPROACHES		
DISTANCE FROM REFERENCE 10.00	DISTANCE UNIT OF MEASURE 1 - MILES 2 - FEET 3 - YARDS 2	ROUTE TYPE CR - NUMBERED COUNTY ROUTE	ROAD TYPE TR - NUMBERED TOWNSHIP ROUTE	ROAD TYPE RD - ROAD SQ - SQUARE ST - STREET TE - TERRACE TL - TRAIL WA - WAY	ROADWAY <input type="checkbox"/> ROADWAY DIVIDED			
LOCATION OF FIRST HARMFUL EVENT 1 - ON ROADWAY 2 - ON SHOULDER 3 - IN MEDIAN 4 - ON ROADSIDE 5 - ON GORE 6 - OUTSIDE TRAFFIC WAY 7 - ON RAMP 8 - OFF RAMP 99	DIRECTION FROM REFERENCE 1 - NORTH 2 - SOUTH 3 - EAST 4 - WEST 4	ROUTE TYPE IR - INTERSTATE ROUTE (TP) US - FEDERAL US ROUTE SR - STATE ROUTE CR - NUMBERED COUNTY ROUTE TR - NUMBERED TOWNSHIP ROUTE	ROAD TYPE AL - ALLEY AV - AVENUE BL - BOULEVARD CR - CIRCLE CT - COURT DR - DRIVE HE - HEIGHTS	ROAD TYPE HW - HIGHWAY LA - LANE MP - MILEPOST OV - OVAL PK - PARKWAY PI - PIKE PL - PLACE	RD - ROAD SQ - SQUARE ST - STREET TE - TERRACE TL - TRAIL WA - WAY	MANNER OF CRASH COLLISION/IMPACT 1 - NOT COLLISION BETWEEN TWO MOTOR VEHICLES IN TRANSPORT 2 - REAR-END 3 - HEAD-ON 4 - REAR-TO-REAR 5 - BACKING 6 - ANGLE 7 - SIDESWIPE, SAME DIRECTION 8 - SIDESWIPE, OPPOSITE DIRECTION 9 - OTHER / UNKNOWN 2	DIRECTION OF TRAVEL 1 - NORTH 2 - SOUTH 3 - EAST 4 - WEST 3	MEDIAN TYPE 1 - DIVIDED FLUSH MEDIAN (< 4 FEET) 2 - DIVIDED FLUSH MEDIAN (≥ 4 FEET) 3 - DIVIDED, DEPRESSED MEDIAN 4 - DIVIDED, RAISED MEDIAN (ANY TYPE) 9 - OTHER / UNKNOWN
<input type="checkbox"/> WORK ZONE RELATED <input type="checkbox"/> WORKERS PRESENT <input type="checkbox"/> LAW ENFORCEMENT PRESENT <input type="checkbox"/> ACTIVE SCHOOL ZONE	WORK ZONE TYPE 1 - LANE CLOSURE 2 - LANE SHIFT/ CROSSOVER 3 - WORK ON SHOULDER OR MEDIAN 4 - INTERMITTENT OR MOVING WORK 5 - OTHER	LOCATION OF CRASH IN WORK ZONE 1 - BEFORE THE 1ST WORK ZONE WARNING SIGN 2 - ADVANCE WARNING AREA 3 - TRANSITION AREA 4 - ACTIVITY AREA 5 - TERMINATION AREA	CONTOUR 1	CONDITIONS 1	SURFACE 2	LIGHT CONDITION 1 - DAYLIGHT 2 - DAWN/DUSK 3 - DARK - LIGHTED ROADWAY 4 - DARK - ROADWAY NOT LIGHTED 5 - DARK - UNKNOWN ROADWAY LIGHTING 9 - OTHER / UNKNOWN 1	WEATHER 1 - CLEAR 2 - CLOUDY 3 - FOG, SMOG, SMOKE 4 - RAIN 5 - SLEET, HAIL 6 - SNOW 7 - SEVERE CROSSWINDS 8 - BLOWING SAND, SOIL, DIRT, SNOW 9 - FREEZING RAIN OR FREEZING DRIZZLE 99 - OTHER / UNKNOWN 1	SURFACE 1 - CONCRETE 2 - BLACKTOP, BITUMINOUS, ASPHALT 3 - BRICK/BLOCK 4 - SLAG, GRAVEL, STONE 5 - DIRT 9 - OTHER / UNKNOWN
NARRATIVE On February 22, 2023 at 1741 hours, I was dispatched to 2192 Winemiller Ln (FRISCH'S) in Batavia Township for a 2 vehicle MVA in the drive thru. Upon my arrival, I observed the two vehicles involved to be a gray Chevy Trax bearing Ohio Registration JVZ9764 and a gray Pontiac Montana SV6 bearing Ohio Registration JIX6923. The driver of the Chevy was the identified as Ms. Rachele Vance and her passengers were identified as Jameson Vance (Front Passenger) and Dalton Vance (Rear Right Passenger). The driver of the pontiac was identified as Ms. Marilyn Page. It was apparent that Ms. Page rear ended Ms. Rachele's vehicle in the drivethru. Ms. Vance and Ms. Page both advised that there were instructed by the drive thru employee to pull up to retrieve their order. I observed damage to Ms. Vance's rear bumper and Ms. Page's front bumper. Ms. Vance advised upon the impact her seat belt locked up and her airbag light on the dash activated. After photographs were obtained Ms. Vance was advised to pull into a parking space. Ms. Vance informed me that her vehicle became disabled in result of the MVA and was unable to start her vehicle. All parties involved advised they did not sustain any injuries in result of the MVA.								
CRASH REPORTED DATE / TIME 02/22/2023 17:35		DISPATCH DATE / TIME 02/22/2023 17:41		ARRIVAL DATE / TIME 02/22/2023 17:48		SCENE CLEARED DATE / TIME 02/22/2023 18:14		REPORT TAKEN BY <input checked="" type="checkbox"/> POLICE AGENCY <input type="checkbox"/> MOTORIST
TOTAL TIME ROADWAY CLOSED 0	OTHER INVESTIGATION TIME 0	TOTAL MINUTES 33	OFFICER'S NAME* Deputy B. Pham		CHECKED BY OFFICER'S NAME* Rudd, J		<input checked="" type="checkbox"/> SUPPLEMENT (CORRECTION OR ADDITION TO AN EXISTING REPORT SENT TO ODPS)	
OFFICER'S BADGE NUMBER* R12228	CHECKED BY OFFICER'S BADGE NUMBER* R3052							

**UNIT #** 1 **OWNER NAME:** LAST, FIRST, MIDDLE (  SAME AS DRIVER )  
PAGE, MARILYN, S **OWNER PHONE:** INCLUDE AREA CODE (  SAME AS DRIVER )

**OWNER ADDRESS:** STREET, CITY, STATE, ZIP (  SAME AS DRIVER )  
3829 GREENBUSH WEST RD , MOUNT ORAB, OH, 45154

**COMMERCIAL CARRIER:** NAME, ADDRESS, CITY, STATE, ZIP **COMMERCIAL CARRIER PHONE:** INCLUDE AREA CODE

**LP STATE** OH **LICENSE PLATE #** JIX6923 **VEHICLE IDENTIFICATION #** 1GMDV33L76D136293 **VEHICLE YEAR** 2006 **VEHICLE MAKE** PONTIAC

**INSURANCE VERIFIED** **INSURANCE COMPANY** NATIONWIDE **INSURANCE POLICY #** 9234J206719 **COLOR** GRY **VEHICLE MODEL** MONTANA/ SV6

**COMMERCIAL**  **GOVERNMENT**  **IN EMERGENCY RESPONSE** **US DOT #** **TOWED BY:** COMPANY NAME

**INTERLOCK DEVICE EQUIPPED**  **HIT/SKIP UNIT** **# OCCUPANTS** **VEHICLE WEIGHT GVWR/GCWR**  
1 - ≤ 10K LBS.  
2 - 10.001 - 26K LBS.  
3 - > 26K LBS.

**MATERIAL RELEASED** **HAZARDOUS MATERIAL CLASS #** **PLACARD ID #**

**UNIT TYPE** 2

1 - PASSENGER CAR	6 - VAN (9-15 SEATS)	12 - GOLF CART	18 - LIMO (LIVERY VEHICLE)	23 - PEDESTRIAN/SKATER
2 - PASSENGER VAN (MINIVAN)	7 - MOTORCYCLE 2-WHEELED	13 - SNOWMOBILE	19 - BUS (16+ PASSENGERS)	24 - WHEELCHAIR (ANY TYPE)
3 - SPORT UTILITY VEHICLE	8 - MOTORCYCLE 3-WHEELED	14 - SINGLE UNIT TRUCK	20 - OTHER VEHICLE	25 - OTHER NON-MOTORIST
4 - PICK UP	9 - AUTOCYCLE	15 - SEMI-TRACTOR	21 - HEAVY EQUIPMENT	26 - BICYCLE
5 - CARGO VAN	10 - MOPED OR MOTORIZED BICYCLE	16 - FARM EQUIPMENT	22 - ANIMAL WITH RIDER OR ANIMAL-DRAWN VEHICLE	27 - TRAIN
	11 - ALL TERRAIN VEHICLE (ATV/UTV)	17 - MOTORHOME	99 - UNKNOWN OR HIT/SKIP	

**# OF TRAILING UNITS** 0

**WAS VEHICLE OPERATING IN AUTONOMOUS MODE WHEN CRASH OCCURRED?** 2

**AUTONOMOUS MODE LEVEL** 0

0 - NO AUTOMATION 3 - CONDITIONAL AUTOMATION 9 - UNKNOWN  
1 - DRIVER ASSISTANCE 4 - HIGH AUTOMATION 5 - FULL AUTOMATION

**SPECIAL FUNCTION** 1

1 - NONE	6 - BUS - CHARTER/TOUR	11 - FIRE	16 - FARM	21 - MAIL CARRIER
2 - TAXI	7 - BUS - INTERCITY	12 - MILITARY	17 - MOWING	99 - OTHER / UNKNOWN
3 - ELECTRONIC RIDE SHARING	8 - BUS - SHUTTLE	13 - POLICE	18 - SNOW REMOVAL	
4 - SCHOOL TRANSPORT	9 - BUS - OTHER	14 - PUBLIC UTILITY	19 - TOWING	
5 - BUS - TRANSIT/COMMUTER	10 - AMBULANCE	15 - CONSTRUCTION EQUIP.	20 - SAFETY SERVICE PATROL	

**CARGO BODY TYPE** 1

1 - NO CARGO BODY TYPE / NOT APPLICABLE	4 - LOGGING	7 - GRAIN/CHIPS/GRAVEL	11 - DUMP	99 - OTHER / UNKNOWN
2 - BUS	5 - INTERMODAL CONTAINER CHASSIS	8 - POLE	12 - CONCRETE MIXER	
3 - VEHICLE TOWING ANOTHER MOTOR VEHICLE	6 - CARGOVAN /ENCLOSED BOX	9 - CARGO TANK	13 - AUTO TRANSPORTER	
		10 - FLAT BED	14 - GARBAGE/REFUSE	

**VEHICLE DEFECTS** 99

1 - TURN SIGNALS	4 - BRAKES	7 - WORN OR SLICK TIRES	9 - MOTOR TROUBLE	99 - OTHER / UNKNOWN
2 - HEAD LAMPS	5 - STEERING	8 - TRAILER EQUIPMENT DEFECTIVE	10 - DISABLED FROM PRIOR ACCIDENT	
3 - TAIL LAMPS	6 - TIRE BLOWOUT			

**NON-MOTORIST LOCATION** 3

1 - INTERSECTION - MARKED CROSSWALK	4 - MIDBLOCK - MARKED CROSSWALK	7 - SHOULDER/ROADSIDE	10 - DRIVEWAY ACCESS	99 - OTHER / UNKNOWN
2 - INTERSECTION - UNMARKED CROSSWALK	5 - TRAVEL LANE - OTHER LOCATION	8 - SIDEWALK	11 - SHARED USE PATHS OR TRAILS	
3 - INTERSECTION - OTHER	6 - BICYCLE LANE	9 - MEDIAN/CROSSING ISLAND	12 - FIRST RESPONDER AT INCIDENT SCENE	

**ACTION** 3 **PRE-CRASH ACTIONS** 1

1 - NON-CONTACT	1 - STRAIGHT AHEAD	9 - LEAVING TRAFFIC LANE	15 - WALKING, RUNNING, JOGGING, PLAYING	21 - STANDING OUTSIDE DISABLED VEHICLE
2 - NON-COLLISION	2 - BACKING	10 - PARKED	16 - WORKING	99 - OTHER / UNKNOWN
3 - STRIKING	3 - CHANGING LANES	11 - SLOWING OR STOPPED IN TRAFFIC	17 - PUSHING VEHICLE	
4 - STRUCK	4 - OVERTAKING/PASSING	12 - DRIVERLESS	18 - APPROACHING OR LEAVING VEHICLE	
5 - BOTH STRIKING & STRUCK	5 - MAKING RIGHT TURN	13 - NEGOTIATING A CURVE	19 - STANDING	
6 - STRUCK	6 - MAKING LEFT TURN	14 - ENTERING OR CROSSING SPECIFIED LOCATION	20 - OTHER NON-MOTORIST	
7 - STRUCK	7 - MAKING U-TURN			
8 - STRUCK	8 - ENTERING TRAFFIC LANE			
9 - OTHER / UNKNOWN				

**CONTRIBUTING CIRCUMSTANCES** 8

1 - NONE	8 - FOLLOWING TOO CLOSE /ACDA	13 - IMPROPER START FROM A PARKED POSITION	18 - OPERATING DEFECTIVE EQUIPMENT	23 - OPENING DOOR INTO ROADWAY
2 - FAILURE TO YIELD	9 - IMPROPER LANE CHANGE	14 - STOPPED OR PARKED ILLEGALLY	19 - LOAD SHIFTING /FALLING/SPILLING	99 - OTHER IMPROPER ACTION
3 - RAN RED LIGHT	10 - IMPROPER PASSING	15 - SWERVING TO AVOID	20 - IMPROPER CROSSING	
4 - RAN STOP SIGN	11 - DROVE OFF ROAD	16 - WRONG WAY	21 - LYING IN ROADWAY	
5 - UNSAFE SPEED	12 - IMPROPER BACKING	17 - VISION OBSTRUCTION	22 - NOT DISCERNIBLE	
6 - IMPROPER TURN				
7 - LEFT OF CENTER				

**SEQUENCE OF EVENTS**

1 **20** 1 - OVERTURN/ROLLOVER 7 - SEPARATION OF UNITS 12 - DOWNHILL RUNAWAY 19 - ANIMAL - OTHER 23 - STRUCK BY FALLING, SHIFTING CARGO OR ANYTHING SET IN MOTION BY A MOTOR VEHICLE

2 **99** 2 - FIRE/EXPLOSION 8 - RAN OFF ROAD RIGHT 13 - OTHER NON-COLLISION 20 - MOTOR VEHICLE IN TRANSPORT

3 **99** 3 - IMMERSION 9 - RAN OFF ROAD LEFT 14 - PEDESTRIAN 21 - PARKED MOTOR VEHICLE

4 **99** 4 - JACKKNIFE 10 - CROSS MEDIAN 15 - PEDALCYCLE 22 - WORK ZONE MAINTENANCE EQUIPMENT

5 **99** 5 - CARGO / EQUIPMENT LOSS OR SHIFT 11 - CROSS CENTERLINE - OPPOSITE DIRECTION OF TRAVEL 16 - RAILWAY VEHICLE 23 - STRUCK BY FALLING, SHIFTING CARGO OR ANYTHING SET IN MOTION BY A MOTOR VEHICLE

6 **99** 6 - EQUIPMENT FAILURE 12 - IMPROPER BACKING 17 - VISION OBSTRUCTION 18 - ANIMAL - DEER 24 - OTHER MOVABLE OBJECT

**COLLISION WITH FIXED OBJECT - STRUCK**

25 - IMPACT ATTENUATOR / CRASH CUSHION	31 - GUARDRAIL END	38 - OVERHEAD SIGN POST	45 - EMBANKMENT	52 - BUILDING
26 - BRIDGE OVERHEAD STRUCTURE	32 - PORTABLE BARRIER	39 - LIGHT / LUMINARIES SUPPORT	46 - FENCE	53 - TUNNEL
27 - BRIDGE PIER OR ABUTMENT	33 - MEDIAN CABLE BARRIER	40 - UTILITY POLE	47 - MAILBOX	54 - OTHER FIXED OBJECT
28 - BRIDGE PARAPET	34 - MEDIAN GUARDRAIL BARRIER	41 - OTHER POST, POLE OR SUPPORT	48 - TREE	99 - OTHER / UNKNOWN
29 - BRIDGE RAIL	35 - MEDIAN CONCRETE BARRIER	42 - CULVERT	49 - FIRE HYDRANT	
30 - GUARDRAIL FACE	36 - MEDIAN OTHER BARRIER	43 - CURB	50 - WORK ZONE MAINTENANCE EQUIPMENT	
	37 - TRAFFIC SIGN POST	44 - DITCH	51 - WALL	

**FIRST HARMFUL EVENT** 2 **MOST HARMFUL EVENT** 2

**LOCAL REPORT NUMBER**

000230005843

**DAMAGE**

**DAMAGE SCALE**

1 - NONE 3 - FUNCTIONAL DAMAGE  
2 - MINOR DAMAGE 4 - DISABLING DAMAGE  
9 - UNKNOWN

**DAMAGED AREA(S)**

INDICATE ALL THAT APPLY

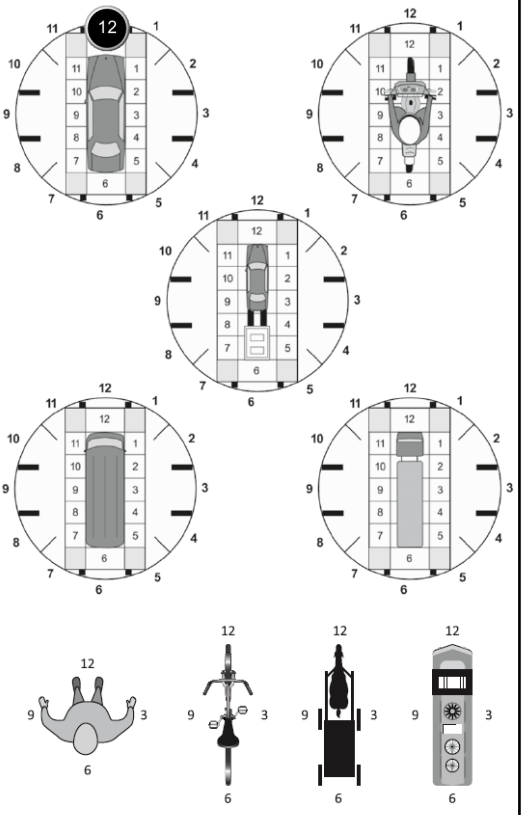

**NO DAMAGE** [ 0 ]  **UNDERCARRIAGE** [ 14 ]  
 **TOP** [ 13 ]  **ALL AREAS** [ 15 ]  
 **UNIT NOT AT SCENE** [ 16 ]

**INITIAL POINT OF CONTACT**

0 - NO DAMAGE 14 - UNDERCARRIAGE  
1-12 - REFER TO UNIT DIAGRAM 15 - VEHICLE NOT AT SCENE  
99 - UNKNOWN  
13 - TOP

**TRAFFIC**

**TRAFFICWAY FLOW** 1 - ONE-WAY 2 - TWO-WAY  
**TRAFFIC CONTROL** 1 - ROUNDABOUT 4 - STOP SIGN 2 - SIGNAL 5 - YIELD SIGN 3 - FLASHER 6 - NO CONTROL

**# OF THROUGH LANES ON ROAD** 1  
**RAIL GRADE CROSSING** 1 - NOT INVOLVED 2 - INVOLVED-ACTIVE CROSSING 3 - INVOLVED-PASSIVE CROSSING

**UNIT / NON-MOTORIST DIRECTION**

FROM 2 TO 1  
1 - NORTH 5 - NORTHEAST  
2 - SOUTH 6 - NORTHWEST  
3 - EAST 7 - SOUTHEAST  
4 - WEST 8 - SOUTHWEST  
9 - OTHER / UNKNOWN

**UNIT SPEED** 5  
**DETECTED SPEED** 1 - STATED / ESTIMATED SPEED

**POSTED SPEED**  
2 - CALCULATED / EDR  
3 - UNDETERMINED

<b>OWNER</b>	<b>UNIT #</b> 2	<b>OWNER NAME:</b> LAST, FIRST, MIDDLE ( <input type="checkbox"/> SAME AS DRIVER ) VANCE, RACHELLE, LEE	<b>OWNER PHONE:</b> INCLUDE AREA CODE ( <input type="checkbox"/> SAME AS DRIVER )
	<b>OWNER ADDRESS:</b> STREET, CITY, STATE, ZIP ( <input type="checkbox"/> SAME AS DRIVER ) 45 E MAIN ST , MOWRYSTOWN, OH, 45155		
	<b>COMMERCIAL CARRIER:</b> NAME, ADDRESS, CITY, STATE, ZIP		<b>COMMERCIAL CARRIER PHONE:</b> INCLUDE AREA CODE

<b>LP STATE</b> OH	<b>LICENSE PLATE #</b> JVZ9764	<b>VEHICLE IDENTIFICATION #</b> KL7CJPSB0HB121058	<b>VEHICLE YEAR</b> 2017	<b>VEHICLE MAKE</b> CHEVROLET
<input checked="" type="checkbox"/> <b>INSURANCE VERIFIED</b>	<b>INSURANCE COMPANY</b> GRANGE	<b>INSURANCE POLICY #</b> 4379204	<b>COLOR</b> GRY	<b>VEHICLE MODEL</b> TRAX
<input type="checkbox"/> <b>COMMERCIAL</b> <input type="checkbox"/> <b>GOVERNMENT</b> <input type="checkbox"/> <b>IN EMERGENCY RESPONSE</b>		<b>US DOT #</b>	<b>TOWED BY:</b> COMPANY NAME	
<input type="checkbox"/> <b>INTERLOCK DEVICE EQUIPPED</b>	<input type="checkbox"/> <b>HIT/SKIP UNIT</b>	<b># OCCUPANTS</b> 2	<b>HAZARDOUS MATERIAL</b> <input type="checkbox"/> MATERIAL <input type="checkbox"/> RELEASED <input type="checkbox"/> PLACARD	
<b>UNIT TYPE</b> 3	<input type="checkbox"/> 1 - PASSENGER CAR <input type="checkbox"/> 2 - PASSENGER VAN (MINIVAN) <input type="checkbox"/> 3 - SPORT UTILITY VEHICLE <input type="checkbox"/> 4 - PICK UP <input type="checkbox"/> 5 - CARGO VAN	<input type="checkbox"/> 6 - VAN (9-15 SEATS) <input type="checkbox"/> 7 - MOTORCYCLE 2-WHEELED <input type="checkbox"/> 8 - MOTORCYCLE 3-WHEELED <input type="checkbox"/> 9 - AUTOCYCLE <input type="checkbox"/> 10 - MOPED OR MOTORIZED BICYCLE <input type="checkbox"/> 11 - ALL TERRAIN VEHICLE (ATV/UTV)	<input type="checkbox"/> 12 - GOLF CART <input type="checkbox"/> 13 - SNOWMOBILE <input type="checkbox"/> 14 - SINGLE UNIT TRUCK <input type="checkbox"/> 15 - SEMI-TRACTOR <input type="checkbox"/> 16 - FARM EQUIPMENT <input type="checkbox"/> 17 - MOTORHOME	<input type="checkbox"/> 18 - LIMO (LIVERY VEHICLE) <input type="checkbox"/> 19 - BUS (16+ PASSENGERS) <input type="checkbox"/> 20 - OTHER VEHICLE <input type="checkbox"/> 21 - HEAVY EQUIPMENT <input type="checkbox"/> 22 - ANIMAL WITH RIDER OR ANIMAL-DRAWN VEHICLE <input type="checkbox"/> 23 - PEDESTRIAN/SKATER <input type="checkbox"/> 24 - WHEELCHAIR (ANY TYPE) <input type="checkbox"/> 25 - OTHER NON-MOTORIST <input type="checkbox"/> 26 - BICYCLE <input type="checkbox"/> 27 - TRAIN <input type="checkbox"/> 99 - UNKNOWN OR HIT/SKIP
<b># OF TRAILING UNITS</b> 2	<b>WAS VEHICLE OPERATING IN AUTONOMOUS MODE WHEN CRASH OCCURRED?</b> <input type="checkbox"/> 0 - NO AUTOMATION <input type="checkbox"/> 1 - DRIVER ASSISTANCE <input type="checkbox"/> 2 - PARTIAL AUTOMATION <input type="checkbox"/> 3 - CONDITIONAL AUTOMATION <input type="checkbox"/> 4 - HIGH AUTOMATION <input type="checkbox"/> 5 - FULL AUTOMATION <input type="checkbox"/> 9 - UNKNOWN			
<b>SPECIAL FUNCTION</b> 1	<input type="checkbox"/> 1 - NONE <input type="checkbox"/> 2 - TAXI <input type="checkbox"/> 3 - ELECTRONIC RIDE SHARING <input type="checkbox"/> 4 - SCHOOL TRANSPORT <input type="checkbox"/> 5 - BUS - TRANSIT/COMMUTER <input type="checkbox"/> 6 - BUS - CHARTER/TOUR <input type="checkbox"/> 7 - BUS - INTERCITY <input type="checkbox"/> 8 - BUS - SHUTTLE <input type="checkbox"/> 9 - BUS - OTHER <input type="checkbox"/> 10 - AMBULANCE <input type="checkbox"/> 11 - FIRE <input type="checkbox"/> 12 - MILITARY <input type="checkbox"/> 13 - POLICE <input type="checkbox"/> 14 - PUBLIC UTILITY <input type="checkbox"/> 15 - CONSTRUCTION EQUIP. <input type="checkbox"/> 16 - FARM <input type="checkbox"/> 17 - MOWING <input type="checkbox"/> 18 - SNOW REMOVAL <input type="checkbox"/> 19 - TOWING <input type="checkbox"/> 20 - SAFETY SERVICE PATROL <input type="checkbox"/> 21 - MAIL CARRIER <input type="checkbox"/> 99 - OTHER / UNKNOWN			
<b>CARGO BODY TYPE</b> 99	<input type="checkbox"/> 1 - NO CARGO BODY TYPE / NOT APPLICABLE <input type="checkbox"/> 2 - BUS <input type="checkbox"/> 3 - VEHICLE TOWING ANOTHER MOTOR VEHICLE <input type="checkbox"/> 4 - LOGGING <input type="checkbox"/> 5 - INTERMODAL CONTAINER CHASSIS <input type="checkbox"/> 6 - CARGOVAN / ENCLOSED BOX <input type="checkbox"/> 7 - GRAIN/CHIPS/GRAVEL <input type="checkbox"/> 8 - POLE <input type="checkbox"/> 9 - CARGO TANK <input type="checkbox"/> 10 - FLAT BED <input type="checkbox"/> 11 - DUMP <input type="checkbox"/> 12 - CONCRETE MIXER <input type="checkbox"/> 13 - AUTO TRANSPORTER <input type="checkbox"/> 14 - GARBAGE/REFUSE <input type="checkbox"/> 99 - OTHER / UNKNOWN			
<b>VEHICLE DEFECTS</b> 99	<input type="checkbox"/> 1 - TURN SIGNALS <input type="checkbox"/> 2 - HEAD LAMPS <input type="checkbox"/> 3 - TAIL LAMPS <input type="checkbox"/> 4 - BRAKES <input type="checkbox"/> 5 - STEERING <input type="checkbox"/> 6 - TIRE BLOWOUT <input type="checkbox"/> 7 - WORN OR SLICK TIRES <input type="checkbox"/> 8 - TRAILER EQUIPMENT DEFECTIVE <input type="checkbox"/> 9 - MOTOR TROUBLE <input type="checkbox"/> 10 - DISABLED FROM PRIOR ACCIDENT <input type="checkbox"/> 99 - OTHER / UNKNOWN			

<b>NON-MOTORIST LOCATION AT IMPACT</b> 99	<input type="checkbox"/> 1 - INTERSECTION - MARKED CROSSWALK <input type="checkbox"/> 2 - INTERSECTION - UNMARKED CROSSWALK <input type="checkbox"/> 3 - INTERSECTION - OTHER <input type="checkbox"/> 4 - MIDBLOCK - MARKED CROSSWALK <input type="checkbox"/> 5 - TRAVEL LANE - OTHER LOCATION <input type="checkbox"/> 6 - BICYCLE LANE <input type="checkbox"/> 7 - SHOULDER/ROADSIDE <input type="checkbox"/> 8 - SIDEWALK <input type="checkbox"/> 9 - MEDIAN/CROSSING ISLAND <input type="checkbox"/> 10 - DRIVEWAY ACCESS <input type="checkbox"/> 11 - SHARED USE PATHS OR TRAILS <input type="checkbox"/> 12 - FIRST RESPONDER AT INCIDENT SCENE <input type="checkbox"/> 99 - OTHER / UNKNOWN			
<b>ACTION</b> 4	<input type="checkbox"/> 1 - NON-CONTACT <input type="checkbox"/> 2 - NON-COLLISION <input type="checkbox"/> 3 - STRIKING <input type="checkbox"/> 4 - STRUCK <input type="checkbox"/> 5 - BOTH STRIKING & STRUCK <input type="checkbox"/> 9 - OTHER / UNKNOWN <input type="checkbox"/> 1 - STRAIGHT AHEAD <input type="checkbox"/> 2 - BACKING <input type="checkbox"/> 3 - CHANGING LANES <input type="checkbox"/> 4 - OVERTAKING/PASSING <input type="checkbox"/> 5 - MAKING RIGHT TURN <input type="checkbox"/> 6 - MAKING LEFT TURN <input type="checkbox"/> 7 - MAKING U-TURN <input type="checkbox"/> 8 - ENTERING TRAFFIC LANE <input type="checkbox"/> 9 - LEAVING TRAFFIC LANE <input type="checkbox"/> 10 - PARKED <input type="checkbox"/> 11 - SLOWING OR STOPPED IN TRAFFIC <input type="checkbox"/> 12 - DRIVERLESS <input type="checkbox"/> 13 - NEGOTIATING A CURVE <input type="checkbox"/> 14 - ENTERING OR CROSSING SPECIFIED LOCATION <input type="checkbox"/> 15 - WALKING, RUNNING, JOGGING, PLAYING <input type="checkbox"/> 16 - WORKING <input type="checkbox"/> 17 - PUSHING VEHICLE <input type="checkbox"/> 18 - APPROACHING OR LEAVING VEHICLE <input type="checkbox"/> 19 - STANDING <input type="checkbox"/> 20 - OTHER NON-MOTORIST <input type="checkbox"/> 21 - STANDING OUTSIDE DISABLED VEHICLE <input type="checkbox"/> 99 - OTHER / UNKNOWN			
<b>CONTRIBUTING CIRCUMSTANCES</b> 1	<input type="checkbox"/> 1 - NONE <input type="checkbox"/> 2 - FAILURE TO YIELD <input type="checkbox"/> 3 - RAN RED LIGHT <input type="checkbox"/> 4 - RAN STOP SIGN <input type="checkbox"/> 5 - UNSAFE SPEED <input type="checkbox"/> 6 - IMPROPER TURN <input type="checkbox"/> 7 - LEFT OF CENTER <input type="checkbox"/> 8 - FOLLOWING TOO CLOSE / ACDA <input type="checkbox"/> 9 - IMPROPER LANE CHANGE <input type="checkbox"/> 10 - IMPROPER PASSING <input type="checkbox"/> 11 - DROVE OFF ROAD <input type="checkbox"/> 12 - IMPROPER BACKING <input type="checkbox"/> 13 - IMPROPER START FROM A PARKED POSITION <input type="checkbox"/> 14 - STOPPED OR PARKED ILLEGALLY <input type="checkbox"/> 15 - SWERVING TO AVOID <input type="checkbox"/> 16 - WRONG WAY <input type="checkbox"/> 17 - VISION OBSTRUCTION <input type="checkbox"/> 18 - OPERATING DEFECTIVE EQUIPMENT <input type="checkbox"/> 19 - LOAD SHIFTING / FALLING/SPILLING <input type="checkbox"/> 20 - IMPROPER CROSSING <input type="checkbox"/> 21 - LYING IN ROADWAY <input type="checkbox"/> 22 - NOT DISCERNIBLE <input type="checkbox"/> 23 - OPENING DOOR INTO ROADWAY <input type="checkbox"/> 99 - OTHER IMPROPER ACTION			

<b>SEQUENCE OF EVENTS</b>	<b>EVENTS</b>			
1	99	1 - OVERTURN/ROLLOVER	2 - FIRE/EXPLOSION	3 - IMMERSION
2		4 - JACKKNIFE	5 - CARGO / EQUIPMENT LOSS OR SHIFT	6 - EQUIPMENT FAILURE
3		7 - SEPARATION OF UNITS	8 - RAN OFF ROAD RIGHT	9 - RAN OFF ROAD LEFT
4		10 - CROSS MEDIAN	11 - CROSS CENTERLINE - OPPOSITE DIRECTION OF TRAVEL	12 - DOWNHILL RUNAWAY
5		13 - OTHER NON-COLLISION	14 - OTHER NON-COLLISION	15 - PEDESTRIAN
6		16 - PEDALCYCLE	17 - RAILWAY VEHICLE	18 - ANIMAL - FARM
		19 - ANIMAL - DEER	20 - MOTOR VEHICLE IN TRANSPORT	21 - PARKED MOTOR VEHICLE
		22 - WORK ZONE MAINTENANCE EQUIPMENT	23 - STRUCK BY FALLING, SHIFTING CARGO OR ANYTHING SET IN MOTION BY A MOTOR VEHICLE	24 - OTHER MOVABLE OBJECT
<b>COLLISION WITH FIXED OBJECT - STRUCK</b>				
1		25 - IMPACT ATTENUATOR / CRASH CUSHION	26 - BRIDGE OVERHEAD STRUCTURE	27 - BRIDGE PIER OR ABUTMENT
2		28 - BRIDGE PARAPET	29 - BRIDGE RAIL	30 - GUARDRAIL FACE
3		31 - GUARDRAIL END	32 - PORTABLE BARRIER	33 - MEDIAN CABLE BARRIER
4		34 - MEDIAN GUARDRAIL BARRIER	35 - MEDIAN CONCRETE BARRIER	36 - MEDIAN OTHER BARRIER
5		37 - TRAFFIC SIGN POST	38 - OVERHEAD SIGN POST	39 - LIGHT / LUMINARIES SUPPORT
6		40 - UTILITY POLE	41 - OTHER POST, POLE OR SUPPORT	42 - CULVERT
		43 - CURB	44 - DITCH	45 - EMBANKMENT
		46 - FENCE	47 - MAILBOX	48 - TREE
		49 - FIRE HYDRANT	50 - WORK ZONE MAINTENANCE EQUIPMENT	51 - WALL
		52 - BUILDING	53 - TUNNEL	54 - OTHER FIXED OBJECT
		55 - OTHER / UNKNOWN		
<b>FIRST HARMFUL EVENT</b> 1		<b>MOST HARMFUL EVENT</b> 1		

**LOCAL REPORT NUMBER**

000230005843

**DAMAGE**

**DAMAGE SCALE**

1 - NONE    3 - FUNCTIONAL DAMAGE  
 2 - MINOR DAMAGE     4 - DISABLING DAMAGE  
 4    9 - UNKNOWN

**DAMAGED AREA(S)**

INDICATE ALL THAT APPLY

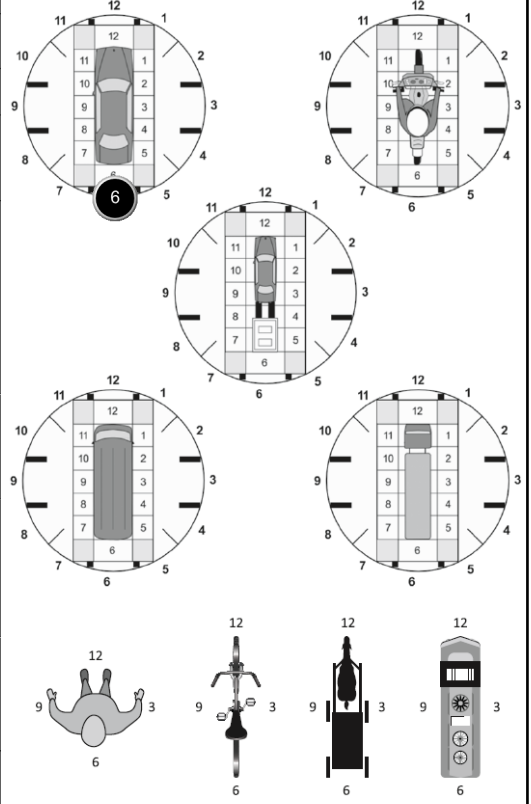

**NO DAMAGE** [ 0 ]     **UNDERCARRIAGE** [ 14 ]  
 **TOP** [ 13 ]     **ALL AREAS** [ 15 ]  
 **UNIT NOT AT SCENE** [ 16 ]

**INITIAL POINT OF CONTACT**

0 - NO DAMAGE    14 - UNDERCARRIAGE  
 8    1-12 - REFER TO UNIT DIAGRAM    15 - VEHICLE NOT AT SCENE  
 99 - UNKNOWN

**TRAFFIC**

<b>TRAFFICWAY FLOW</b> 1 - ONE-WAY 2 - TWO-WAY	<b>TRAFFIC CONTROL</b> 1 - ROUNDABOUT    4 - STOP SIGN 2 - SIGNAL    5 - YIELD SIGN 3 - FLASHER    6 - NO CONTROL
<b># OF THROUGH LANES ON ROAD</b> 1	<b>RAIL GRADE CROSSING</b> 1 - NOT INVOLVED 2 - INVOLVED-ACTIVE CROSSING 3 - INVOLVED-PASSIVE CROSSING

**UNIT / NON-MOTORIST DIRECTION**

1 - NORTH    5 - NORTHEAST  
 2 - SOUTH    6 - NORTHWEST  
 3 - EAST    7 - SOUTHEAST  
 4 - WEST    8 - SOUTHWEST  
 9 - OTHER / UNKNOWN

FROM [ ] TO [ ]

**UNIT SPEED**

**DETECTED SPEED**

1 - STATED / ESTIMATED SPEED  
 2 - CALCULATED / EDR  
 3 - UNDETERMINED

# MOTORIST / Non-MOTORIST

**LOCAL REPORT NUMBER**  
000230005843

<b>UNIT #</b> 1	<b>NAME: LAST, FIRST, MIDDLE</b> PAGE, MARILYN, S				<b>DATE OF BIRTH</b> 05/25/1951		<b>AGE</b> 71	<b>GENDER</b> F			
<b>ADDRESS: STREET, CITY, STATE, ZIP</b> 3829 GREENBUSH WEST RD, MOUNT ORAB, OH, 45154					<b>CONTACT PHONE - INCLUDE AREA CODE</b>						
<b>INJURIES</b> 5	<b>INJURED TAKEN BY</b> 1	<b>EMS AGENCY (NAME)</b>	<b>INJURED TAKEN TO: MEDICAL FACILITY (NAME, CITY)</b>		<b>SAFETY EQUIPMENT USED</b> 4	<input type="checkbox"/> DOT-COMPLIANT <input checked="" type="checkbox"/> MC HELMET	<b>SEATING POSITION</b> 1	<b>AIR BAG USAGE</b> 1	<b>EJECTION</b> 1	<b>TRAPPED</b> 1	
<b>OL STATE</b> OH	<b>OPERATOR LICENSE NUMBER</b>		<b>OFFENSE CHARGED</b>		<b>LOCAL CODE</b> <input type="checkbox"/>	<b>OFFENSE DESCRIPTION</b>			<b>CITATION NUMBER</b>		
<b>OL CLASS</b> 4	<b>ENDORSEMENT</b>	<b>RESTRICTION</b> SELECT UP TO 3	<b>DRIVER DISTRACTED BY</b> 1	<b>ALCOHOL / DRUG SUSPECTED</b> <input type="checkbox"/> ALCOHOL <input type="checkbox"/> MARIJUANA <input type="checkbox"/> OTHER DRUG		<b>CONDITION</b> 1	<b>ALCOHOL TEST</b>		<b>DRUG TEST(S)</b>		
						<b>STATUS</b> 1	<b>TYPE</b> 1	<b>VALUE</b> .	<b>STATUS</b> 1	<b>TYPE</b> 1	<b>RESULTS</b> SELECT UP TO 4

<b>UNIT #</b> 2	<b>NAME: LAST, FIRST, MIDDLE</b> VANCE, RACHELLE, LEE				<b>DATE OF BIRTH</b> 02/22/1977		<b>AGE</b> 46	<b>GENDER</b> F			
<b>ADDRESS: STREET, CITY, STATE, ZIP</b> 45 E MAIN ST, MOWRYSTOWN, OH, 45155					<b>CONTACT PHONE - INCLUDE AREA CODE</b>						
<b>INJURIES</b> 5	<b>INJURED TAKEN BY</b> 1	<b>EMS AGENCY (NAME)</b>	<b>INJURED TAKEN TO: MEDICAL FACILITY (NAME, CITY)</b>		<b>SAFETY EQUIPMENT USED</b> 4	<input type="checkbox"/> DOT-COMPLIANT <input checked="" type="checkbox"/> MC HELMET	<b>SEATING POSITION</b> 1	<b>AIR BAG USAGE</b> 9	<b>EJECTION</b> 1	<b>TRAPPED</b> 1	
<b>OL STATE</b> OH	<b>OPERATOR LICENSE NUMBER</b>		<b>OFFENSE CHARGED</b>		<b>LOCAL CODE</b> <input type="checkbox"/>	<b>OFFENSE DESCRIPTION</b>			<b>CITATION NUMBER</b>		
<b>OL CLASS</b> 4	<b>ENDORSEMENT</b>	<b>RESTRICTION</b> SELECT UP TO 3	<b>DRIVER DISTRACTED BY</b> 1	<b>ALCOHOL / DRUG SUSPECTED</b> <input type="checkbox"/> ALCOHOL <input type="checkbox"/> MARIJUANA <input type="checkbox"/> OTHER DRUG		<b>CONDITION</b> 1	<b>ALCOHOL TEST</b>		<b>DRUG TEST(S)</b>		
						<b>STATUS</b> 1	<b>TYPE</b> 1	<b>VALUE</b> .	<b>STATUS</b> 1	<b>TYPE</b> 1	<b>RESULTS</b> SELECT UP TO 4

<b>UNIT #</b>	<b>NAME: LAST, FIRST, MIDDLE</b>				<b>DATE OF BIRTH</b>		<b>AGE</b>	<b>GENDER</b>			
<b>ADDRESS: STREET, CITY, STATE, ZIP</b>					<b>CONTACT PHONE - INCLUDE AREA CODE</b>						
<b>INJURIES</b>	<b>INJURED TAKEN BY</b>	<b>EMS AGENCY (NAME)</b>	<b>INJURED TAKEN TO: MEDICAL FACILITY (NAME, CITY)</b>		<b>SAFETY EQUIPMENT USED</b>	<input type="checkbox"/> DOT-COMPLIANT <input type="checkbox"/> MC HELMET	<b>SEATING POSITION</b>	<b>AIR BAG USAGE</b>	<b>EJECTION</b>	<b>TRAPPED</b>	
<b>OL STATE</b>	<b>OPERATOR LICENSE NUMBER</b>		<b>OFFENSE CHARGED</b>		<b>LOCAL CODE</b>	<b>OFFENSE DESCRIPTION</b>			<b>CITATION NUMBER</b>		
<b>OL CLASS</b>	<b>ENDORSEMENT</b>	<b>RESTRICTION</b> SELECT UP TO 3	<b>DRIVER DISTRACTED BY</b>	<b>ALCOHOL / DRUG SUSPECTED</b>		<b>CONDITION</b>	<b>ALCOHOL TEST</b>		<b>DRUG TEST(S)</b>		
						<b>STATUS</b>	<b>TYPE</b>	<b>VALUE</b>	<b>STATUS</b>	<b>TYPE</b>	<b>RESULTS</b> SELECT UP TO 4

INJURIES	SEATING POSITION	AIR BAG	OL CLASS	OL RESTRICTION(S)	DRIVER DISTRACTION	TEST STATUS
1 - FATAL 2 - SUSPECTED SERIOUS INJURY 3 - SUSPECTED MINOR INJURY 4 - POSSIBLE INJURY 5 - NO APPARENT INJURY	1 - FRONT - LEFT SIDE (MOTORCYCLE DRIVER) 2 - FRONT - MIDDLE 3 - FRONT - RIGHT SIDE 4 - SECOND - LEFT SIDE (MOTORCYCLE PASSENGER) 5 - SECOND - MIDDLE 6 - SECOND - RIGHT SIDE 7 - THIRD - LEFT SIDE (MOTORCYCLE SIDE CAR) 8 - THIRD - MIDDLE 9 - THIRD - RIGHT SIDE 10 - SLEEPER SECTION OF TRUCK CAB 11 - PASSENGER IN OTHER ENCLOSED CARGO AREA (NON-TRAILING UNIT, BUS, PICK-UP WITH CAP) 12 - PASSENGER IN UNENCLOSED CARGO AREA 13 - TRAILING UNIT 14 - RIDING ON VEHICLE EXTERIOR (NON-TRAILING UNIT) 15 - NON-MOTORIST 99 - OTHER / UNKNOWN	1 - NOT DEPLOYED 2 - DEPLOYED FRONT 3 - DEPLOYED SIDE 4 - DEPLOYED BOTH FRONT/SIDE 5 - NOT APPLICABLE 9 - DEPLOYMENT UNKNOWN	1 - CLASS A 2 - CLASS B 3 - CLASS C 4 - REGULAR CLASS (OHIO = D) 5 - M/C MOPED ONLY 6 - NO VALID OL	1 - ALCOHOL INTERLOCK DEVICE 2 - CDL INTRASTATE ONLY 3 - CORRECTIVE LENSES 4 - FARM WAIVER 5 - EXCEPT CLASS A BUS 6 - EXCEPT CLASS A & CLASS B BUS 7 - EXCEPT TRACTOR-TRAILER 8 - INTERMEDIATE LICENSE RESTRICTIONS 9 - LEARNER'S PERMIT RESTRICTIONS 10 - LIMITED TO DAYLIGHT ONLY 11 - LIMITED TO EMPLOYMENT 12 - LIMITED - OTHER 13 - MECHANICAL DEVICES (SPECIAL BRAKES, HAND CONTROLS, OR OTHER ADAPTIVE DEVICES) 14 - MILITARY VEHICLES ONLY 15 - MOTOR VEHICLES WITHOUT AIR BRAKES 16 - OUTSIDE MIRROR 17 - PROSTHETIC AID 18 - OTHER	1 - NOT DISTRACTED 2 - MANUALLY OPERATING AN ELECTRONIC COMMUNICATION DEVICE (TEXTING, TYPING, DIALING) 3 - TALKING ON HANDS-FREE COMMUNICATION DEVICE 4 - TALKING ON HAND-HELD COMMUNICATION DEVICE 5 - OTHER ACTIVITY WITH AN ELECTRONIC DEVICE 6 - PASSENGER 7 - OTHER DISTRACTION INSIDE THE VEHICLE 8 - OTHER DISTRACTION OUTSIDE THE VEHICLE 9 - OTHER / UNKNOWN	1 - NONE GIVEN 2 - TEST REFUSED 3 - TEST GIVEN, CONTAMINATED SAMPLE / UNUSABLE 4 - TEST GIVEN, RESULTS KNOWN 5 - TEST GIVEN, RESULTS UNKNOWN
<b>INJURIES TAKEN BY</b>		<b>EJECTION</b>	<b>OL ENDORSEMENT</b>		<b>CONDITION</b>	<b>ALCOHOL TEST TYPE</b>
1 - NOT TRANSPORTED /TREATED AT SCENE 2 - EMS 3 - POLICE 9 - OTHER / UNKNOWN		1 - NOT EJECTED 2 - PARTIALLY EJECTED 3 - TOTALLY EJECTED 4 - NOT APPLICABLE	H - HAZMAT M - MOTORCYCLE P - PASSENGER N - TANKER Q - MOTOR SCOOTER R - THREE-WHEEL MOTORCYCLE S - SCHOOL BUS T - DOUBLE & TRIPLE TRAILERS X - TANKER / HAZMAT		1 - APPARENTLY NORMAL 2 - PHYSICAL IMPAIRMENT 3 - EMOTIONAL (E.G., DEPRESSED, ANGRY, DISTURBED) 4 - ILLNESS 5 - FELL ASLEEP, FAINTED, FATIGUED, ETC. 6 - UNDER THE INFLUENCE OF MEDICATIONS / DRUGS / ALCOHOL 9 - OTHER / UNKNOWN	1 - NONE 2 - BLOOD 3 - URINE 4 - BREATH 5 - OTHER
<b>SAFETY EQUIPMENT</b>		<b>TRAPPED</b>	<b>GENDER</b>			<b>DRUG TEST TYPE</b>
1 - NONE USED 2 - SHOULDER BELT ONLY USED 3 - LAP BELT ONLY USED 4 - SHOULDER & LAP BELT USED 5 - CHILD RESTRAINT SYSTEM - FORWARD FACING 6 - CHILD RESTRAINT SYSTEM - REAR FACING 7 - BOOSTER SEAT 8 - HELMET USED 9 - PROTECTIVE PADS USED (ELBOWS, KNEES, ETC) 10 - REFLECTIVE CLOTHING 11 - LIGHTING - PEDESTRIAN / BICYCLE ONLY 99 - OTHER / UNKNOWN		1 - NOT TRAPPED 2 - EXTRICATED BY MECHANICAL MEANS 3 - FREED BY NON-MECHANICAL MEANS	F - FEMALE M - MALE U - OTHER / UNKNOWN			1 - NONE 2 - BLOOD 3 - URINE 4 - OTHER
						<b>DRUG TEST RESULT(S)</b>
						1 - AMPHETAMINES 2 - BARBITURATES 3 - BENZODIAZEPINES 4 - CANNABINOIDS 5 - COCAINE 6 - OPIATES / OPIOIDS 7 - OTHER 8 - NEGATIVE RESULTS

# OCCUPANT / WITNESS ADDENDUM

LOCAL REPORT NUMBER  
000230005843

<b>OCCUPANT</b>	<b>UNIT #</b> 2	<b>NAME:</b> LAST, FIRST, MIDDLE VANCE, JAMESON				<b>DATE OF BIRTH</b> 11/12/2010		<b>AGE</b> 12	<b>GENDER</b> M	
	<b>ADDRESS:</b> STREET, CITY, STATE, ZIP 45 E MAIN ST, MOWRYSTOWN, OH, 45155					<b>CONTACT PHONE</b> - INCLUDE AREA CODE				
	<b>INJURIES</b> 5	<b>INJURED TAKEN BY</b> 1	<b>EMS AGENCY (NAME)</b>	<b>INJURED TAKEN TO: MEDICAL FACILITY (NAME, CITY)</b>	<b>SAFETY EQUIPMENT</b> 4	<input type="checkbox"/> <b>DOT-COMPLIANT MC HELMET</b>	<b>SEATING POSITION</b> 4	<b>AIR BAG USAGE</b> 9	<b>EJECTION</b> 1	<b>TRAPPED</b> 1

<b>OCCUPANT</b>	<b>UNIT #</b> 2	<b>NAME:</b> LAST, FIRST, MIDDLE VANCE, DALTON				<b>DATE OF BIRTH</b> 01/07/2007		<b>AGE</b> 16	<b>GENDER</b> M	
	<b>ADDRESS:</b> STREET, CITY, STATE, ZIP 45 E MAIN ST , MOWRYSTOWN, OH, 45155					<b>CONTACT PHONE</b> - INCLUDE AREA CODE				
	<b>INJURIES</b> 5	<b>INJURED TAKEN BY</b> 1	<b>EMS AGENCY (NAME)</b>	<b>INJURED TAKEN TO: MEDICAL FACILITY (NAME, CITY)</b>	<b>SAFETY EQUIPMENT</b> 4	<input type="checkbox"/> <b>DOT-COMPLIANT MC HELMET</b>	<b>SEATING POSITION</b> 6	<b>AIR BAG USAGE</b> 1	<b>EJECTION</b> 1	<b>TRAPPED</b> 1

<b>OCCUPANT</b>	<b>UNIT #</b>	<b>NAME:</b> LAST, FIRST, MIDDLE				<b>DATE OF BIRTH</b>		<b>AGE</b>	<b>GENDER</b>	
	<b>ADDRESS:</b> STREET, CITY, STATE, ZIP					<b>CONTACT PHONE</b> - INCLUDE AREA CODE				
	<b>INJURIES</b>	<b>INJURED TAKEN BY</b>	<b>EMS AGENCY (NAME)</b>	<b>INJURED TAKEN TO: MEDICAL FACILITY (NAME, CITY)</b>	<b>SAFETY EQUIPMENT</b>	<input type="checkbox"/> <b>DOT-COMPLIANT MC HELMET</b>	<b>SEATING POSITION</b>	<b>AIR BAG USAGE</b>	<b>EJECTION</b>	<b>TRAPPED</b>

<b>OCCUPANT</b>	<b>UNIT #</b>	<b>NAME:</b> LAST, FIRST, MIDDLE				<b>DATE OF BIRTH</b>		<b>AGE</b>	<b>GENDER</b>	
	<b>ADDRESS:</b> STREET, CITY, STATE, ZIP					<b>CONTACT PHONE</b> - INCLUDE AREA CODE				
	<b>INJURIES</b>	<b>INJURED TAKEN BY</b>	<b>EMS AGENCY (NAME)</b>	<b>INJURED TAKEN TO: MEDICAL FACILITY (NAME, CITY)</b>	<b>SAFETY EQUIPMENT</b>	<input type="checkbox"/> <b>DOT-COMPLIANT MC HELMET</b>	<b>SEATING POSITION</b>	<b>AIR BAG USAGE</b>	<b>EJECTION</b>	<b>TRAPPED</b>

INJURIES	SAFETY EQUIPMENT USED	SEATING POSITION	AIR BAG USAGE
1 - FATAL 2 - SUSPECTED SERIOUS INJURY 3 - SUSPECTED MINOR INJURY 4 - POSSIBLE INJURY 5 - NO APPARENT INJURY	1 - NONE USED - VEHICLE OCCUPANT 2 - SHOULDER BELT ONLY USED 3 - LAP BELT ONLY USED 4 - SHOULDER & LAP BELT USED 5 - CHILD RESTRAINT SYSTEM - FORWARD FACING 6 - CHILD RESTRAINT SYSTEM - REAR FACING 7 - BOOSTER SEAT 8 - HELMET USED 9 - PROTECTIVE PADS USED (ELBOWS, KNEES, ETC) 10 - REFLECTIVE CLOTHING 11 - LIGHTING - PEDESTRIAN / BICYCLE ONLY 99 - OTHER / UNKNOWN	1 - FRONT - LEFT SIDE (MOTORCYCLE DRIVER) 2 - FRONT - MIDDLE 3 - FRONT - RIGHT SIDE 4 - SECOND - LEFT SIDE (MOTORCYCLE PASSENGER) 5 - SECOND - MIDDLE 6 - SECOND - RIGHT SIDE 7 - THIRD - LEFT SIDE (MOTORCYCLE SIDE CAR) 8 - THIRD - MIDDLE 9 - THIRD - RIGHT SIDE 10 - SLEEPER SECTION OF TRUCK CAB 11 - PASSENGER IN OTHER ENCLOSED CARGO AREA (NON-TRAILING UNIT SUCH AS A BUS, PICK-UP WITH CAP) 12 - PASSENGER IN UNENCLOSED CARGO AREA 13 - TRAILING UNIT 14 - RIDING ON VEHICLE EXTERIOR (NON-TRAILING UNIT) 15 - NON-MOTORIST 99 - OTHER / UNKNOWN	1 - NOT DEPLOYED 2 - DEPLOYED FRONT 3 - DEPLOYED SIDE 4 - DEPLOYED BOTH FRONT/SIDE 5 - NOT APPLICABLE 9 - DEPLOYMENT UNKNOWN
INJURED TAKEN BY			EJECTION
1 - NOT TRANSPORTED / TREATED AT SCENE 2 - EMS 3 - POLICE 9 - OTHER / UNKNOWN			1 - NOT EJECTED 2 - PARTIALLY EJECTED 3 - TOTALLY EJECTED 4 - NOT APPLICABLE
GENDER			TRAPPED
F - FEMALE M - MALE U - OTHER / UNKNOWN			1 - NOT TRAPPED 2 - EXTRICATED BY MECHANICAL MEANS 3 - FREED BY NON-MECHANICAL MEANS

<b>WITNESS</b>	<b>NAME:</b> LAST, FIRST, MIDDLE				<b>DATE OF BIRTH</b>		<b>AGE</b>	<b>GENDER</b>		
	<b>ADDRESS:</b> STREET, CITY, STATE, ZIP					<b>CONTACT PHONE</b> - INCLUDE AREA CODE				
	<b>NAME:</b> LAST, FIRST, MIDDLE				<b>DATE OF BIRTH</b>		<b>AGE</b>	<b>GENDER</b>		

<b>WITNESS</b>	<b>NAME:</b> LAST, FIRST, MIDDLE				<b>DATE OF BIRTH</b>		<b>AGE</b>	<b>GENDER</b>		
	<b>ADDRESS:</b> STREET, CITY, STATE, ZIP					<b>CONTACT PHONE</b> - INCLUDE AREA CODE				
	<b>NAME:</b> LAST, FIRST, MIDDLE				<b>DATE OF BIRTH</b>		<b>AGE</b>	<b>GENDER</b>		

<b>WITNESS</b>	<b>NAME:</b> LAST, FIRST, MIDDLE				<b>DATE OF BIRTH</b>		<b>AGE</b>	<b>GENDER</b>		
	<b>ADDRESS:</b> STREET, CITY, STATE, ZIP					<b>CONTACT PHONE</b> - INCLUDE AREA CODE				
	<b>NAME:</b> LAST, FIRST, MIDDLE				<b>DATE OF BIRTH</b>		<b>AGE</b>	<b>GENDER</b>		

OHIO TRAFFIC ACCIDENT - OH2 DIAGRAM

LOCAL REPORT NUMBER <b>000230005843</b>	REPORTING AGENCY <b>Clermont County Sheriff</b>	Date Of Crash <b>02/22/2023</b>
IN COUNTY OF <b>Clermont County</b>	ACCIDENT LOCATION <b>Winemiller</b>	

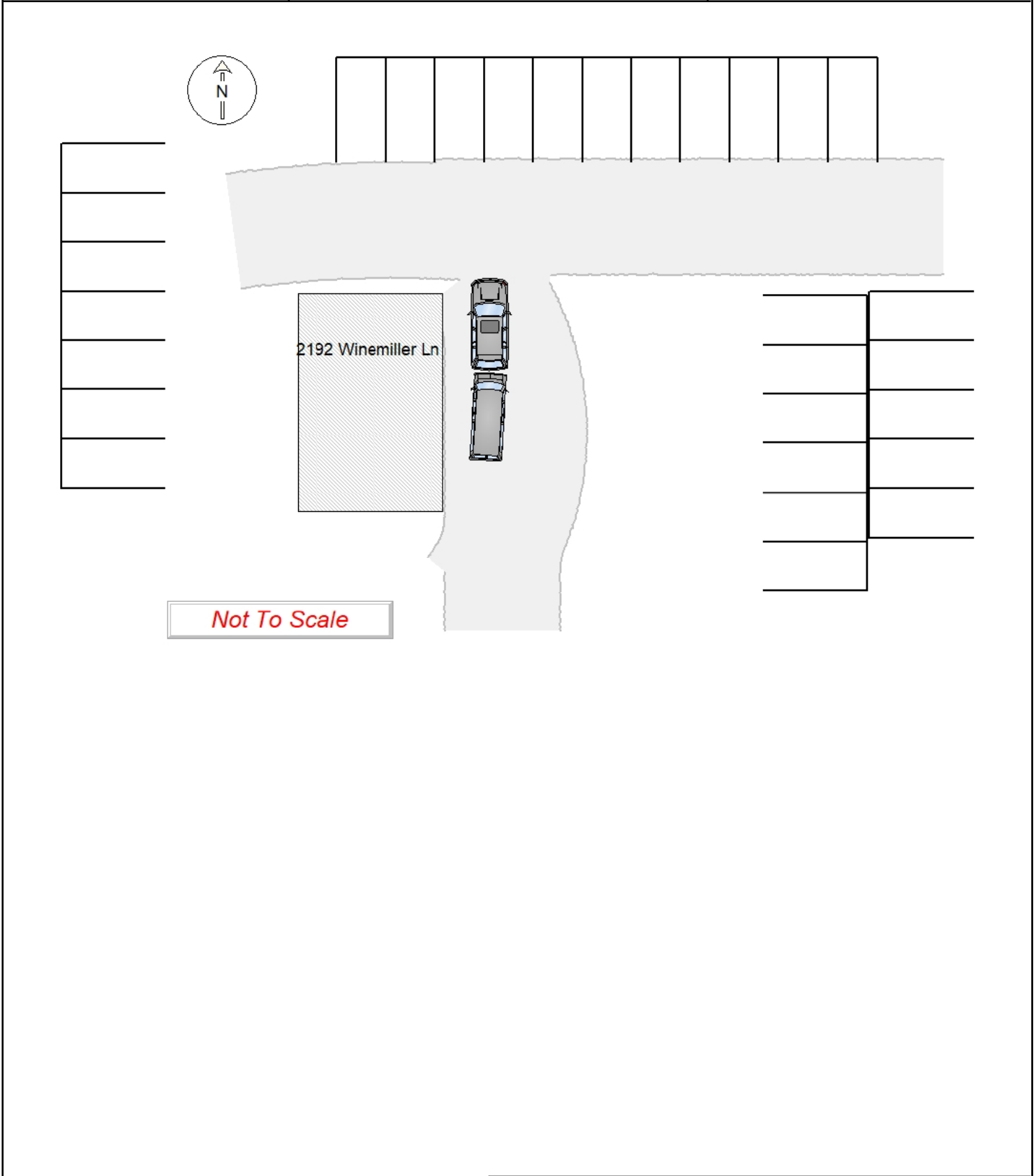

OFFICERS SIGNATURE	BADGE NO. <b>R12228</b>
--------------------	----------------------------