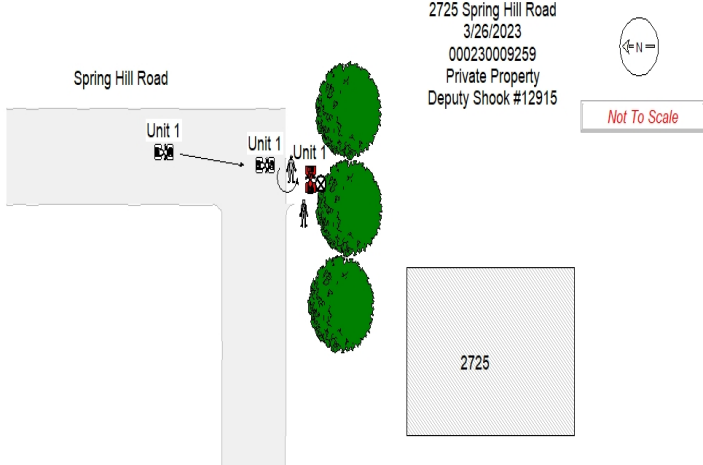

TRAFFIC CRASH REPORT

*DENOTES MANDATORY FIELD FOR SUPPLEMENT REPORT

LOCAL REPORT NUMBER *

000230009259

<input checked="" type="checkbox"/> PHOTOS TAKEN <input type="checkbox"/> SECONDARY CRASH <input checked="" type="checkbox"/> PRIVATE PROPERTY		LOCAL INFORMATION REPORTING AGENCY NAME * Clermont County Sheriff		NCIC * 01300		HIT/SKIP <input type="checkbox"/> 1 - SOLVED <input type="checkbox"/> 2 - UNSOLVED	NUMBER OF UNITS 1	UNIT IN ERROR <input type="checkbox"/> 98 - ANIMAL <input type="checkbox"/> 99 - UNKNOWN
COUNTY* 13	LOCALITY* 1 - CITY 2 - VILLAGE 3 - TOWNSHIP 3	LOCATION: CITY, VILLAGE, TOWNSHIP* Wayne (Township of)			CRASH DATE / TIME* 03/26/2023 16:54		CRASH SEVERITY <input type="checkbox"/> 1 - FATAL <input type="checkbox"/> 2 - SERIOUS INJURY SUSPECTED <input type="checkbox"/> 3 - MINOR INJURY SUSPECTED <input type="checkbox"/> 4 - INJURY POSSIBLE <input type="checkbox"/> 5 - PROPERTY DAMAGE ONLY 3	
ROUTE TYPE LOCATION	ROUTE NUMBER	PREFIX 1 - NORTH 2 - SOUTH 3 - EAST 4 - WEST	LOCATION ROAD NAME Spring Hill		ROAD TYPE RD	LATITUDE DECIMAL DEGREES 39.195680		LONGITUDE DECIMAL DEGREES -84.091720
ROUTE TYPE REFERENCE	ROUTE NUMBER	PREFIX 1 - NORTH 2 - SOUTH 3 - EAST 4 - WEST	REFERENCE ROAD NAME (ROAD, MILEPOST, HOUSE #) 2725		ROAD TYPE	LONGITUDE DECIMAL DEGREES		
REFERENCE POINT <input type="checkbox"/> 1 - INTERSECTION <input checked="" type="checkbox"/> 2 - MILE POST <input type="checkbox"/> 3 - HOUSE #	DIRECTION FROM REFERENCE <input type="checkbox"/> 1 - NORTH <input type="checkbox"/> 2 - SOUTH <input type="checkbox"/> 3 - EAST <input type="checkbox"/> 4 - WEST	ROUTE TYPE IR - INTERSTATE ROUTE (TP) US - FEDERAL US ROUTE SR - STATE ROUTE CR - NUMBERED COUNTY ROUTE TR - NUMBERED TOWNSHIP ROUTE	ROAD TYPE AL - ALLEY AV - AVENUE BL - BOULEVARD CR - CIRCLE CT - COURT DR - DRIVE HE - HEIGHTS	ROAD TYPE HW - HIGHWAY LA - LANE MP - MILEPOST OV - OVAL PK - PARKWAY PI - PIKE PL - PLACE	RD - ROAD SQ - SQUARE ST - STREET TE - TERRACE TL - TRAIL WA - WAY	INTERSECTION RELATED <input type="checkbox"/> WITHIN INTERSECTION OR ON APPROACH <input type="checkbox"/> WITHIN INTERCHANGE AREA NUMBER OF APPROACHES		
DISTANCE FROM REFERENCE	DISTANCE UNIT OF MEASURE <input type="checkbox"/> 1 - MILES <input type="checkbox"/> 2 - FEET <input type="checkbox"/> 3 - YARDS	ROUTE TYPE CR - NUMBERED COUNTY ROUTE TR - NUMBERED TOWNSHIP ROUTE	ROAD TYPE AL - ALLEY AV - AVENUE BL - BOULEVARD CR - CIRCLE CT - COURT DR - DRIVE HE - HEIGHTS	ROAD TYPE HW - HIGHWAY LA - LANE MP - MILEPOST OV - OVAL PK - PARKWAY PI - PIKE PL - PLACE	RD - ROAD SQ - SQUARE ST - STREET TE - TERRACE TL - TRAIL WA - WAY	ROADWAY <input type="checkbox"/> ROADWAY DIVIDED		
LOCATION OF FIRST HARMFUL EVENT <input checked="" type="checkbox"/> 1 - ON ROADWAY <input type="checkbox"/> 2 - ON SHOULDER <input type="checkbox"/> 3 - IN MEDIAN <input type="checkbox"/> 4 - ON ROADSIDE <input type="checkbox"/> 5 - ON GORE <input type="checkbox"/> 6 - OUTSIDE TRAFFIC WAY <input type="checkbox"/> 7 - ON RAMP <input type="checkbox"/> 8 - OFF RAMP	9 - CROSSOVER 10 - DRIVEWAY/ALLEY ACCESS 11 - RAILWAY GRADE CROSSING 12 - SHARED USE PATHS OR TRAILS 13 - BIKE LANE 14 - TOLL BOOTH 99 - OTHER / UNKNOWN	MANNER OF CRASH COLLISION/IMPACT <input type="checkbox"/> 1 - NOT COLLISION BETWEEN TWO MOTOR VEHICLES IN TRANSPORT <input type="checkbox"/> 2 - REAR-END <input type="checkbox"/> 3 - HEAD-ON <input type="checkbox"/> 4 - REAR-TO-REAR <input type="checkbox"/> 5 - BACKING <input type="checkbox"/> 6 - ANGLE <input type="checkbox"/> 7 - SIDESWIPE, SAME DIRECTION <input type="checkbox"/> 8 - SIDESWIPE, OPPOSITE DIRECTION <input type="checkbox"/> 9 - OTHER / UNKNOWN	DIRECTION OF TRAVEL <input type="checkbox"/> 1 - NORTH <input type="checkbox"/> 2 - SOUTH <input type="checkbox"/> 3 - EAST <input type="checkbox"/> 4 - WEST	MEDIAN TYPE <input type="checkbox"/> 1 - DIVIDED FLUSH MEDIAN (< 4 FEET) <input type="checkbox"/> 2 - DIVIDED FLUSH MEDIAN (≥ 4 FEET) <input type="checkbox"/> 3 - DIVIDED, DEPRESSED MEDIAN <input type="checkbox"/> 4 - DIVIDED, RAISED MEDIAN (ANY TYPE) <input type="checkbox"/> 9 - OTHER / UNKNOWN				
<input type="checkbox"/> WORK ZONE RELATED <input type="checkbox"/> WORKERS PRESENT <input type="checkbox"/> LAW ENFORCEMENT PRESENT <input type="checkbox"/> ACTIVE SCHOOL ZONE	WORK ZONE TYPE <input type="checkbox"/> 1 - LANE CLOSURE <input type="checkbox"/> 2 - LANE SHIFT/ CROSSOVER <input type="checkbox"/> 3 - WORK ON SHOULDER OR MEDIAN <input type="checkbox"/> 4 - INTERMITTENT OR MOVING WORK <input type="checkbox"/> 5 - OTHER	LOCATION OF CRASH IN WORK ZONE <input type="checkbox"/> 1 - BEFORE THE 1ST WORK ZONE WARNING SIGN <input type="checkbox"/> 2 - ADVANCE WARNING AREA <input type="checkbox"/> 3 - TRANSITION AREA <input type="checkbox"/> 4 - ACTIVITY AREA <input type="checkbox"/> 5 - TERMINATION AREA	CONTOUR <input type="checkbox"/> 1 1 - STRAIGHT LEVEL 2 - STRAIGHT GRADE 3 - CURVE LEVEL 4 - CURVE GRADE 9 - OTHER / UNKNOWN	CONDITIONS <input type="checkbox"/> 1 1 - DRY 2 - WET 3 - SNOW 4 - ICE 5 - SAND, MUD, DIRT, OIL, GRAVEL 6 - WATER (STANDING, MOVING) 7 - SLUSH 9 - OTHER / UNKNOWN	SURFACE <input type="checkbox"/> 4 1 - CONCRETE 2 - BLACKTOP, BITUMINOUS, ASPHALT 3 - BRICK/BLOCK 4 - SLAG, GRAVEL, STONE 5 - DIRT 9 - OTHER / UNKNOWN			
LIGHT CONDITION <input type="checkbox"/> 1 1 - DAYLIGHT 2 - DAWN/DUSK 3 - DARK - LIGHTED ROADWAY 4 - DARK - ROADWAY NOT LIGHTED 5 - DARK - UNKNOWN ROADWAY LIGHTING 9 - OTHER / UNKNOWN	WEATHER <input type="checkbox"/> 1 1 - CLEAR 2 - CLOUDY 3 - FOG, SMOG, SMOKE 4 - RAIN 5 - SLEET, HAIL 6 - SNOW 7 - SEVERE CROSSWINDS 8 - BLOWING SAND, SOIL, DIRT, SNOW 9 - FREEZING RAIN OR FREEZING DRIZZLE 99 - OTHER / UNKNOWN	DIRECTION OF TRAVEL <input type="checkbox"/> 1 - NORTH <input type="checkbox"/> 2 - SOUTH <input type="checkbox"/> 3 - EAST <input type="checkbox"/> 4 - WEST	MEDIAN TYPE <input type="checkbox"/> 1 - DIVIDED FLUSH MEDIAN (< 4 FEET) <input type="checkbox"/> 2 - DIVIDED FLUSH MEDIAN (≥ 4 FEET) <input type="checkbox"/> 3 - DIVIDED, DEPRESSED MEDIAN <input type="checkbox"/> 4 - DIVIDED, RAISED MEDIAN (ANY TYPE) <input type="checkbox"/> 9 - OTHER / UNKNOWN					
NARRATIVE Unit one is an ATV. Unit one was traveling southbound on a private gravel drive when it failed to negotiate a curve and caused the two riders to fall off. One one then came to final rest in a tree line.					2725 Spring Hill Road 3/26/2023 000230009259 Private Property Deputy Shook #12915 			
CRASH REPORTED DATE / TIME 03/26/2023 16:54		DISPATCH DATE / TIME 03/26/2023 16:56		ARRIVAL DATE / TIME 03/26/2023 17:04		SCENE CLEARED DATE / TIME 03/26/2023 17:45		REPORT TAKEN BY <input checked="" type="checkbox"/> POLICE AGENCY <input type="checkbox"/> MOTORIST
TOTAL TIME ROADWAY CLOSED	OTHER INVESTIGATION TIME	TOTAL MINUTES 49	OFFICER'S NAME* Deputy Shook #12915		CHECKED BY OFFICER'S NAME* Rudd, J		<input checked="" type="checkbox"/> SUPPLEMENT (CORRECTION OR ADDITION TO AN EXISTING REPORT SENT TO ODPS)	
			OFFICER'S BADGE NUMBER* 12915		CHECKED BY OFFICER'S BADGE NUMBER* R3052			

UNIT # 1	OWNER NAME: LAST, FIRST, MIDDLE (<input type="checkbox"/> SAME AS DRIVER) MACHADO, CAROLINE, E	OWNER PHONE: INCLUDE AREA CODE (<input type="checkbox"/> SAME AS DRIVER)
OWNER ADDRESS: STREET, CITY, STATE, ZIP (<input type="checkbox"/> SAME AS DRIVER) 2637 LAKE PINE DRIVE, GOSHEN, OH, 45122		
COMMERCIAL CARRIER: NAME, ADDRESS, CITY, STATE, ZIP		COMMERCIAL CARRIER PHONE: INCLUDE AREA CODE

LP STATE	LICENSE PLATE #	VEHICLE IDENTIFICATION # M408103474	VEHICLE YEAR 1998	VEHICLE MAKE POLARIS
<input type="checkbox"/> INSURANCE VERIFIED	INSURANCE COMPANY	INSURANCE POLICY #	COLOR RED	VEHICLE MODEL OTHER/UNKNOWN
<input type="checkbox"/> COMMERCIAL <input type="checkbox"/> GOVERNMENT <input type="checkbox"/> IN EMERGENCY RESPONSE		US DOT #	TOWED BY: COMPANY NAME	
<input type="checkbox"/> INTERLOCK DEVICE EQUIPPED	<input type="checkbox"/> HIT/SKIP UNIT	# OCCUPANTS 1	HAZARDOUS MATERIAL CLASS # PLACARD ID #	
TYPE OF USE		VEHICLE WEIGHT GVWR/GCWR 1 - ≤10K LBS. 2 - 10.001 - 26K LBS. 3 - > 26K LBS.	<input type="checkbox"/> MATERIAL RELEASED <input type="checkbox"/> PLACARD	

UNIT TYPE 11	1 - PASSENGER CAR 2 - PASSENGER VAN (MINIVAN) 3 - SPORT UTILITY VEHICLE 4 - PICK UP 5 - CARGO VAN	6 - VAN (9-15 SEATS) 7 - MOTORCYCLE 2-WHEELED 8 - MOTORCYCLE 3-WHEELED 9 - AUTOCYCLE 10 - MOPED OR MOTORIZED BICYCLE 11 - ALL TERRAIN VEHICLE (ATV/UTV)	12 - GOLF CART 13 - SNOWMOBILE 14 - SINGLE UNIT TRUCK 15 - SEMI-TRACTOR 16 - FARM EQUIPMENT 17 - MOTORHOME	18 - LIMO (LIVERY VEHICLE) 19 - BUS (16+ PASSENGERS) 20 - OTHER VEHICLE 21 - HEAVY EQUIPMENT 22 - ANIMAL WITH RIDER OR ANIMAL-DRAWN VEHICLE	23 - PEDESTRIAN/SKATER 24 - WHEELCHAIR (ANY TYPE) 25 - OTHER NON-MOTORIST 26 - BICYCLE 27 - TRAIN 99 - UNKNOWN OR HIT/SKIP
# of TRAILING UNITS	WAS VEHICLE OPERATING IN AUTONOMOUS MODE WHEN CRASH OCCURRED? 0 - NO AUTOMATION 3 - CONDITIONAL AUTOMATION 9 - UNKNOWN 1 - DRIVER ASSISTANCE 4 - HIGH AUTOMATION 2 - PARTIAL AUTOMATION 5 - FULL AUTOMATION				
SPECIAL FUNCTION 1	1 - NONE 2 - TAXI 3 - ELECTRONIC RIDE SHARING 4 - SCHOOL TRANSPORT 5 - BUS - TRANSIT/COMMUTER	6 - BUS - CHARTER/TOUR 7 - BUS - INTERCITY 8 - BUS - SHUTTLE 9 - BUS - OTHER 10 - AMBULANCE	11 - FIRE 12 - MILITARY 13 - POLICE 14 - PUBLIC UTILITY 15 - CONSTRUCTION EQUIP.	16 - FARM 17 - MOWING 18 - SNOW REMOVAL 19 - TOWING 20 - SAFETY SERVICE PATROL	21 - MAIL CARRIER 99 - OTHER / UNKNOWN
CARGO BODY TYPE 1	1 - NO CARGO BODY TYPE / NOT APPLICABLE 2 - BUS 3 - VEHICLE TOWING ANOTHER MOTOR VEHICLE	4 - LOGGING 5 - INTERMODAL CONTAINER CHASSIS 6 - CARGOVAN /ENCLOSED BOX	7 - GRAIN/CHIPS/GRAVEL 8 - POLE 9 - CARGO TANK 10 - FLAT BED	11 - DUMP 12 - CONCRETE MIXER 13 - AUTO TRANSPORTER 14 - GARBAGE/REFUSE	99 - OTHER / UNKNOWN
VEHICLE DEFECTS	1 - TURN SIGNALS 2 - HEAD LAMPS 3 - TAIL LAMPS	4 - BRAKES 5 - STEERING 6 - TIRE BLOWOUT	7 - WORN OR SLICK TIRES 8 - TRAILER EQUIPMENT DEFECTIVE	9 - MOTOR TROUBLE 10 - DISABLED FROM PRIOR ACCIDENT	99 - OTHER / UNKNOWN

NON-MOTORIST LOCATION 3	1 - INTERSECTION - MARKED CROSSWALK 2 - INTERSECTION - UNMARKED CROSSWALK 3 - INTERSECTION - OTHER	4 - MIDBLOCK - MARKED CROSSWALK 5 - TRAVEL LANE - OTHER LOCATION 6 - BICYCLE LANE	7 - SHOULDER/ROADSIDE 8 - SIDEWALK 9 - MEDIAN/CROSSING ISLAND	10 - DRIVEWAY ACCESS 11 - SHARED USE PATHS OR TRAILS 12 - FIRST RESPONDER AT INCIDENT SCENE	99 - OTHER / UNKNOWN
ACTION 3	1 - NON-CONTACT 2 - NON-COLLISION 3 - STRIKING 4 - STRUCK 5 - BOTH STRIKING & STRUCK 9 - OTHER / UNKNOWN	13 - PRE-CRASH ACTIONS 1 - STRAIGHT AHEAD 2 - BACKING 3 - CHANGING LANES 4 - OVERTAKING/PASSING 5 - MAKING RIGHT TURN 6 - MAKING LEFT TURN 7 - MAKING U-TURN 8 - ENTERING TRAFFIC LANE	9 - LEAVING TRAFFIC LANE 10 - PARKED 11 - SLOWING OR STOPPED IN TRAFFIC 12 - DRIVERLESS 13 - NEGOTIATING A CURVE 14 - ENTERING OR CROSSING SPECIFIED LOCATION	15 - WALKING, RUNNING, JOGGING, PLAYING 16 - WORKING 17 - PUSHING VEHICLE 18 - APPROACHING OR LEAVING VEHICLE 19 - STANDING 20 - OTHER NON-MOTORIST	21 - STANDING OUTSIDE DISABLED VEHICLE 99 - OTHER / UNKNOWN
CONTRIBUTING CIRCUMSTANCES 99	1 - NONE 2 - FAILURE TO YIELD 3 - RAN RED LIGHT 4 - RAN STOP SIGN 5 - UNSAFE SPEED 6 - IMPROPER TURN 7 - LEFT OF CENTER	8 - FOLLOWING TOO CLOSE /ACDA 9 - IMPROPER LANE CHANGE 10 - IMPROPER PASSING 11 - DROVE OFF ROAD 12 - IMPROPER BACKING	13 - IMPROPER START FROM A PARKED POSITION 14 - STOPPED OR PARKED ILLEGALLY 15 - SWERVING TO AVOID 16 - WRONG WAY 17 - VISION OBSTRUCTION	18 - OPERATING DEFECTIVE EQUIPMENT 19 - LOAD SHIFTING /FALLING/SPILLING 20 - IMPROPER CROSSING 21 - LYING IN ROADWAY 22 - NOT DISCERNIBLE	23 - OPENING DOOR INTO ROADWAY 99 - OTHER IMPROPER ACTION

SEQUENCE OF EVENTS	1	1 - OVERTURN/ROLLOVER 2 - FIRE/EXPLOSION 3 - IMMERSION 4 - JACKKNIFE 5 - CARGO / EQUIPMENT LOSS OR SHIFT 6 - EQUIPMENT FAILURE	7 - SEPARATION OF UNITS 8 - RAN OFF ROAD RIGHT 9 - RAN OFF ROAD LEFT 10 - CROSS MEDIAN 11 - CROSS CENTERLINE - OPPOSITE DIRECTION OF TRAVEL	EVENTS 12 - DOWNHILL RUNAWAY 13 - OTHER NON-COLLISION 14 - PEDESTRIAN 15 - PEDALCYCLE 16 - RAILWAY VEHICLE 17 - ANIMAL - FARM 18 - ANIMAL - DEER	19 - ANIMAL - OTHER 20 - MOTOR VEHICLE IN TRANSPORT 21 - PARKED MOTOR VEHICLE 22 - WORK ZONE MAINTENANCE EQUIPMENT	23 - STRUCK BY FALLING, SHIFTING CARGO OR ANYTHING SET IN MOTION BY A MOTOR VEHICLE 24 - OTHER MOVABLE OBJECT
FIRST HARMFUL EVENT	1	COLLISION WITH FIXED OBJECT - STRUCK				
MOST HARMFUL EVENT	1	25 - IMPACT ATTENUATOR / CRASH CUSHION 26 - BRIDGE OVERHEAD STRUCTURE 27 - BRIDGE PIER OR ABUTMENT 28 - BRIDGE PARAPET 29 - BRIDGE RAIL 30 - GUARDRAIL FACE	31 - GUARDRAIL END 32 - PORTABLE BARRIER 33 - MEDIAN CABLE BARRIER 34 - MEDIAN GUARDRAIL BARRIER 35 - MEDIAN CONCRETE BARRIER 36 - MEDIAN OTHER BARRIER 37 - TRAFFIC SIGN POST	38 - OVERHEAD SIGN POST 39 - LIGHT / LUMINARIES SUPPORT 40 - UTILITY POLE 41 - OTHER POST, POLE OR SUPPORT 42 - CULVERT 43 - CURB 44 - DITCH	45 - EMBANKMENT 46 - FENCE 47 - MAILBOX 48 - TREE 49 - FIRE HYDRANT 50 - WORK ZONE MAINTENANCE EQUIPMENT 51 - WALL	52 - BUILDING 53 - TUNNEL 54 - OTHER FIXED OBJECT 99 - OTHER / UNKNOWN

LOCAL REPORT NUMBER

000230009259

DAMAGE

DAMAGE SCALE

1 - NONE 3 - FUNCTIONAL DAMAGE
 2 - MINOR DAMAGE 4 - DISABLING DAMAGE
 9 - UNKNOWN

DAMAGED AREA(S)

INDICATE ALL THAT APPLY

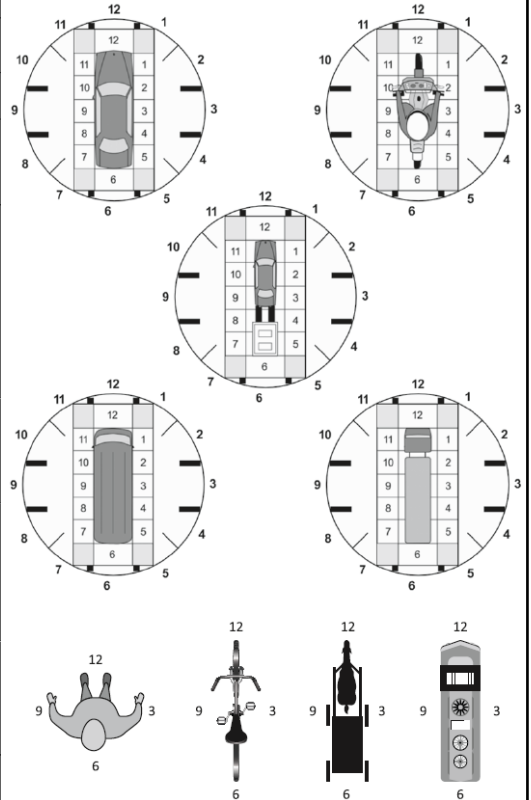

NO DAMAGE [0] UNDERCARRIAGE [14]
 TOP [13] ALL AREAS [15]
 UNIT NOT AT SCENE [16]

INITIAL POINT OF CONTACT

0 - NO DAMAGE 14 - UNDERCARRIAGE
 1-12 - REFER TO UNIT DIAGRAM 15 - VEHICLE NOT AT SCENE
 99 - UNKNOWN 13 - TOP

TRAFFIC

TRAFFICWAY FLOW 1 - ONE-WAY 2 - TWO-WAY	TRAFFIC CONTROL 1 - ROUNDABOUT 4 - STOP SIGN 2 - SIGNAL 5 - YIELD SIGN 3 - FLASHER 6 - NO CONTROL
--	--

# OF THROUGH LANES ON ROAD 1	RAIL GRADE CROSSING 1 - NOT INVOLVED 2 - INVOLVED-ACTIVE CROSSING 3 - INVOLVED-PASSIVE CROSSING
--	---

UNIT / NON-MOTORIST DIRECTION

FROM 1 TO 2

1 - NORTH 5 - NORTHEAST
 2 - SOUTH 6 - NORTHWEST
 3 - EAST 7 - SOUTHEAST
 4 - WEST 8 - SOUTHWEST
 9 - OTHER / UNKNOWN

UNIT SPEED 15	DETECTED SPEED 1 - STATED / ESTIMATED SPEED
POSTED SPEED	1 2 - CALCULATED / EDR 3 - UNDETERMINED

MOTORIST / Non-MOTORIST

LOCAL REPORT NUMBER
000230009259

UNIT # 1	NAME: LAST, FIRST, MIDDLE MACHADO, CAROLINE, E					DATE OF BIRTH 07/27/1980		AGE 42	GENDER F				
ADDRESS: STREET, CITY, STATE, ZIP 2637 LAKE PINE DRIVE, GOSHEN, OH, 45122						CONTACT PHONE - INCLUDE AREA CODE							
INJURIES 3	INJURED TAKEN BY 2	EMS AGENCY (NAME) WAYNE TWP EMS		INJURED TAKEN TO: MEDICAL FACILITY (NAME, CITY) BETHESDA NORTH HOSPITAL		SAFETY EQUIPMENT USED 1	<input type="checkbox"/> DOT-COMPLIANT <input checked="" type="checkbox"/> MC HELMET	SEATING POSITION 1	AIR BAG USAGE 5	EJECTION 3	TRAPPED 1		
OL STATE OH	OPERATOR LICENSE NUMBER			OFFENSE CHARGED		LOCAL CODE <input type="checkbox"/>	OFFENSE DESCRIPTION			CITATION NUMBER			
OL CLASS 4	ENDORSEMENT	RESTRICTION SELECT UP TO 3		DRIVER DISTRACTED BY 1	ALCOHOL / DRUG SUSPECTED <input type="checkbox"/> ALCOHOL <input type="checkbox"/> MARIJUANA <input type="checkbox"/> OTHER DRUG		CONDITION 1	ALCOHOL TEST		DRUG TEST(S)			
								STATUS 1	TYPE 1	VALUE .	STATUS 1	TYPE 1	RESULTS SELECT UP TO 4

UNIT #	NAME: LAST, FIRST, MIDDLE					DATE OF BIRTH		AGE	GENDER				
ADDRESS: STREET, CITY, STATE, ZIP						CONTACT PHONE - INCLUDE AREA CODE							
INJURIES	INJURED TAKEN BY	EMS AGENCY (NAME)		INJURED TAKEN TO: MEDICAL FACILITY (NAME, CITY)		SAFETY EQUIPMENT USED	<input type="checkbox"/> DOT-COMPLIANT <input type="checkbox"/> MC HELMET	SEATING POSITION	AIR BAG USAGE	EJECTION	TRAPPED		
OL STATE	OPERATOR LICENSE NUMBER			OFFENSE CHARGED		LOCAL CODE <input type="checkbox"/>	OFFENSE DESCRIPTION			CITATION NUMBER			
OL CLASS	ENDORSEMENT	RESTRICTION SELECT UP TO 3		DRIVER DISTRACTED BY	ALCOHOL / DRUG SUSPECTED <input type="checkbox"/> ALCOHOL <input type="checkbox"/> MARIJUANA <input type="checkbox"/> OTHER DRUG		CONDITION	ALCOHOL TEST		DRUG TEST(S)			
								STATUS	TYPE	VALUE	STATUS	TYPE	RESULTS SELECT UP TO 4

UNIT #	NAME: LAST, FIRST, MIDDLE					DATE OF BIRTH		AGE	GENDER				
ADDRESS: STREET, CITY, STATE, ZIP						CONTACT PHONE - INCLUDE AREA CODE							
INJURIES	INJURED TAKEN BY	EMS AGENCY (NAME)		INJURED TAKEN TO: MEDICAL FACILITY (NAME, CITY)		SAFETY EQUIPMENT USED	<input type="checkbox"/> DOT-COMPLIANT <input type="checkbox"/> MC HELMET	SEATING POSITION	AIR BAG USAGE	EJECTION	TRAPPED		
OL STATE	OPERATOR LICENSE NUMBER			OFFENSE CHARGED		LOCAL CODE <input type="checkbox"/>	OFFENSE DESCRIPTION			CITATION NUMBER			
OL CLASS	ENDORSEMENT	RESTRICTION SELECT UP TO 3		DRIVER DISTRACTED BY	ALCOHOL / DRUG SUSPECTED <input type="checkbox"/> ALCOHOL <input type="checkbox"/> MARIJUANA <input type="checkbox"/> OTHER DRUG		CONDITION	ALCOHOL TEST		DRUG TEST(S)			
								STATUS	TYPE	VALUE	STATUS	TYPE	RESULTS SELECT UP TO 4

INJURIES	SEATING POSITION	AIR BAG	OL CLASS	OL RESTRICTION(S)	DRIVER DISTRACTION	TEST STATUS
1 - FATAL 2 - SUSPECTED SERIOUS INJURY 3 - SUSPECTED MINOR INJURY 4 - POSSIBLE INJURY 5 - NO APPARENT INJURY	1 - FRONT - LEFT SIDE (MOTORCYCLE DRIVER) 2 - FRONT - MIDDLE 3 - FRONT - RIGHT SIDE 4 - SECOND - LEFT SIDE (MOTORCYCLE PASSENGER) 5 - SECOND - MIDDLE 6 - SECOND - RIGHT SIDE 7 - THIRD - LEFT SIDE (MOTORCYCLE SIDE CAR) 8 - THIRD - MIDDLE 9 - THIRD - RIGHT SIDE 10 - SLEEPER SECTION OF TRUCK CAB 11 - PASSENGER IN OTHER ENCLOSED CARGO AREA (NON-TRAILING UNIT, BUS, PICK-UP WITH CAP) 12 - PASSENGER IN UNENCLOSED CARGO AREA 13 - TRAILING UNIT 14 - RIDING ON VEHICLE EXTERIOR (NON-TRAILING UNIT) 15 - NON-MOTORIST 99 - OTHER / UNKNOWN	1 - NOT DEPLOYED 2 - DEPLOYED FRONT 3 - DEPLOYED SIDE 4 - DEPLOYED BOTH FRONT/SIDE 5 - NOT APPLICABLE 9 - DEPLOYMENT UNKNOWN	1 - CLASS A 2 - CLASS B 3 - CLASS C 4 - REGULAR CLASS (OHIO = D) 5 - M/C MOPED ONLY 6 - NO VALID OL	1 - ALCOHOL INTERLOCK DEVICE 2 - CDL INTRASTATE ONLY 3 - CORRECTIVE LENSES 4 - FARM WAIVER 5 - EXCEPT CLASS A BUS 6 - EXCEPT CLASS A & CLASS B BUS 7 - EXCEPT TRACTOR-TRAILER 8 - INTERMEDIATE LICENSE RESTRICTIONS 9 - LEARNER'S PERMIT RESTRICTIONS 10 - LIMITED TO DAYLIGHT ONLY 11 - LIMITED TO EMPLOYMENT 12 - LIMITED - OTHER 13 - MECHANICAL DEVICES (SPECIAL BRAKES, HAND CONTROLS, OR OTHER ADAPTIVE DEVICES) 14 - MILITARY VEHICLES ONLY 15 - MOTOR VEHICLES WITHOUT AIR BRAKES 16 - OUTSIDE MIRROR 17 - PROSTHETIC AID 18 - OTHER	1 - NOT DISTRACTED 2 - MANUALLY OPERATING AN ELECTRONIC COMMUNICATION DEVICE (TEXTING, TYPING, PHONING) 3 - TALKING ON HANDS-FREE COMMUNICATION DEVICE 4 - TALKING ON HAND-HELD COMMUNICATION DEVICE 5 - OTHER ACTIVITY WITH AN ELECTRONIC DEVICE 6 - PASSENGER 7 - OTHER DISTRACTION INSIDE THE VEHICLE 8 - OTHER DISTRACTION OUTSIDE THE VEHICLE 9 - OTHER / UNKNOWN	1 - NONE GIVEN 2 - TEST REFUSED 3 - TEST GIVEN, CONTAMINATED SAMPLE / UNUSABLE 4 - TEST GIVEN, RESULTS KNOWN 5 - TEST GIVEN, RESULTS UNKNOWN
INJURIES TAKEN BY		EJECTION	OL ENDORSEMENT		CONDITION	ALCOHOL TEST TYPE
1 - NOT TRANSPORTED / TREATED AT SCENE 2 - EMS 3 - POLICE 9 - OTHER / UNKNOWN		1 - NOT EJECTED 2 - PARTIALLY EJECTED 3 - TOTALLY EJECTED 4 - NOT APPLICABLE	H - HAZMAT M - MOTORCYCLE P - PASSENGER N - TANKER Q - MOTOR SCOOTER R - THREE-WHEEL MOTORCYCLE S - SCHOOL BUS T - DOUBLE & TRIPLE TRAILERS X - TANKER / HAZMAT		1 - APPARENTLY NORMAL 2 - PHYSICAL IMPAIRMENT 3 - EMOTIONAL (E.G., DEPRESSED, ANGRY, DISTURBED) 4 - ILLNESS 5 - FELL ASLEEP, FAINTED, FATIGUED, ETC. 6 - UNDER THE INFLUENCE OF MEDICATIONS / DRUGS / ALCOHOL 9 - OTHER / UNKNOWN	1 - NONE 2 - BLOOD 3 - URINE 4 - BREATH 5 - OTHER
SAFETY EQUIPMENT		TRAPPED	GENDER			DRUG TEST TYPE
1 - NONE USED 2 - SHOULDER BELT ONLY USED 3 - LAP BELT ONLY USED 4 - SHOULDER & LAP BELT USED 5 - CHILD RESTRAINT SYSTEM - FORWARD FACING 6 - CHILD RESTRAINT SYSTEM - REAR FACING 7 - BOOSTER SEAT 8 - HELMET USED 9 - PROTECTIVE PADS USED (ELBOWS, KNEES, ETC) 10 - REFLECTIVE CLOTHING 11 - LIGHTING - PEDESTRIAN / BICYCLE ONLY 99 - OTHER / UNKNOWN		1 - NOT TRAPPED 2 - EXTRICATED BY MECHANICAL MEANS 3 - FREED BY NON-MECHANICAL MEANS	F - FEMALE M - MALE U - OTHER / UNKNOWN			DRUG TEST RESULT(S)
						1 - NONE 2 - BLOOD 3 - URINE 4 - OTHER
						1 - AMPHETAMINES 2 - BARBITURATES 3 - BENZODIAZEPINES 4 - CANNABINOIDS 5 - COCAINE 6 - OPIATES / OPIOIDS 7 - OTHER 8 - NEGATIVE RESULTS

OCCUPANT / WITNESS ADDENDUM

LOCAL REPORT NUMBER
000230009259

OCCUPANT	UNIT # 1	NAME: LAST, FIRST, MIDDLE FLOHN, GEORGE				DATE OF BIRTH 05/04/2009		AGE 13	GENDER M	
	ADDRESS: STREET, CITY, STATE, ZIP 2637 LAKE PINE DRIVE, GOSHEN, OH, 45122					CONTACT PHONE - INCLUDE AREA CODE				
INJURIES 3	INJURED TAKEN BY 1	EMS AGENCY (NAME) WAYNE/ STONELICK TWP EMS	INJURED TAKEN TO: MEDICAL FACILITY (NAME, CITY)	SAFETY EQUIPMENT 1	<input type="checkbox"/> DOT-COMPLIANT MC HELMET	SEATING POSITION 4	AIR BAG USAGE 1	EJECTION 3	TRAPPED 1	

OCCUPANT	UNIT #	NAME: LAST, FIRST, MIDDLE				DATE OF BIRTH		AGE	GENDER	
	ADDRESS: STREET, CITY, STATE, ZIP					CONTACT PHONE - INCLUDE AREA CODE				
INJURIES	INJURED TAKEN BY	EMS AGENCY (NAME)	INJURED TAKEN TO: MEDICAL FACILITY (NAME, CITY)	SAFETY EQUIPMENT	<input type="checkbox"/> DOT-COMPLIANT MC HELMET	SEATING POSITION	AIR BAG USAGE	EJECTION	TRAPPED	

OCCUPANT	UNIT #	NAME: LAST, FIRST, MIDDLE				DATE OF BIRTH		AGE	GENDER	
	ADDRESS: STREET, CITY, STATE, ZIP					CONTACT PHONE - INCLUDE AREA CODE				
INJURIES	INJURED TAKEN BY	EMS AGENCY (NAME)	INJURED TAKEN TO: MEDICAL FACILITY (NAME, CITY)	SAFETY EQUIPMENT	<input type="checkbox"/> DOT-COMPLIANT MC HELMET	SEATING POSITION	AIR BAG USAGE	EJECTION	TRAPPED	

OCCUPANT	UNIT #	NAME: LAST, FIRST, MIDDLE				DATE OF BIRTH		AGE	GENDER	
	ADDRESS: STREET, CITY, STATE, ZIP					CONTACT PHONE - INCLUDE AREA CODE				
INJURIES	INJURED TAKEN BY	EMS AGENCY (NAME)	INJURED TAKEN TO: MEDICAL FACILITY (NAME, CITY)	SAFETY EQUIPMENT	<input type="checkbox"/> DOT-COMPLIANT MC HELMET	SEATING POSITION	AIR BAG USAGE	EJECTION	TRAPPED	

INJURIES	SAFETY EQUIPMENT USED	SEATING POSITION	AIR BAG USAGE
1 - FATAL 2 - SUSPECTED SERIOUS INJURY 3 - SUSPECTED MINOR INJURY 4 - POSSIBLE INJURY 5 - NO APPARENT INJURY	1 - NONE USED - VEHICLE OCCUPANT 2 - SHOULDER BELT ONLY USED 3 - LAP BELT ONLY USED 4 - SHOULDER & LAP BELT USED 5 - CHILD RESTRAINT SYSTEM - FORWARD FACING 6 - CHILD RESTRAINT SYSTEM - REAR FACING 7 - BOOSTER SEAT 8 - HELMET USED 9 - PROTECTIVE PADS USED (ELBOWS, KNEES, ETC) 10 - REFLECTIVE CLOTHING 11 - LIGHTING - PEDESTRIAN / BICYCLE ONLY 99 - OTHER / UNKNOWN	1 - FRONT - LEFT SIDE (MOTORCYCLE DRIVER) 2 - FRONT - MIDDLE 3 - FRONT - RIGHT SIDE 4 - SECOND - LEFT SIDE (MOTORCYCLE PASSENGER) 5 - SECOND - MIDDLE 6 - SECOND - RIGHT SIDE 7 - THIRD - LEFT SIDE (MOTORCYCLE SIDE CAR) 8 - THIRD - MIDDLE 9 - THIRD - RIGHT SIDE 10 - SLEEPER SECTION OF TRUCK CAB 11 - PASSENGER IN OTHER ENCLOSED CARGO AREA (NON-TRAILING UNIT SUCH AS A BUS, PICK-UP WITH CAP) 12 - PASSENGER IN UNENCLOSED CARGO AREA 13 - TRAILING UNIT 14 - RIDING ON VEHICLE EXTERIOR (NON-TRAILING UNIT) 15 - NON-MOTORIST 99 - OTHER / UNKNOWN	1 - NOT DEPLOYED 2 - DEPLOYED FRONT 3 - DEPLOYED SIDE 4 - DEPLOYED BOTH FRONT/SIDE 5 - NOT APPLICABLE 9 - DEPLOYMENT UNKNOWN
INJURED TAKEN BY			EJECTION
1 - NOT TRANSPORTED / TREATED AT SCENE 2 - EMS 3 - POLICE 9 - OTHER / UNKNOWN			1 - NOT EJECTED 2 - PARTIALLY EJECTED 3 - TOTALLY EJECTED 4 - NOT APPLICABLE
GENDER			TRAPPED
F - FEMALE M - MALE U - OTHER / UNKNOWN			1 - NOT TRAPPED 2 - EXTRICATED BY MECHANICAL MEANS 3 - FREED BY NON-MECHANICAL MEANS

WITNESS	NAME: LAST, FIRST, MIDDLE				DATE OF BIRTH		AGE	GENDER	
	ADDRESS: STREET, CITY, STATE, ZIP					CONTACT PHONE - INCLUDE AREA CODE			

WITNESS	NAME: LAST, FIRST, MIDDLE				DATE OF BIRTH		AGE	GENDER	
	ADDRESS: STREET, CITY, STATE, ZIP					CONTACT PHONE - INCLUDE AREA CODE			

WITNESS	NAME: LAST, FIRST, MIDDLE				DATE OF BIRTH		AGE	GENDER	
	ADDRESS: STREET, CITY, STATE, ZIP					CONTACT PHONE - INCLUDE AREA CODE			

OHIO TRAFFIC ACCIDENT - OH2 DIAGRAM

LOCAL REPORT NUMBER 000230009259	REPORTING AGENCY Clermont County Sheriff	Date Of Crash 03/26/2023
IN COUNTY OF Clermont County	ACCIDENT LOCATION Spring Hill	

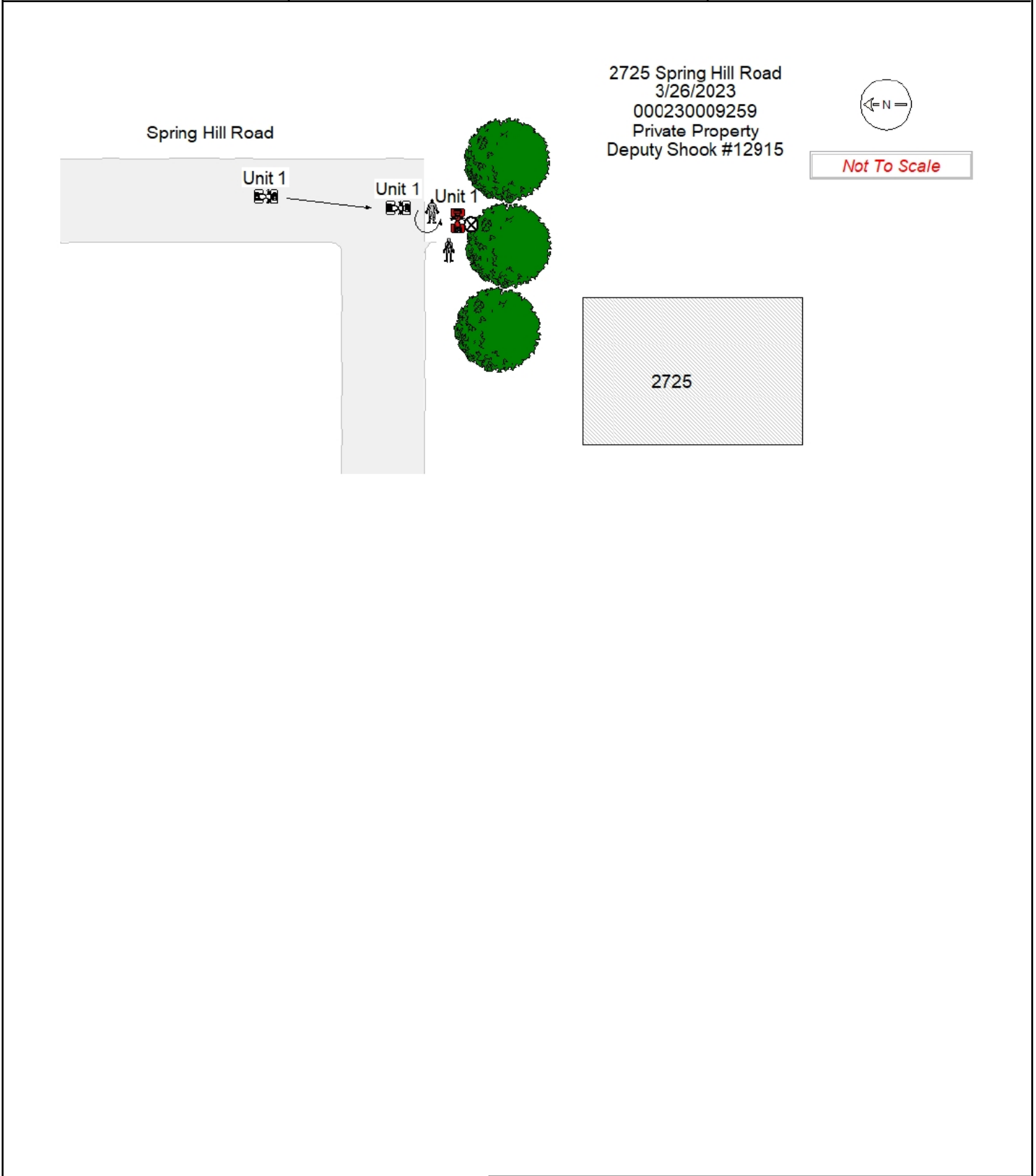

2725 Spring Hill Road
3/26/2023
000230009259
Private Property
Deputy Shook #12915



Not To Scale

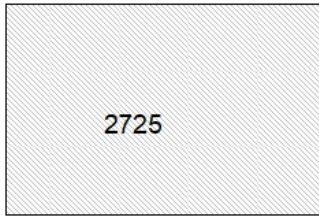

OFFICERS SIGNATURE	BADGE NO. 12915
--------------------	---------------------------