

TRAFFIC CRASH REPORT

*DENOTES MANDATORY FIELD FOR SUPPLEMENT REPORT

LOCAL REPORT NUMBER *

000230017514

<input checked="" type="checkbox"/> PHOTOS TAKEN <input type="checkbox"/> SECONDARY CRASH <input checked="" type="checkbox"/> PRIVATE PROPERTY		<input type="checkbox"/> OH -2 <input type="checkbox"/> OH -3 <input type="checkbox"/> OH-1P <input type="checkbox"/> OTHER		LOCAL INFORMATION REPORTING AGENCY NAME * Clermont County Sheriff		NCIC * 01300		HIT/SKIP <input checked="" type="checkbox"/> 1 - SOLVED <input type="checkbox"/> 2 - UNSOLVED		NUMBER OF UNITS 2		UNIT IN ERROR <input type="checkbox"/> 98 - ANIMAL <input type="checkbox"/> 99 - UNKNOWN			
COUNTY* 13		LOCALITY* 1 - CITY 2 - VILLAGE 3 - TOWNSHIP 3		LOCATION: CITY, VILLAGE, TOWNSHIP* Batavia		CRASH DATE / TIME* 06/06/2023 07:31		CRASH SEVERITY <input type="checkbox"/> 1 - FATAL <input type="checkbox"/> 2 - SERIOUS INJURY SUSPECTED <input type="checkbox"/> 3 - MINOR INJURY SUSPECTED <input type="checkbox"/> 4 - INJURY POSSIBLE <input type="checkbox"/> 5 - PROPERTY DAMAGE ONLY 5							
LOCATION ROUTE TYPE ROUTE NUMBER PREFIX 1 - NORTH 2 - SOUTH 3 - EAST 4 - WEST	LOCATION ROAD NAME Hospital	ROAD TYPE DR	LATITUDE DECIMAL DEGREES 39.079990	REFERENCE ROUTE TYPE ROUTE NUMBER PREFIX 1 - NORTH 2 - SOUTH 3 - EAST 4 - WEST	REFERENCE ROAD NAME (ROAD, MILEPOST, HOUSE #) 3020	ROAD TYPE	LONGITUDE DECIMAL DEGREES -84.144429								
REFERENCE POINT 1 - INTERSECTION <input type="checkbox"/> 2 - MILE POST <input type="checkbox"/> 3 - HOUSE # 3		DIRECTION FROM REFERENCE 1 - NORTH <input type="checkbox"/> 2 - SOUTH <input type="checkbox"/> 3 - EAST <input type="checkbox"/> 4 - WEST 2		ROUTE TYPE IR - INTERSTATE ROUTE (TP) US - FEDERAL US ROUTE SR - STATE ROUTE CR - NUMBERED COUNTY ROUTE TR - NUMBERED TOWNSHIP ROUTE		ROAD TYPE AL - ALLEY HW - HIGHWAY RD - ROAD AV - AVENUE LA - LANE SQ - SQUARE BL - BOULEVARD MP - MILEPOST ST - STREET CR - CIRCLE OV - OVAL TE - TERRACE CT - COURT PK - PARKWAY TL - TRAIL DR - DRIVE PI - PIKE WA - WAY HE - HEIGHTS PL - PLACE		INTERSECTION RELATED <input type="checkbox"/> WITHIN INTERSECTION OR ON APPROACH <input type="checkbox"/> WITHIN INTERCHANGE AREA NUMBER OF APPROACHES							
DISTANCE FROM REFERENCE 75.00		DISTANCE UNIT OF MEASURE 1 - MILES <input type="checkbox"/> 2 - FEET <input type="checkbox"/> 3 - YARDS 3		ROADWAY <input type="checkbox"/> ROADWAY DIVIDED											
LOCATION OF FIRST HARMFUL EVENT <input type="checkbox"/> 1 - ON ROADWAY <input type="checkbox"/> 2 - ON SHOULDER <input type="checkbox"/> 3 - IN MEDIAN <input type="checkbox"/> 4 - ON ROADSIDE <input type="checkbox"/> 5 - ON GORE <input type="checkbox"/> 6 - OUTSIDE TRAFFIC WAY <input type="checkbox"/> 7 - ON RAMP <input type="checkbox"/> 8 - OFF RAMP 99			MANNER OF CRASH COLLISION/IMPACT <input type="checkbox"/> 1 - NOT COLLISION BETWEEN TWO MOTOR VEHICLES IN TRANSPORT <input type="checkbox"/> 2 - REAR-END <input type="checkbox"/> 3 - HEAD-ON <input type="checkbox"/> 4 - REAR-TO-REAR <input type="checkbox"/> 5 - BACKING <input type="checkbox"/> 6 - ANGLE <input type="checkbox"/> 7 - SIDESWIPE, SAME DIRECTION <input type="checkbox"/> 8 - SIDESWIPE, OPPOSITE DIRECTION <input type="checkbox"/> 9 - OTHER / UNKNOWN 9			DIRECTION OF TRAVEL 1 - NORTH <input type="checkbox"/> 2 - SOUTH <input type="checkbox"/> 3 - EAST <input type="checkbox"/> 4 - WEST		MEDIAN TYPE <input type="checkbox"/> 1 - DIVIDED FLUSH MEDIAN (< 4 FEET) <input type="checkbox"/> 2 - DIVIDED FLUSH MEDIAN (≥ 4 FEET) <input type="checkbox"/> 3 - DIVIDED, DEPRESSED MEDIAN <input type="checkbox"/> 4 - DIVIDED, RAISED MEDIAN (ANY TYPE) <input type="checkbox"/> 9 - OTHER / UNKNOWN							
<input type="checkbox"/> WORK ZONE RELATED <input type="checkbox"/> WORKERS PRESENT <input type="checkbox"/> LAW ENFORCEMENT PRESENT <input type="checkbox"/> ACTIVE SCHOOL ZONE		WORK ZONE TYPE 1 - LANE CLOSURE 2 - LANE SHIFT/ CROSSOVER <input type="checkbox"/> 3 - WORK ON SHOULDER OR MEDIAN 4 - INTERMITTENT OR MOVING WORK 5 - OTHER		LOCATION OF CRASH IN WORK ZONE <input type="checkbox"/> 1 - BEFORE THE 1ST WORK ZONE WARNING SIGN <input type="checkbox"/> 2 - ADVANCE WARNING AREA <input type="checkbox"/> 3 - TRANSITION AREA <input type="checkbox"/> 4 - ACTIVITY AREA <input type="checkbox"/> 5 - TERMINATION AREA		CONTOUR <input type="checkbox"/> 1 - STRAIGHT LEVEL <input type="checkbox"/> 2 - STRAIGHT GRADE <input type="checkbox"/> 3 - CURVE LEVEL <input type="checkbox"/> 4 - CURVE GRADE <input type="checkbox"/> 9 - OTHER / UNKNOWN 1		CONDITIONS <input type="checkbox"/> 1 - DRY <input type="checkbox"/> 2 - WET <input type="checkbox"/> 3 - SNOW <input type="checkbox"/> 4 - ICE <input type="checkbox"/> 5 - SAND, MUD, DIRT, OIL, GRAVEL <input type="checkbox"/> 6 - WATER (STANDING, MOVING) <input type="checkbox"/> 7 - SLUSH <input type="checkbox"/> 9 - OTHER / UNKNOWN 1		SURFACE <input type="checkbox"/> 1 - CONCRETE <input type="checkbox"/> 2 - BLACKTOP, BITUMINOUS, ASPHALT <input type="checkbox"/> 3 - BRICK/BLOCK <input type="checkbox"/> 4 - SLAG, GRAVEL, STONE <input type="checkbox"/> 5 - DIRT <input type="checkbox"/> 9 - OTHER / UNKNOWN 2					
LIGHT CONDITION <input type="checkbox"/> 1 - DAYLIGHT <input type="checkbox"/> 2 - DAWN/DUSK <input type="checkbox"/> 3 - DARK - LIGHTED ROADWAY <input type="checkbox"/> 4 - DARK - ROADWAY NOT LIGHTED <input type="checkbox"/> 5 - DARK - UNKNOWN ROADWAY LIGHTING <input type="checkbox"/> 9 - OTHER / UNKNOWN 1			WEATHER <input type="checkbox"/> 1 - CLEAR <input type="checkbox"/> 2 - CLOUDY <input type="checkbox"/> 3 - FOG, SMOG, SMOKE <input type="checkbox"/> 4 - RAIN <input type="checkbox"/> 5 - SLEET, HAIL <input type="checkbox"/> 6 - SNOW <input type="checkbox"/> 7 - SEVERE CROSSWINDS <input type="checkbox"/> 8 - BLOWING SAND, SOIL, DIRT, SNOW <input type="checkbox"/> 9 - FREEZING RAIN OR FREEZING DRIZZLE <input type="checkbox"/> 99 - OTHER / UNKNOWN 1			CRASH REPORTED DATE / TIME 06/06/2023 07:31		DISPATCH DATE / TIME 06/06/2023 11:17		ARRIVAL DATE / TIME 06/06/2023 11:33		SCENE CLEARED DATE / TIME 06/06/2023 12:02		REPORT TAKEN BY <input checked="" type="checkbox"/> POLICE AGENCY <input type="checkbox"/> MOTORIST	
NARRATIVE Unit 1 struck unit 2 as it was leaving the parking lot.								TOTAL TIME ROADWAY CLOSED OTHER INVESTIGATION TIME		TOTAL MINUTES 45		OFFICER'S NAME* Jester, C		CHECKED BY OFFICER'S NAME* Rudd, J	
				OFFICER'S BADGE NUMBER* R12834		CHECKED BY OFFICER'S BADGE NUMBER* R3052		<input checked="" type="checkbox"/> SUPPLEMENT <small>(CORRECTION OR ADDITION TO AN EXISTING REPORT SENT TO ODPS)</small>							

UNIT # 1 **OWNER NAME:** LAST, FIRST, MIDDLE (SAME AS DRIVER) **OWNER PHONE:** INCLUDE AREA CODE (SAME AS DRIVER)
OWNER ADDRESS: STREET, CITY, STATE, ZIP (SAME AS DRIVER)
 3111 SR 132, AMELIA, OH, 45102
COMMERCIAL CARRIER: NAME, ADDRESS, CITY, STATE, ZIP **COMMERCIAL CARRIER PHONE:** INCLUDE AREA CODE

LP STATE OH **LICENSE PLATE #** GXX7472 **VEHICLE IDENTIFICATION #** 3GCUKREC3GG282353 **VEHICLE YEAR** 2016 **VEHICLE MAKE** CHEVROLET
 INSURANCE VERIFIED **INSURANCE COMPANY** GEICO **INSURANCE POLICY #** 4127-02-23-43 **COLOR** SIL **VEHICLE MODEL** SILVERADO
 COMMERCIAL **GOVERNMENT** **IN EMERGENCY RESPONSE** **US DOT #** **TOWED BY:** COMPANY NAME
 INTERLOCK DEVICE EQUIPPED **HIT/SKIP UNIT** **# OCCUPANTS** **VEHICLE WEIGHT GVWR/GCWR**
 1 - ≤ 10K LBS.
 2 - 10.001 - 26K LBS.
 3 - > 26K LBS.
 MATERIAL RELEASED **CLASS #** **PLACARD ID #**

UNIT TYPE 99
 1 - PASSENGER CAR 6 - VAN (9-15 SEATS) 12 - GOLF CART 18 - LIMO (LIVERY VEHICLE) 23 - PEDESTRIAN/SKATER
 2 - PASSENGER VAN 7 - MOTORCYCLE 2-WHEELED 13 - SNOWMOBILE 19 - BUS (16+ PASSENGERS) 24 - WHEELCHAIR (ANY TYPE)
 3 - SPORT UTILITY VEHICLE 8 - MOTORCYCLE 3-WHEELED 14 - SINGLE UNIT TRUCK 20 - OTHER VEHICLE 25 - OTHER NON-MOTORIST
 4 - PICK UP 9 - AUTOCYCLE 15 - SEMI-TRACTOR 21 - HEAVY EQUIPMENT 26 - BICYCLE
 5 - CARGO VAN 10 - MOPED OR MOTORIZED BICYCLE 16 - FARM EQUIPMENT 22 - ANIMAL WITH RIDER OR ANIMAL-DRAWN VEHICLE 27 - TRAIN
 11 - ALL TERRAIN VEHICLE (ATV/UTV) 17 - MOTORHOME 99 - UNKNOWN OR HIT/SKIP
of TRAILING UNITS
 WAS VEHICLE OPERATING IN **AUTONOMOUS MODE** WHEN CRASH OCCURRED?
 0 - NO AUTOMATION 3 - CONDITIONAL AUTOMATION 9 - UNKNOWN
 1 - DRIVER ASSISTANCE 4 - HIGH AUTOMATION
 2 - PARTIAL AUTOMATION 5 - FULL AUTOMATION
SPECIAL FUNCTION 1
 1 - NONE 6 - BUS - CHARTER/TOUR 11 - FIRE 16 - FARM 21 - MAIL CARRIER
 2 - TAXI 7 - BUS - INTERCITY 12 - MILITARY 17 - MOWING 99 - OTHER / UNKNOWN
 3 - ELECTRONIC RIDE SHARING 8 - BUS - SHUTTLE 13 - POLICE 18 - SNOW REMOVAL
 4 - SCHOOL TRANSPORT 9 - BUS - OTHER 14 - PUBLIC UTILITY 19 - TOWING
 5 - BUS - TRANSIT/COMMUTER 10 - AMBULANCE 15 - CONSTRUCTION EQUIP. 20 - SAFETY SERVICE PATROL
CARGO BODY TYPE 1
 1 - NO CARGO BODY TYPE / NOT APPLICABLE 4 - LOGGING 7 - GRAIN/CHIPS/GRAVEL 11 - DUMP 99 - OTHER / UNKNOWN
 2 - BUS 5 - INTERMODAL CONTAINER CHASSIS 8 - POLE 12 - CONCRETE MIXER
 3 - VEHICLE TOWING ANOTHER MOTOR VEHICLE 6 - CARGOVAN /ENCLOSED BOX 9 - CARGO TANK 13 - AUTO TRANSPORTER
 10 - FLAT BED 14 - GARBAGE/REFUSE
VEHICLE DEFECTS
 1 - TURN SIGNALS 4 - BRAKES 7 - WORN OR SLICK TIRES 9 - MOTOR TROUBLE 99 - OTHER / UNKNOWN
 2 - HEAD LAMPS 5 - STEERING 8 - TRAILER EQUIPMENT DEFECTIVE 10 - DISABLED FROM PRIOR ACCIDENT
 3 - TAIL LAMPS 6 - TIRE BLOWOUT

NON-MOTORIST LOCATION 3
 1 - INTERSECTION - MARKED CROSSWALK 4 - MIDBLOCK - MARKED CROSSWALK 7 - SHOULDER/ROADSIDE 10 - DRIVEWAY ACCESS 99 - OTHER / UNKNOWN
 2 - INTERSECTION - UNMARKED CROSSWALK 5 - TRAVEL LANE - OTHER LOCATION 8 - SIDEWALK 11 - SHARED USE PATHS OR TRAILS
 3 - INTERSECTION - OTHER 6 - BICYCLE LANE 9 - MEDIAN/CROSSING ISLAND 12 - FIRST RESPONDER AT INCIDENT SCENE
ACTION 3
 1 - NON-CONTACT 1 - STRAIGHT AHEAD 9 - LEAVING TRAFFIC LANE 15 - WALKING, RUNNING, JOGGING, PLAYING 21 - STANDING OUTSIDE DISABLED VEHICLE
 2 - NON-COLLISION 2 - BACKING 10 - PARKED 16 - WORKING 99 - OTHER / UNKNOWN
 3 - STRIKING 3 - CHANGING LANES 11 - SLOWING OR STOPPED IN TRAFFIC 17 - PUSHING VEHICLE 18 - APPROACHING OR LEAVING VEHICLE
 4 - STRUCK 4 - OVERTAKING/PASSING 12 - DRIVERLESS 19 - STANDING 20 - OTHER NON-MOTORIST
 5 - BOTH STRIKING & STRUCK 5 - MAKING RIGHT TURN 13 - NEGOTIATING A CURVE 20 - ENTERING OR CROSSING SPECIFIED LOCATION
 9 - OTHER / UNKNOWN 6 - MAKING LEFT TURN 14 - ENTERING OR CROSSING SPECIFIED LOCATION
 7 - MAKING U-TURN 8 - ENTERING TRAFFIC LANE
CONTRIBUTING CIRCUMSTANCES 13
 1 - NONE 8 - FOLLOWING TOO CLOSE /ACDA 13 - IMPROPER START FROM A PARKED POSITION 18 - OPERATING DEFECTIVE EQUIPMENT 23 - OPENING DOOR INTO ROADWAY
 2 - FAILURE TO YIELD 9 - IMPROPER LANE CHANGE 14 - STOPPED OR PARKED ILLEGALLY 19 - LOAD SHIFTING /FALLING/SPILLING 99 - OTHER IMPROPER ACTION
 3 - RAN RED LIGHT 10 - IMPROPER PASSING 15 - SWERVING TO AVOID 20 - IMPROPER CROSSING 21 - LYING IN ROADWAY
 4 - RAN STOP SIGN 11 - DROVE OFF ROAD 16 - WRONG WAY 22 - NOT DISCERNIBLE
 5 - UNSAFE SPEED 12 - IMPROPER BACKING 17 - VISION OBSTRUCTION
 6 - IMPROPER TURN 7 - LEFT OF CENTER

SEQUENCE OF EVENTS
 1 **20** 1 - OVERTURN/ROLLOVER 7 - SEPARATION OF UNITS 12 - DOWNHILL RUNAWAY 19 - ANIMAL - OTHER 23 - STRUCK BY FALLING, SHIFTING CARGO OR ANYTHING SET IN MOTION BY A MOTOR VEHICLE
 2 **21** 2 - FIRE/EXPLOSION 8 - RAN OFF ROAD RIGHT 13 - OTHER NON-COLLISION 20 - MOTOR VEHICLE IN TRANSPORT
 3 - IMMERSION 9 - RAN OFF ROAD LEFT 14 - PEDESTRIAN 21 - PARKED MOTOR VEHICLE
 4 - JACKKNIFE 10 - CROSS MEDIAN 15 - PEDALCYCLE 22 - WORK ZONE MAINTENANCE EQUIPMENT
 5 - CARGO / EQUIPMENT LOSS OR SHIFT 11 - CROSS CENTERLINE - OPPOSITE DIRECTION OF TRAVEL 16 - RAILWAY VEHICLE 23 - STRUCK BY FALLING, SHIFTING CARGO OR ANYTHING SET IN MOTION BY A MOTOR VEHICLE
 6 - EQUIPMENT FAILURE 12 - IMPROPER BACKING 17 - VISION OBSTRUCTION 18 - ANIMAL - DEER 24 - OTHER MOVABLE OBJECT
COLLISION WITH FIXED OBJECT - STRUCK
 25 - IMPACT ATTENUATOR / CRASH CUSHION 31 - GUARDRAIL END 38 - OVERHEAD SIGN POST 45 - EMBANKMENT 52 - BUILDING
 26 - BRIDGE OVERHEAD STRUCTURE 32 - PORTABLE BARRIER 39 - LIGHT / LUMINARIES SUPPORT 46 - FENCE 53 - TUNNEL
 27 - BRIDGE PIER OR ABUTMENT 33 - MEDIAN CABLE BARRIER 40 - UTILITY POLE 47 - MAILBOX 54 - OTHER FIXED OBJECT
 28 - BRIDGE PARAPET 34 - MEDIAN GUARDRAIL BARRIER 41 - OTHER POST, POLE OR SUPPORT 48 - TREE 99 - OTHER / UNKNOWN
 29 - BRIDGE RAIL 35 - MEDIAN CONCRETE BARRIER 42 - CULVERT 49 - FIRE HYDRANT 50 - WORK ZONE MAINTENANCE EQUIPMENT
 30 - GUARDRAIL FACE 36 - MEDIAN OTHER BARRIER 43 - CURB 51 - WALL

FIRST HARMFUL EVENT 1 **MOST HARMFUL EVENT** 1

LOCAL REPORT NUMBER

000230017514

DAMAGE

DAMAGE SCALE

1 - NONE 3 - FUNCTIONAL DAMAGE
 2 - MINOR DAMAGE 4 - DISABLING DAMAGE
 9 - UNKNOWN

DAMAGED AREA(S)

INDICATE ALL THAT APPLY

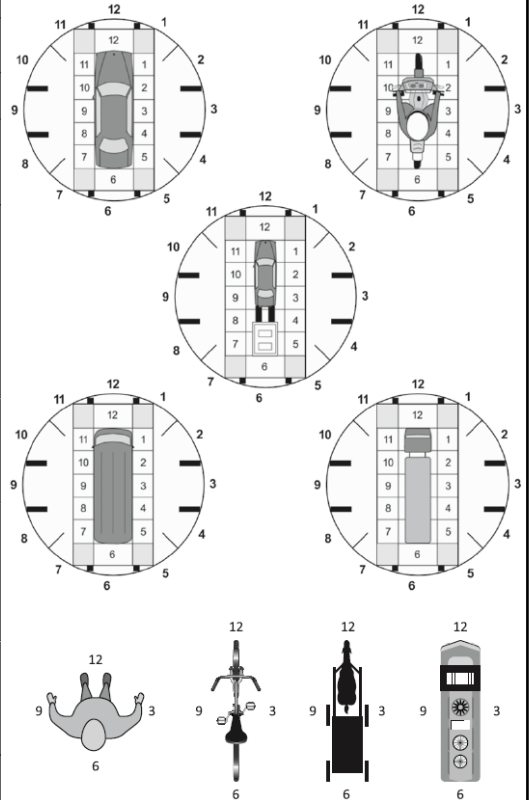

NO DAMAGE [0] **UNDERCARRIAGE** [14]
 TOP [13] **ALL AREAS** [15]
 UNIT NOT AT SCENE [16]

INITIAL POINT OF CONTACT

0 - NO DAMAGE 14 - UNDERCARRIAGE
 1-12 - REFER TO UNIT DIAGRAM 15 - VEHICLE NOT AT SCENE
 99 - UNKNOWN
 13 - TOP

TRAFFIC

TRAFFICWAY FLOW 2
 1 - ONE-WAY
 2 - TWO-WAY
TRAFFIC CONTROL 6
 1 - ROUNDABOUT 4 - STOP SIGN
 2 - SIGNAL 5 - YIELD SIGN
 3 - FLASHER 6 - NO CONTROL

OF THROUGH LANES ON ROAD 2
RAIL GRADE CROSSING 1
 1 - NOT INVOLVED
 2 - INVOLVED-ACTIVE CROSSING
 3 - INVOLVED-PASSIVE CROSSING

UNIT / NON-MOTORIST DIRECTION

FROM 4 TO 3
 1 - NORTH 5 - NORTHEAST
 2 - SOUTH 6 - NORTHWEST
 3 - EAST 7 - SOUTHEAST
 4 - WEST 8 - SOUTHWEST
 9 - OTHER / UNKNOWN

UNIT SPEED 5
POSTED SPEED 15
DETECTED SPEED 1
 1 - STATED / ESTIMATED SPEED
 2 - CALCULATED / EDR
 3 - UNDETERMINED

OWNER

UNIT # 2 **OWNER NAME:** LAST, FIRST, MIDDLE (SAME AS DRIVER)
OWNER PHONE: INCLUDE AREA CODE (SAME AS DRIVER)
OWNER ADDRESS: STREET, CITY, STATE, ZIP (SAME AS DRIVER)
 112 S 4TH ST, BATAVIA, OH, 45103
COMMERCIAL CARRIER: NAME, ADDRESS, CITY, STATE, ZIP **COMMERCIAL CARRIER PHONE:** INCLUDE AREA CODE

VEHICLE

LP STATE OH **LICENSE PLATE #** EWU1293 **VEHICLE IDENTIFICATION #** 3C4PDCAB8FT577942 **VEHICLE YEAR** 2015 **VEHICLE MAKE** DODGE
 INSURANCE VERIFIED **INSURANCE COMPANY** GEOCO **INSURANCE POLICY #** 6017-79-97-32 **COLOR** SIL **VEHICLE MODEL** JOURNEY
 COMMERCIAL **GOVERNMENT** **IN EMERGENCY RESPONSE** **US DOT #** **TOWED BY:** COMPANY NAME
 INTERLOCK DEVICE EQUIPPED **HIT/SKIP UNIT** **# OCCUPANTS** **VEHICLE WEIGHT GVWR/GCWR**
 1 - ≤ 10K LBS.
 2 - 10,001 - 26K LBS.
 3 - > 26K LBS.
 MATERIAL RELEASED **HAZARDOUS MATERIAL CLASS #** **PLACARD ID #**
 PLACARD

UNIT TYPE 3
 1 - PASSENGER CAR 6 - VAN (9-15 SEATS) 12 - GOLF CART 18 - LIMO (LIVERY VEHICLE) 23 - PEDESTRIAN/SKATER
 2 - PASSENGER VAN (MINIVAN) 7 - MOTORCYCLE 2-WHEELED 13 - SNOWMOBILE 19 - BUS (16+ PASSENGERS) 24 - WHEELCHAIR (ANY TYPE)
 3 - SPORT UTILITY VEHICLE 8 - MOTORCYCLE 3-WHEELED 14 - SINGLE UNIT TRUCK 20 - OTHER VEHICLE 25 - OTHER NON-MOTORIST
 4 - PICK UP 9 - AUTOCYCLE 15 - SEMI-TRACTOR 21 - HEAVY EQUIPMENT 26 - BICYCLE
 5 - CARGO VAN 10 - MOPEL OR MOTORIZED BICYCLE 16 - FARM EQUIPMENT 22 - ANIMAL WITH RIDER OR ANIMAL-DRAWN VEHICLE 27 - TRAIN
 11 - ALL TERRAIN VEHICLE (ATV/UTV) 17 - MOTORHOME 99 - UNKNOWN OR HIT/SKIP

WAS VEHICLE OPERATING IN AUTONOMOUS MODE WHEN CRASH OCCURRED? 2
 0 - NO AUTOMATION 3 - CONDITIONAL AUTOMATION 9 - UNKNOWN
 1 - DRIVER ASSISTANCE 4 - HIGH AUTOMATION
 1 - YES 2 - NO 9 - OTHER / UNKNOWN **AUTONOMOUS MODE LEVEL** 2 - PARTIAL AUTOMATION 5 - FULL AUTOMATION
SPECIAL FUNCTION 1
 1 - NONE 6 - BUS - CHARTER/TOUR 11 - FIRE 16 - FARM 21 - MAIL CARRIER
 2 - TAXI 7 - BUS - INTERCITY 12 - MILITARY 17 - MOWING 99 - OTHER / UNKNOWN
 3 - ELECTRONIC RIDE SHARING 8 - BUS - SHUTTLE 13 - POLICE 18 - SNOW REMOVAL
 4 - SCHOOL TRANSPORT 9 - BUS - OTHER 14 - PUBLIC UTILITY 19 - TOWING
 5 - BUS - TRANSIT/COMMUTER 10 - AMBULANCE 15 - CONSTRUCTION EQUIP. 20 - SAFETY SERVICE PATROL

CARGO BODY TYPE 1
 1 - NO CARGO BODY TYPE / NOT APPLICABLE 4 - LOGGING 7 - GRAIN/CHIPS/GRAVEL 11 - DUMP 99 - OTHER / UNKNOWN
 2 - BUS 5 - INTERMODAL CONTAINER CHASSIS 8 - POLE 12 - CONCRETE MIXER
 3 - VEHICLE TOWING ANOTHER MOTOR VEHICLE 6 - CARGOVAN /ENCLOSED BOX 9 - CARGO TANK 13 - AUTO TRANSPORTER
 10 - FLAT BED 14 - GARBAGE/REFUSE
VEHICLE DEFECTS
 1 - TURN SIGNALS 4 - BRAKES 7 - WORN OR SLICK TIRES 9 - MOTOR TROUBLE 99 - OTHER / UNKNOWN
 2 - HEAD LAMPS 5 - STEERING 8 - TRAILER EQUIPMENT DEFECTIVE 10 - DISABLED FROM PRIOR ACCIDENT
 3 - TAIL LAMPS 6 - TIRE BLOWOUT

NON-MOTORIST LOCATION
 1 - INTERSECTION - MARKED CROSSWALK 4 - MIDBLOCK - MARKED CROSSWALK 7 - SHOULDER/ROADSIDE 10 - DRIVEWAY ACCESS 99 - OTHER / UNKNOWN
 2 - INTERSECTION - UNMARKED CROSSWALK 5 - TRAVEL LANE - OTHER LOCATION 8 - SIDEWALK 11 - SHARED USE PATHS OR TRAILS
 3 - INTERSECTION - OTHER 6 - BICYCLE LANE 9 - MEDIAN/CROSSING ISLAND 12 - FIRST RESPONDER AT INCIDENT SCENE
ACTION 4
 1 - NON-CONTACT 1 - STRAIGHT AHEAD 9 - LEAVING TRAFFIC LANE 15 - WALKING, RUNNING, JOGGING, PLAYING 21 - STANDING OUTSIDE DISABLED VEHICLE
 2 - NON-COLLISION 2 - BACKING 10 - PARKED 16 - WORKING 99 - OTHER / UNKNOWN
 3 - STRIKING 3 - CHANGING LANES 11 - SLOWING OR STOPPED IN TRAFFIC 17 - PUSHING VEHICLE 18 - APPROACHING OR LEAVING VEHICLE
 4 - STRUCK 4 - OVERTAKING/PASSING 12 - DRIVERLESS 13 - NEGOTIATING A CURVE 19 - STANDING
 5 - BOTH STRIKING & STRUCK 5 - MAKING RIGHT TURN 14 - ENTERING OR CROSSING SPECIFIED LOCATION 20 - OTHER NON-MOTORIST
 9 - OTHER / UNKNOWN 7 - MAKING U-TURN 8 - ENTERING TRAFFIC LANE
PRE-CRASH ACTIONS 10
 1 - NONE 8 - FOLLOWING TOO CLOSE /ACDA 13 - IMPROPER START FROM A PARKED POSITION 18 - OPERATING DEFECTIVE EQUIPMENT 23 - OPENING DOOR INTO ROADWAY
 2 - FAILURE TO YIELD 9 - IMPROPER LANE CHANGE 14 - STOPPED OR PARKED ILLEGALLY 19 - LOAD SHIFTING /FALLING/SPILLING 99 - OTHER IMPROPER ACTION
 3 - RAN RED LIGHT 4 - RAN STOP SIGN 10 - IMPROPER PASSING 11 - DROVE OFF ROAD 12 - IMPROPER BACKING
 5 - UNSAFE SPEED 6 - IMPROPER TURN 7 - LEFT OF CENTER

CONTRIBUTING CIRCUMSTANCES 1
SEQUENCE OF EVENTS
 1 99
 1 - OVERTURN/ROLLOVER 7 - SEPARATION OF UNITS 12 - DOWNHILL RUNAWAY 19 - ANIMAL - OTHER 23 - STRUCK BY FALLING, SHIFTING CARGO OR ANYTHING SET IN MOTION BY A MOTOR VEHICLE
 2 - FIRE/EXPLOSION 8 - RAN OFF ROAD RIGHT 13 - OTHER NON-COLLISION 20 - MOTOR VEHICLE IN TRANSPORT 24 - OTHER MOVABLE OBJECT
 3 - IMMERSION 9 - RAN OFF ROAD LEFT 14 - PEDESTRIAN 21 - PARKED MOTOR VEHICLE
 4 - JACKKNIFE 10 - CROSS MEDIAN 15 - PEDALCYCLE 22 - WORK ZONE MAINTENANCE EQUIPMENT
 5 - CARGO / EQUIPMENT LOSS OR SHIFT 11 - CROSS CENTERLINE - OPPOSITE DIRECTION OF TRAVEL 16 - RAILWAY VEHICLE 17 - ANIMAL - FARM 18 - ANIMAL - DEER
 6 - EQUIPMENT FAILURE

COLLISION WITH FIXED OBJECT - STRUCK
 25 - IMPACT ATTENUATOR / CRASH CUSHION 31 - GUARDRAIL END 38 - OVERHEAD SIGN POST 45 - EMBANKMENT 52 - BUILDING
 26 - BRIDGE OVERHEAD STRUCTURE 32 - PORTABLE BARRIER 39 - LIGHT / LUMINARIES SUPPORT 46 - FENCE 53 - TUNNEL
 27 - BRIDGE PIER OR ABUTMENT 33 - MEDIAN CABLE BARRIER 40 - UTILITY POLE 47 - MAILBOX 54 - OTHER FIXED OBJECT
 28 - BRIDGE PARAPET 34 - MEDIAN GUARDRAIL BARRIER 41 - OTHER POST, POLE OR SUPPORT 48 - TREE 99 - OTHER / UNKNOWN
 29 - BRIDGE RAIL 35 - MEDIAN CONCRETE BARRIER 42 - CULVERT 49 - FIRE HYDRANT
 30 - GUARDRAIL FACE 36 - MEDIAN OTHER BARRIER 43 - CURB 50 - WORK ZONE MAINTENANCE EQUIPMENT
 37 - TRAFFIC SIGN POST 44 - DITCH 51 - WALL

FIRST HARMFUL EVENT 1 **MOST HARMFUL EVENT** 1

DAMAGE

DAMAGE SCALE
 1 - NONE 3 - FUNCTIONAL DAMAGE
 2 - MINOR DAMAGE 4 - DISABLING DAMAGE
 9 - UNKNOWN

DAMAGED AREA(S)
 INDICATE ALL THAT APPLY

NO DAMAGE [0] **UNDERCARRIAGE** [14]
 TOP [13] **ALL AREAS** [15]
 UNIT NOT AT SCENE [16]

INITIAL POINT OF CONTACT
 0 - NO DAMAGE 14 - UNDERCARRIAGE
 1-12 - REFER TO UNIT DIAGRAM 15 - VEHICLE NOT AT SCENE
 99 - UNKNOWN
 13 - TOP

TRAFFIC

TRAFFICWAY FLOW 2
 1 - ONE-WAY
 2 - TWO-WAY

TRAFFIC CONTROL 6
 1 - ROUNDABOUT 4 - STOP SIGN
 2 - SIGNAL 5 - YIELD SIGN
 3 - FLASHER 6 - NO CONTROL

OF THROUGH LANES ON ROAD 2 **RAIL GRADE CROSSING** 1
 1 - NOT INVOLVED
 2 - INVOLVED-ACTIVE CROSSING
 3 - INVOLVED-PASSIVE CROSSING

UNIT / NON-MOTORIST DIRECTION
 FROM [] TO []
 1 - NORTH 5 - NORTHEAST
 2 - SOUTH 6 - NORTHWEST
 3 - EAST 7 - SOUTHEAST
 4 - WEST 8 - SOUTHWEST
 9 - OTHER / UNKNOWN

UNIT SPEED [] **DETECTED SPEED**
 1 - STATED / ESTIMATED SPEED
POSTED SPEED [] 2 - CALCULATED / EDR
 3 - UNDETERMINED

MOTORIST / Non-MOTORIST

LOCAL REPORT NUMBER
000230017514

UNIT # 1	NAME: LAST, FIRST, MIDDLE HESS, MICHAEL, A				DATE OF BIRTH 06/30/1951		AGE 71	GENDER F			
ADDRESS: STREET, CITY, STATE, ZIP 3111 STATE ROUTE 132 , AMELIA, OH, 45102					CONTACT PHONE - INCLUDE AREA CODE						
INJURIES 5	INJURED TAKEN BY 1	EMS AGENCY (NAME)	INJURED TAKEN TO: MEDICAL FACILITY (NAME, CITY)		SAFETY EQUIPMENT USED 4	<input type="checkbox"/> DOT-COMPLIANT <input type="checkbox"/> MC HELMET	SEATING POSITION 1	AIR BAG USAGE 1	EJECTION 1	TRAPPED 1	
OL STATE OH	OPERATOR LICENSE NUMBER		OFFENSE CHARGED		LOCAL CODE <input type="checkbox"/>	OFFENSE DESCRIPTION			CITATION NUMBER		
OL CLASS 4	ENDORSEMENT	RESTRICTION SELECT UP TO 3	DRIVER DISTRACTED BY 1	ALCOHOL / DRUG SUSPECTED <input type="checkbox"/> ALCOHOL <input type="checkbox"/> MARIJUANA <input type="checkbox"/> OTHER DRUG		CONDITION 1	ALCOHOL TEST		DRUG TEST(S)		
						STATUS 1	TYPE 1	VALUE .	STATUS 1	TYPE 1	RESULTS SELECT UP TO 4

UNIT #	NAME: LAST, FIRST, MIDDLE				DATE OF BIRTH		AGE	GENDER			
ADDRESS: STREET, CITY, STATE, ZIP					CONTACT PHONE - INCLUDE AREA CODE						
INJURIES	INJURED TAKEN BY	EMS AGENCY (NAME)	INJURED TAKEN TO: MEDICAL FACILITY (NAME, CITY)		SAFETY EQUIPMENT USED	<input type="checkbox"/> DOT-COMPLIANT <input type="checkbox"/> MC HELMET	SEATING POSITION	AIR BAG USAGE	EJECTION	TRAPPED	
OL STATE	OPERATOR LICENSE NUMBER		OFFENSE CHARGED		LOCAL CODE <input type="checkbox"/>	OFFENSE DESCRIPTION			CITATION NUMBER		
OL CLASS	ENDORSEMENT	RESTRICTION SELECT UP TO 3	DRIVER DISTRACTED BY	ALCOHOL / DRUG SUSPECTED <input type="checkbox"/> ALCOHOL <input type="checkbox"/> MARIJUANA <input type="checkbox"/> OTHER DRUG		CONDITION	ALCOHOL TEST		DRUG TEST(S)		
						STATUS	TYPE	VALUE	STATUS	TYPE	RESULTS SELECT UP TO 4

UNIT #	NAME: LAST, FIRST, MIDDLE				DATE OF BIRTH		AGE	GENDER			
ADDRESS: STREET, CITY, STATE, ZIP					CONTACT PHONE - INCLUDE AREA CODE						
INJURIES	INJURED TAKEN BY	EMS AGENCY (NAME)	INJURED TAKEN TO: MEDICAL FACILITY (NAME, CITY)		SAFETY EQUIPMENT USED	<input type="checkbox"/> DOT-COMPLIANT <input type="checkbox"/> MC HELMET	SEATING POSITION	AIR BAG USAGE	EJECTION	TRAPPED	
OL STATE	OPERATOR LICENSE NUMBER		OFFENSE CHARGED		LOCAL CODE <input type="checkbox"/>	OFFENSE DESCRIPTION			CITATION NUMBER		
OL CLASS	ENDORSEMENT	RESTRICTION SELECT UP TO 3	DRIVER DISTRACTED BY	ALCOHOL / DRUG SUSPECTED <input type="checkbox"/> ALCOHOL <input type="checkbox"/> MARIJUANA <input type="checkbox"/> OTHER DRUG		CONDITION	ALCOHOL TEST		DRUG TEST(S)		
						STATUS	TYPE	VALUE	STATUS	TYPE	RESULTS SELECT UP TO 4

INJURIES	SEATING POSITION	AIR BAG	OL CLASS	OL RESTRICTION(S)	DRIVER DISTRACTION	TEST STATUS
1 - FATAL 2 - SUSPECTED SERIOUS INJURY 3 - SUSPECTED MINOR INJURY 4 - POSSIBLE INJURY 5 - NO APPARENT INJURY	1 - FRONT - LEFT SIDE (MOTORCYCLE DRIVER) 2 - FRONT - MIDDLE 3 - FRONT - RIGHT SIDE 4 - SECOND - LEFT SIDE (MOTORCYCLE PASSENGER) 5 - SECOND - MIDDLE 6 - SECOND - RIGHT SIDE 7 - THIRD - LEFT SIDE (MOTORCYCLE SIDE CAR) 8 - THIRD - MIDDLE 9 - THIRD - RIGHT SIDE 10 - SLEEPER SECTION OF TRUCK CAB 11 - PASSENGER IN OTHER ENCLOSED CARGO AREA (NON-TRAILING UNIT, BUS, PICK-UP WITH CAP) 12 - PASSENGER IN UNENCLOSED CARGO AREA 13 - TRAILING UNIT 14 - RIDING ON VEHICLE EXTERIOR (NON-TRAILING UNIT) 15 - NON-MOTORIST 99 - OTHER / UNKNOWN	1 - NOT DEPLOYED 2 - DEPLOYED FRONT 3 - DEPLOYED SIDE 4 - DEPLOYED BOTH FRONT/SIDE 5 - NOT APPLICABLE 9 - DEPLOYMENT UNKNOWN	1 - CLASS A 2 - CLASS B 3 - CLASS C 4 - REGULAR CLASS (OHIO = D) 5 - M/C MOPED ONLY 6 - NO VALID OL	1 - ALCOHOL INTERLOCK DEVICE 2 - CDL INTRASTATE ONLY 3 - CORRECTIVE LENSES 4 - FARM WAIVER 5 - EXCEPT CLASS A BUS 6 - EXCEPT CLASS A & CLASS B BUS 7 - EXCEPT TRACTOR-TRAILER 8 - INTERMEDIATE LICENSE RESTRICTIONS 9 - LEARNER'S PERMIT RESTRICTIONS 10 - LIMITED TO DAYLIGHT ONLY 11 - LIMITED TO EMPLOYMENT 12 - LIMITED - OTHER 13 - MECHANICAL DEVICES (SPECIAL BRAKES, HAND CONTROLS, OR OTHER ADAPTIVE DEVICES) 14 - MILITARY VEHICLES ONLY 15 - MOTOR VEHICLES WITHOUT AIR BRAKES 16 - OUTSIDE MIRROR 17 - PROSTHETIC AID 18 - OTHER	1 - NOT DISTRACTED 2 - MANUALLY OPERATING AN ELECTRONIC COMMUNICATION DEVICE (TEXTING, TYPING, DIALING) 3 - TALKING ON HANDS-FREE COMMUNICATION DEVICE 4 - TALKING ON HAND-HELD COMMUNICATION DEVICE 5 - OTHER ACTIVITY WITH AN ELECTRONIC DEVICE 6 - PASSENGER 7 - OTHER DISTRACTION INSIDE THE VEHICLE 8 - OTHER DISTRACTION OUTSIDE THE VEHICLE 9 - OTHER / UNKNOWN	1 - NONE GIVEN 2 - TEST REFUSED 3 - TEST GIVEN, CONTAMINATED SAMPLE / UNUSABLE 4 - TEST GIVEN, RESULTS KNOWN 5 - TEST GIVEN, RESULTS UNKNOWN
INJURIES TAKEN BY		EJECTION	OL ENDORSEMENT		CONDITION	ALCOHOL TEST TYPE
1 - NOT TRANSPORTED /TREATED AT SCENE 2 - EMS 3 - POLICE 9 - OTHER / UNKNOWN		1 - NOT EJECTED 2 - PARTIALLY EJECTED 3 - TOTALLY EJECTED 4 - NOT APPLICABLE	H - HAZMAT M - MOTORCYCLE P - PASSENGER N - TANKER Q - MOTOR SCOOTER R - THREE-WHEEL MOTORCYCLE S - SCHOOL BUS T - DOUBLE & TRIPLE TRAILERS X - TANKER / HAZMAT		1 - APPARENTLY NORMAL 2 - PHYSICAL IMPAIRMENT 3 - EMOTIONAL (E.G., DEPRESSED, ANGRY, DISTURBED) 4 - ILLNESS 5 - FELL ASLEEP, FAINTED, FATIGUED, ETC. 6 - UNDER THE INFLUENCE OF MEDICATIONS / DRUGS / ALCOHOL 9 - OTHER / UNKNOWN	1 - NONE 2 - BLOOD 3 - URINE 4 - BREATH 5 - OTHER
SAFETY EQUIPMENT		TRAPPED	GENDER			DRUG TEST TYPE
1 - NONE USED 2 - SHOULDER BELT ONLY USED 3 - LAP BELT ONLY USED 4 - SHOULDER & LAP BELT USED 5 - CHILD RESTRAINT SYSTEM - FORWARD FACING 6 - CHILD RESTRAINT SYSTEM - REAR FACING 7 - BOOSTER SEAT 8 - HELMET USED 9 - PROTECTIVE PADS USED (ELBOWS, KNEES, ETC) 10 - REFLECTIVE CLOTHING 11 - LIGHTING - PEDESTRIAN / BICYCLE ONLY 99 - OTHER / UNKNOWN		1 - NOT TRAPPED 2 - EXTRICATED BY MECHANICAL MEANS 3 - FREED BY NON-MECHANICAL MEANS	F - FEMALE M - MALE U - OTHER / UNKNOWN			DRUG TEST RESULT(S)
						1 - AMPHETAMINES 2 - BARBITURATES 3 - BENZODIAZEPINES 4 - CANNABINOIDS 5 - COCAINE 6 - OPIATES / OPIOIDS 7 - OTHER 8 - NEGATIVE RESULTS

OCCUPANT / WITNESS ADDENDUM

LOCAL REPORT NUMBER
000230017514

OCCUPANT	UNIT #	NAME: LAST, FIRST, MIDDLE			DATE OF BIRTH		AGE	GENDER	
	ADDRESS: STREET, CITY, STATE, ZIP				CONTACT PHONE - INCLUDE AREA CODE				
INJURIES	INJURED TAKEN BY	EMS AGENCY (NAME)	INJURED TAKEN TO: MEDICAL FACILITY (NAME, CITY)	SAFETY EQUIPMENT	<input type="checkbox"/> DOT-COMPLIANT MC HELMET	SEATING POSITION	AIR BAG USAGE	EJECTION	TRAPPED
UNIT #	NAME: LAST, FIRST, MIDDLE			DATE OF BIRTH		AGE	GENDER		
ADDRESS: STREET, CITY, STATE, ZIP				CONTACT PHONE - INCLUDE AREA CODE					
INJURIES	INJURED TAKEN BY	EMS AGENCY (NAME)	INJURED TAKEN TO: MEDICAL FACILITY (NAME, CITY)	SAFETY EQUIPMENT	<input type="checkbox"/> DOT-COMPLIANT MC HELMET	SEATING POSITION	AIR BAG USAGE	EJECTION	TRAPPED
UNIT #	NAME: LAST, FIRST, MIDDLE			DATE OF BIRTH		AGE	GENDER		
ADDRESS: STREET, CITY, STATE, ZIP				CONTACT PHONE - INCLUDE AREA CODE					
INJURIES	INJURED TAKEN BY	EMS AGENCY (NAME)	INJURED TAKEN TO: MEDICAL FACILITY (NAME, CITY)	SAFETY EQUIPMENT	<input type="checkbox"/> DOT-COMPLIANT MC HELMET	SEATING POSITION	AIR BAG USAGE	EJECTION	TRAPPED
UNIT #	NAME: LAST, FIRST, MIDDLE			DATE OF BIRTH		AGE	GENDER		
ADDRESS: STREET, CITY, STATE, ZIP				CONTACT PHONE - INCLUDE AREA CODE					
INJURIES	INJURED TAKEN BY	EMS AGENCY (NAME)	INJURED TAKEN TO: MEDICAL FACILITY (NAME, CITY)	SAFETY EQUIPMENT	<input type="checkbox"/> DOT-COMPLIANT MC HELMET	SEATING POSITION	AIR BAG USAGE	EJECTION	TRAPPED

INJURIES	SAFETY EQUIPMENT USED	SEATING POSITION	AIR BAG USAGE
1 - FATAL 2 - SUSPECTED SERIOUS INJURY 3 - SUSPECTED MINOR INJURY 4 - POSSIBLE INJURY 5 - NO APPARENT INJURY	1 - NONE USED - VEHICLE OCCUPANT 2 - SHOULDER BELT ONLY USED 3 - LAP BELT ONLY USED 4 - SHOULDER & LAP BELT USED 5 - CHILD RESTRAINT SYSTEM - FORWARD FACING 6 - CHILD RESTRAINT SYSTEM - REAR FACING 7 - BOOSTER SEAT 8 - HELMET USED 9 - PROTECTIVE PADS USED (ELBOWS, KNEES, ETC) 10 - REFLECTIVE CLOTHING 11 - LIGHTING - PEDESTRIAN / BICYCLE ONLY 99 - OTHER / UNKNOWN	1 - FRONT - LEFT SIDE (MOTORCYCLE DRIVER) 2 - FRONT - MIDDLE 3 - FRONT - RIGHT SIDE 4 - SECOND - LEFT SIDE (MOTORCYCLE PASSENGER) 5 - SECOND - MIDDLE 6 - SECOND - RIGHT SIDE 7 - THIRD - LEFT SIDE (MOTORCYCLE SIDE CAR) 8 - THIRD - MIDDLE 9 - THIRD - RIGHT SIDE 10 - SLEEPER SECTION OF TRUCK CAB 11 - PASSENGER IN OTHER ENCLOSED CARGO AREA (NON-TRAILING UNIT SUCH AS A BUS, PICK-UP WITH CAP) 12 - PASSENGER IN UNENCLOSED CARGO AREA 13 - TRAILING UNIT 14 - RIDING ON VEHICLE EXTERIOR (NON-TRAILING UNIT) 15 - NON-MOTORIST 99 - OTHER / UNKNOWN	1 - NOT DEPLOYED 2 - DEPLOYED FRONT 3 - DEPLOYED SIDE 4 - DEPLOYED BOTH FRONT/SIDE 5 - NOT APPLICABLE 9 - DEPLOYMENT UNKNOWN
INJURED TAKEN BY			EJECTION
1 - NOT TRANSPORTED / TREATED AT SCENE 2 - EMS 3 - POLICE 9 - OTHER / UNKNOWN			1 - NOT EJECTED 2 - PARTIALLY EJECTED 3 - TOTALLY EJECTED 4 - NOT APPLICABLE
GENDER			TRAPPED
F - FEMALE M - MALE U - OTHER / UNKNOWN			1 - NOT TRAPPED 2 - EXTRICATED BY MECHANICAL MEANS 3 - FREED BY NON-MECHANICAL MEANS

WITNESS	NAME: LAST, FIRST, MIDDLE	DATE OF BIRTH		AGE	GENDER
	ADDRESS: STREET, CITY, STATE, ZIP	CONTACT PHONE - INCLUDE AREA CODE			
WITNESS	NAME: LAST, FIRST, MIDDLE	DATE OF BIRTH		AGE	GENDER
	ADDRESS: STREET, CITY, STATE, ZIP	CONTACT PHONE - INCLUDE AREA CODE			
WITNESS	NAME: LAST, FIRST, MIDDLE	DATE OF BIRTH		AGE	GENDER
	ADDRESS: STREET, CITY, STATE, ZIP	CONTACT PHONE - INCLUDE AREA CODE			

OHIO TRAFFIC ACCIDENT - OH2 DIAGRAM

LOCAL REPORT NUMBER 000230017514	REPORTING AGENCY Clermont County Sheriff	Date Of Crash 06/06/2023
IN COUNTY OF Clermont County	ACCIDENT LOCATION Hospital	

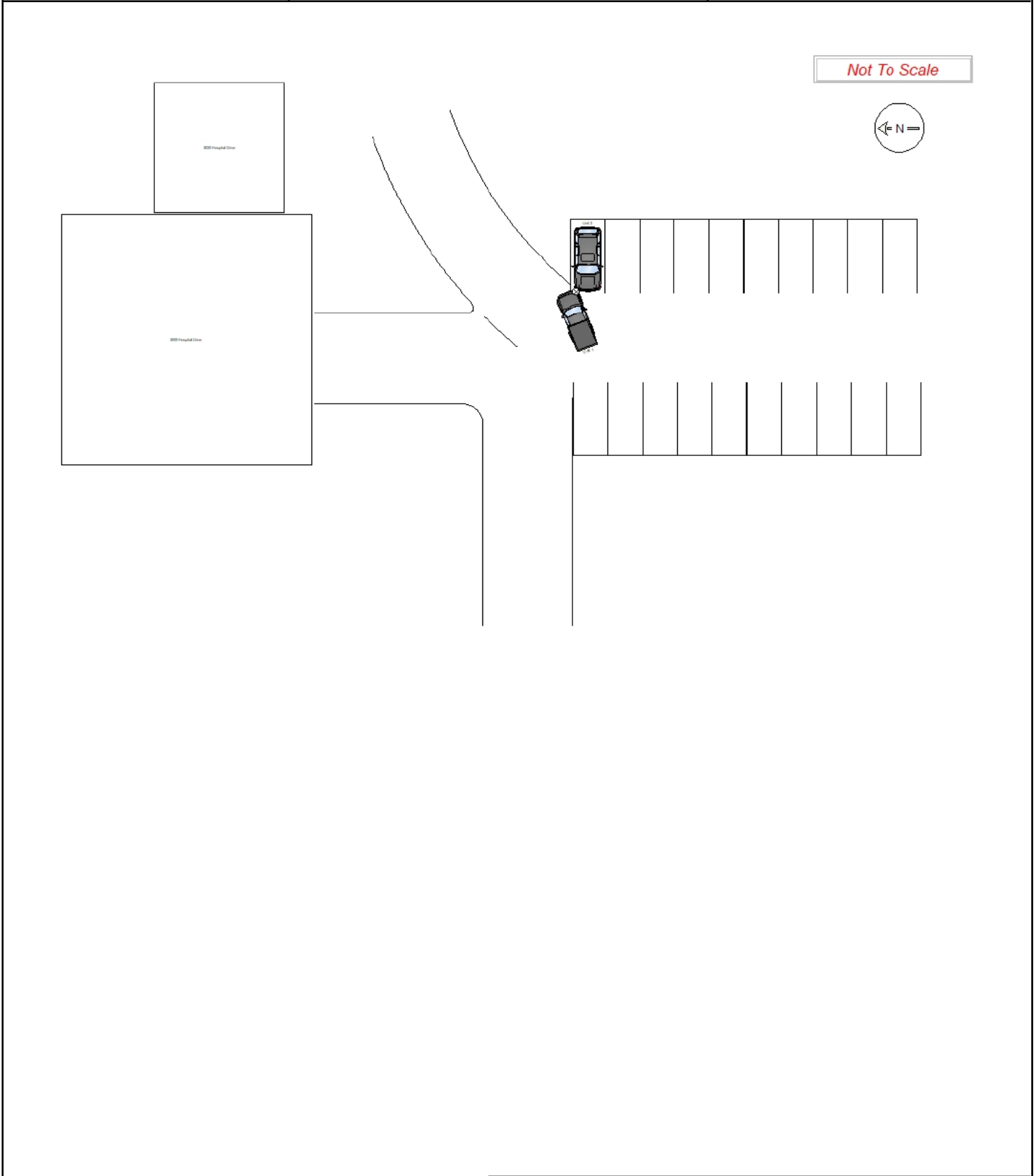

OFFICERS SIGNATURE	BADGE NO. R12834
--------------------	----------------------------